





CL.1 Wall valve clockwise closing cold 1/2" - Brushed Champagne (22kt Gold)

CL.1

36 607 706

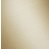

- rosette 60 x 60 mm
- with cold marking
- head part with cut-to-length spindle and sleeve
- WRAS 2010066

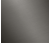
	Brushed Champagne (22kt Gold)	36 607 706-46
	Chrome	36 607 706-00
	Brushed Platinum	36 607 706-06
	Dark Chrome	36 607 706-19
	Champagne (22kt Gold)	36 607 706-47
	Brushed Dark Platinum	36 607 706-99

Required miscellaneous

	Wall valve 1/2" - ● max. recess depth 150 mm ● min. recess depth 105 mm	35 607 970-90 0010
---	--	-----------------------



CL.1 Wall valve clockwise closing cold 1/2" - Brushed Champagne (22kt Gold)

CL.1

36 607 706

mm [inches]

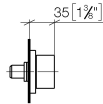
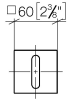

Codes & Standards

ADA	ASME A112.18.1/CSA B125.1	DIN 4109	ISO 3822
Scottish Water Byelaws	UK Water Supply Regulations	Ü-Zeichen	

Certificates

WRAS_2010 LGA_29

36 607 706

Product version from 10/14/2020

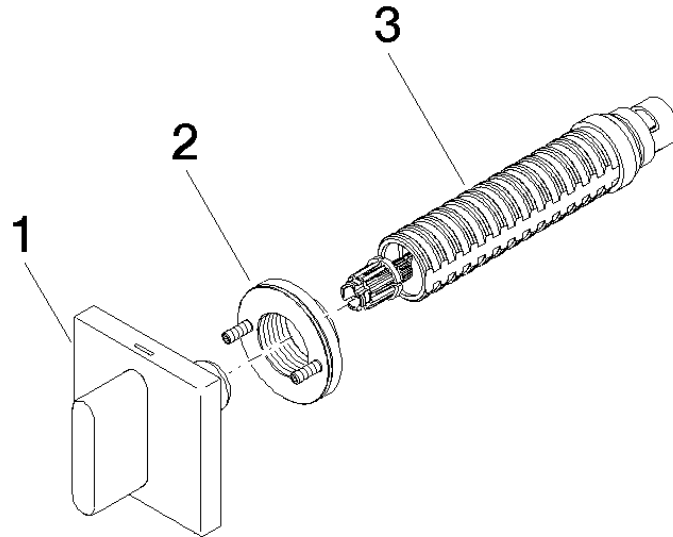



CL.1 Wall valve clockwise closing cold 1/2" - Brushed Champagne (22kt Gold)

CL.1

36 607 706

Spare parts list

Product version from 10/14/2020

No.	Item Number	Name	Quantity used	Delivery time
	90 20 70 051 02-46	handle (cold)	3	30