





**CL.1 Wall valve clockwise closing cold 1/2" - Brushed Platinum**

CL.1

36 627 706

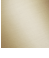

- with CASCADE structure
- rosette 60 x 60 mm
- with cold marking
- head part with cut-to-length spindle and sleeve
- WRAS 2010066

	Brushed Platinum	36 627 706-06
	Chrome	36 627 706-00
	Dark Chrome	36 627 706-19
	Brushed Champagne (22kt Gold)	36 627 706-46
	Champagne (22kt Gold)	36 627 706-47
	Brushed Dark Platinum	36 627 706-99

**Required miscellaneous**



- |                            |               |
|----------------------------|---------------|
| <b>Wall valve 1/2" -</b>   | 35 607 970-90 |
| ● max. recess depth 150 mm | 0010          |
| ● min. recess depth 105 mm |               |



# CL.1 Wall valve clockwise closing cold 1/2" - Brushed Platinum

CL.1

36 627 706

mm [inches]

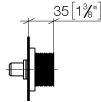

## Codes & Standards

ADA	ASME A112.18.1	ASME A112.18.1/CSA B125.1	cUPC
DIN 4109	EN 200	ISO 3822	Scottish Water Byelaws
UK Water Supply Regulations	Ü-Zeichen		

## Certificates

IAPMO_4976	DVGW_DW- 6501DN0	WRAS_2010	LGA_29	LGA_29
------------	---------------------	-----------	--------	--------

36 627 706

Product version up to 10/14/2020

**Product version from 10/14/2020**

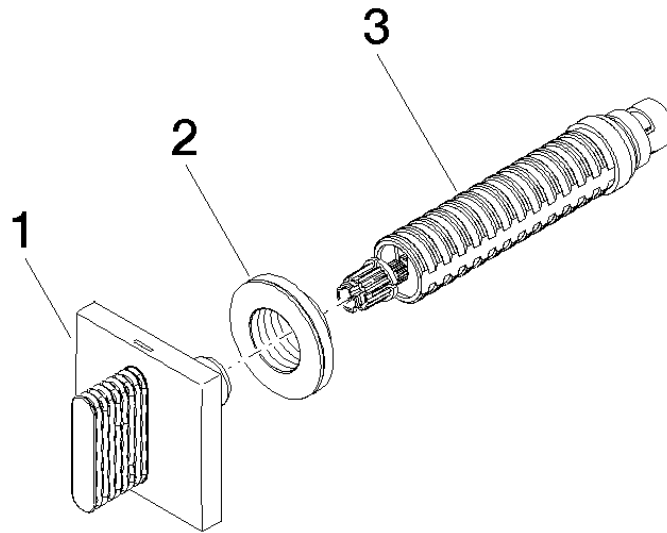



## CL.1 Wall valve clockwise closing cold 1/2" - Brushed Platinum

CL.1

36 627 706

### Spare parts list

Product version up to 10/14/2020

### Product version from 10/14/2020

No.	Item Number	Name	Quantity used	Delivery time
	90 20 70 053 02-06	handle ( cold )	3	10