







Bec cascade baignoire pour montage mural - Platine brossé

MEM

13 430 740



- saillie 200 mm
- jet cascade
- plaque 180 mm x 60 mm
- diamètre de perçement 40 mm
- raccord 1/2"
- montage de la fiche
- débit d'eau maxi. 26,5 l/min avec une pression d'écoulement de 3 bars

	Platine brossé	13 430 740-06
	Chrome	13 430 740-00
	Platine	13 430 740-08
	Dark Chrome	13 430 740-19
	Laiton brossé (Or 23cts)	13 430 740-28
	Noir mat	13 430 740-33
	Champagne brossé (Or 22cts)	13 430 740-46
	Champagne (Or 22cts)	13 430 740-47
	Dark Platinum brossé	13 430 740-99

Accessoires requis

Adaptateur à encastrer -

35 080 970-90
0010



13 430 740

mm [inches]



Diagramme de débit



Diagramme de portée du jet

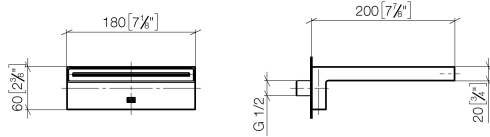

Codes & Standards

ASME A112.18.1	ASME A112.18.1/CSA B125.1	cUPC	DIN 4109
ISO 3822	Scottish Water Byelaws	UK Water Supply Regulations	Ü-Zeichen

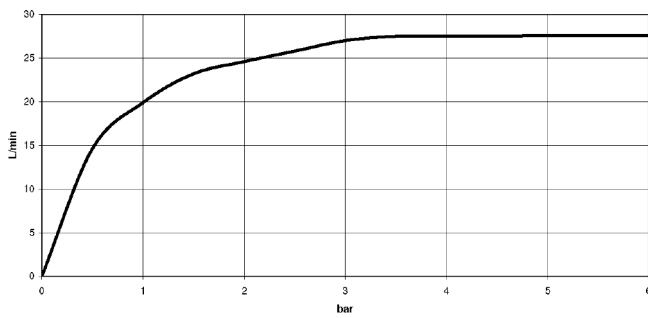
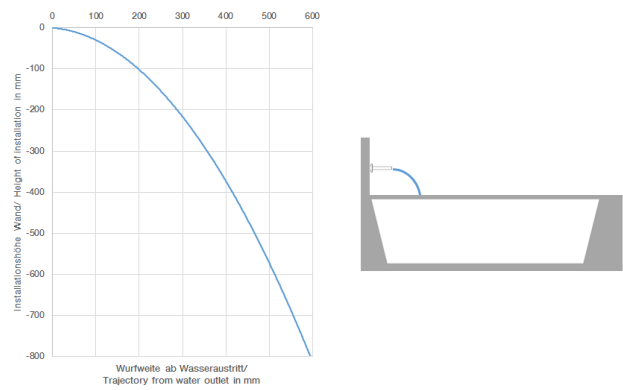

Bec cascade baignoire pour montage mural - Platine brossé

MEM

13 430 740

Certificats

LGA_19

IAPMO_4976

WRAS_240502

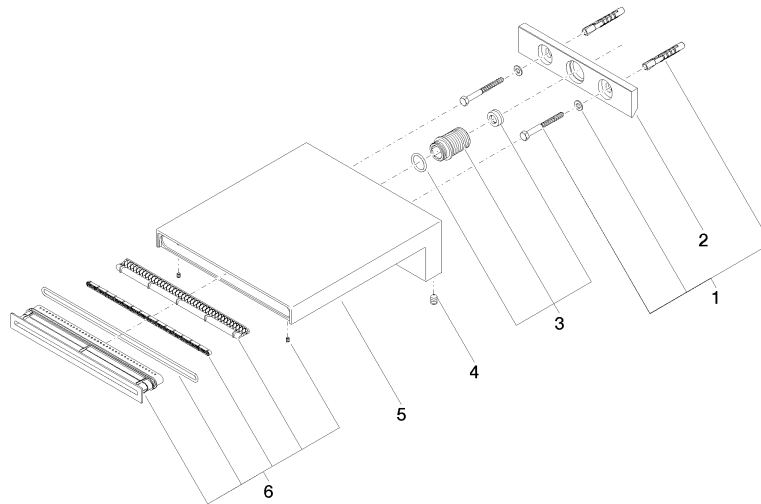



Bec cascade baignoire pour montage mural - Platine brossé

MEM

13 430 740

Liste des pièces de rechange

N°	Article Numéro	Désignation	Fréquence de montage	Délai de livraison
	04 30 31 014 00 90	set de fixation	7	2