













36 514 979 Produktversion ab 01.04.2024

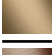

- AQUAPRESSURE FLOW, Durchfluss max. 10 l/min (bei 3 Bar)
- Strahl verstellbar
- Funktion ab: l/min

Technische Daten:

- Abdeckplatte 120 x 60 mm
- Anschluss 1/2"

	Chrom gebürstet	36 514 979-93
	Chrom	36 514 979-00
	Platin gebürstet	36 514 979-06
	Platin	36 514 979-08
	Dark Chrome	36 514 979-19
	Light Gold	36 514 979-26
	Light Gold gebürstet	36 514 979-27
	Messing gebürstet (23kt Gold)	36 514 979-28
	Schwarz matt	36 514 979-33
	Dark Brass gebürstet	36 514 979-39
	Bronze gebürstet	36 514 979-42
	Champagne gebürstet (22kt Gold)	36 514 979-46
	Champagne (22kt Gold)	36 514 979-47
	Dark Platinum gebürstet	36 514 979-99

36 514 979 Produktversion ab 01.04.2024

mm [inches]

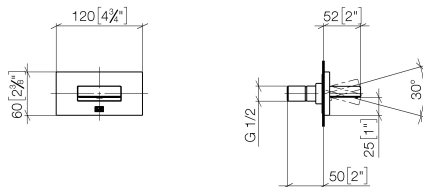

Durchflussdiagramm

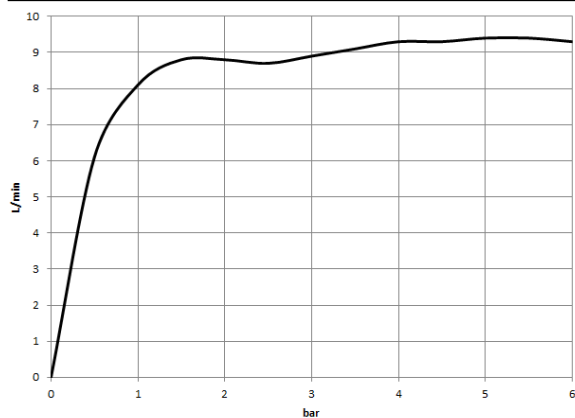

Wurfweitendiagramm

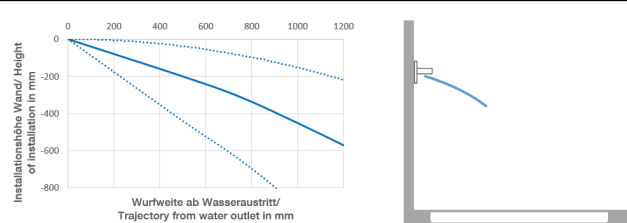

Codes & Standards

DIN 4109

ISO 3822

Scottish Water
Byelaws

UK Water Supply
Regulations

Ü-Zeichen



WATER CURVE UP-Seitenbrause - Chrom gebürstet

SERIENNEUTRAL

36 514 979 Produktversion ab 01.04.2024

Zertifikate und Nachhaltigkeit

LGA_29

WRAS_250602

36 514 979 Produktversion ab 01.04.2024

Ersatzteile für die
anderen
Oberflächenvarianten
finden Sie hier:
Chrom

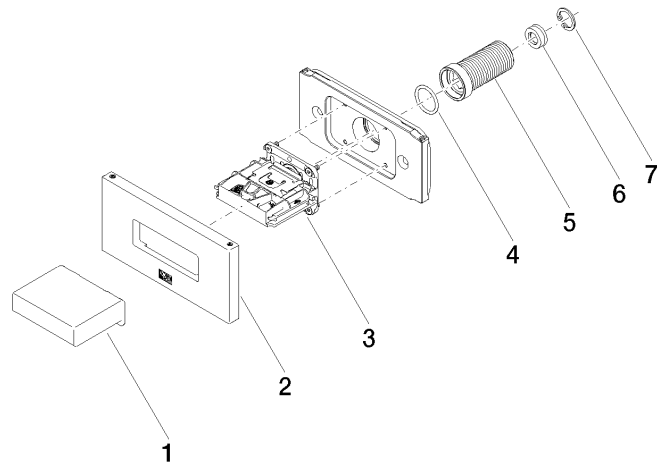

Ersatzteilstückliste

Nr.	Artikelnummer	Benennung	Verbaumenge	Lieferzeit
1	09 17 01 230-93	Gehäuse	1,00	20
6	09 23 01 134 90	Durchflussbegrenzer	1,00	2
5	09 24 04 336 90	Nippel	1,00	2
2	90 27 97 041 00-93	Rosette	1,00	20
7	09 16 01 014 90	Ring	1,00	2
3	90 29 03 088 00 90	Einsatz	1,00	2
4	90 14 10 010 00 90	Dichtung	1,00	2