















10 125 970



Passt zu: IMO, LULU, MADISON, MEM,  
TARA, CL.1, LISSÉ, VAIA, META, CYO

	Platin gebürstet	10 125 970-06
	Chrom	10 125 970-00
	Platin	10 125 970-08
	Messing (23kt Gold)	10 125 970-09
	Dark Chrome	10 125 970-19
	Light Gold	10 125 970-26
	Light Gold gebürstet	10 125 970-27
	Messing gebürstet (23kt Gold)	10 125 970-28
	Schwarz matt	10 125 970-33
	Platin / Platin gebürstet	10 125 970-36
	Messing / Messing gebürstet (23kt Gold)	10 125 970-38
	Bronze gebürstet	10 125 970-42
	Champagne gebürstet (22kt Gold)	10 125 970-46
	Champagne (22kt Gold)	10 125 970-47
	Chrom gebürstet	10 125 970-93
	Dark Platinum gebürstet	10 125 970-99



## Ablaufgarnitur mit Druckverschluss 1 1/4" - Platin gebürstet

---

IMO

10 125 970

Nur für Becken mit Überlauf geeignet.

10 125 970

mm [inches]

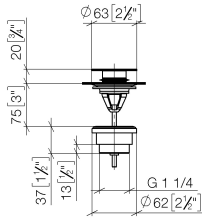

10 125 970

**Produktversion ab 10/1/2023**

Ersatzteile für die  
anderen  
Oberflächenvarianten  
finden Sie hier:  
Chrom

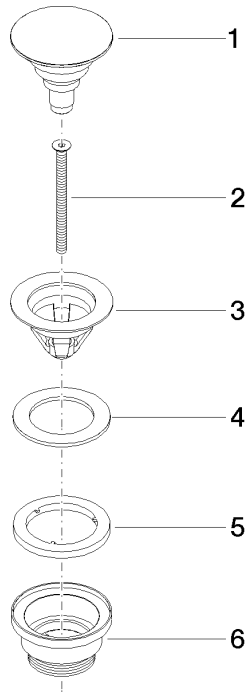



# Ablaufgarnitur mit Druckverschluss 1 1/4" - Platin gebürstet

IMO

10 125 970

## Ersatzteilstückliste

### Produktversion ab 10/1/2023

Nr.	Artikelnummer	Benennung	Verbaumenge	Lieferzeit
	04 31 20 096 00-06	Stopfen	6	10