

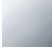



28 450 410

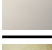

- Brauseabgang 1/2"
- Rosette Ø 55 mm
- Anschluss 1/2"

Eigensicher gegen Rückfließen.

|   |                               |               |
|---|-------------------------------|---------------|
|  | Messing (23kt Gold)           | 28 450 410-09 |
|  | Chrom                         | 28 450 410-00 |
|  | Platin gebürstet              | 28 450 410-06 |
|  | Platin                        | 28 450 410-08 |
|  | Messing gebürstet (23kt Gold) | 28 450 410-28 |
|  | Dark Platinum gebürstet       | 28 450 410-99 |

**Empfohlenes Zubehör**

**UP-Wandwinkel -** 35 085 970 90



- Max. Einbautiefe 163 mm
- Min. Einbautiefe 90 mm

28 450 410

mm [inches]

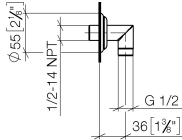

### Durchflussdiagramm



### Zertifikate

Belgaqua\_21-381- WRAS\_240502026.  
27\_7.

28 450 410

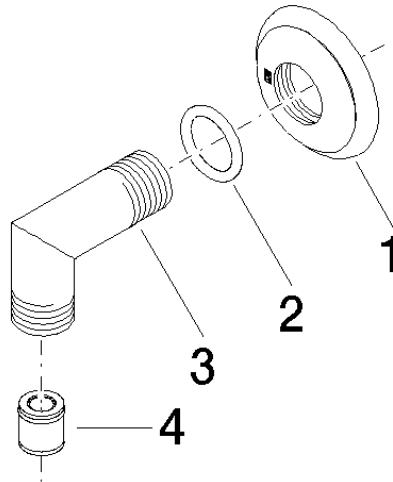

### Ersatzteilstückliste

| Nr. | Artikelnummer      | Benennung             | Verbaumenge | Lieferzeit |
|-----|--------------------|-----------------------|-------------|------------|
| 1   | 09 27 35 003-09    | Rosette               | 1           | 40         |
| 2   | 90 14 10 026 00 90 | Dichtung              | 1           | 2          |
| 3   | 09 11 03 121-09    | Anschluss             | 1           | 60         |
| 4   | 90 23 01 141 00 90 | Rueckflussverhinderer | 1           | 2          |