











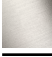

- Brausekopf Ø 100 mm
- PURIFY RAIN, Durchfluss max. 7 l/min (bei 3 Bar)
- Funktion ab: 6 l/min
- mit Antikalk-System

Technische Maße:

- Ausladung 180-210 mm
- Kugelgelenk 30° schwenkbar
- Rosette 60 x 60 mm
- Anschluss 1/2"

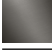
	Light Gold gebürstet	28 504 670-27
	Chrom	28 504 670-00
	Platin gebürstet	28 504 670-06
	Platin	28 504 670-08
	Dark Chrome	28 504 670-19
	Messing gebürstet (23kt Gold)	28 504 670-28
	Schwarz matt	28 504 670-33
	Champagne gebürstet (22kt Gold)	28 504 670-46
	Champagne (22kt Gold)	28 504 670-47
	Chrom gebürstet	28 504 670-93
	Dark Platinum gebürstet	28 504 670-99

Empfohlenes Zubehör

UP-Wandwinkel -

35 085 970 90



- Min. Einbautiefe 90 mm
- Max. Einbautiefe 163 mm

mm [inches]

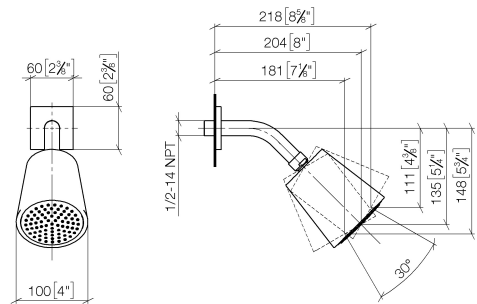

### Durchflussdiagramm

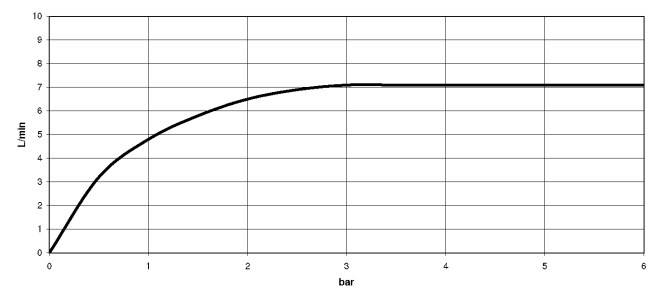

### Codes & Standards

DIN 4109	ISO 3822	Ü-Zeichen
----------	----------	-----------



## Kopfbrause - Light Gold gebürstet

SERIENSPEZIFISC

28 504 670 Produktversion ab 30.06.2015

### Zertifikate und Nachhaltigkeit

LGA\_19

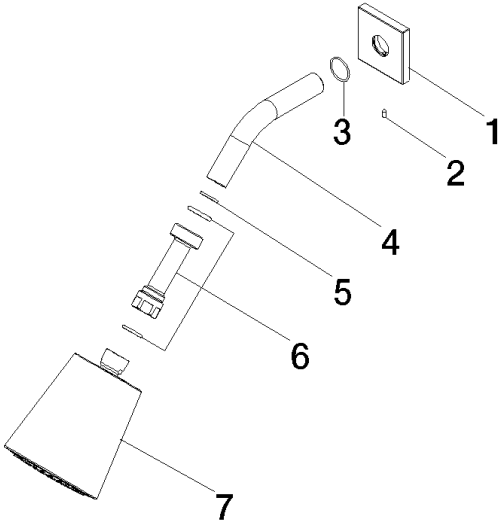

Ersatzteilstückliste

Nr.	Artikelnummer	Benennung	Verbaumenge	Lieferzeit
4	09 11 03 011-27	Anschluss	1,00	60
5	90 14 20 002 00 90	Dichtung	1,00	2
2	09 31 11 048 90	Stift	1,00	2
1	09 27 98 003-27	Rosette	1,00	60
3	90 14 10 026 00 90	Dichtung	1,00	2
6	90 24 05 017 00 90	Nippel	1,00	2
7	90 12 05 054 01-27	Brause	1,00	30