

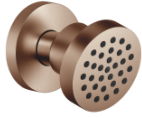

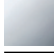







28 518 979

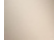

- Brausekopf Ø 55 mm
- Kugelgelenk 25° schwenkbar (in jede Richtung)
- HORIZONTAL RAIN, Durchfluss max. 5 l/min (bei 3 Bar)
- mit Antikalk-System
- Rosette Ø 55 mm
- Anschluss 1/2"
- Dieses Produkt leistet einen Beitrag zur Erfüllung der Vorgaben von nachhaltigen Gebäudezertifizierungen, z.B. LEED®, BREEAM®, DGNB

Passt zu: TARA, LISSÉ, VAIA, META

	Bronze gebürstet	28 518 979-42
	Chrom	28 518 979-00
	Platin gebürstet	28 518 979-06
	Platin	28 518 979-08
	Messing (23kt Gold)	28 518 979-09
	Dark Chrome	28 518 979-19
	Light Gold	28 518 979-26
	Light Gold gebürstet	28 518 979-27
	Messing gebürstet (23kt Gold)	28 518 979-28
	Schwarz matt	28 518 979-33
	Champagne gebürstet (22kt Gold)	28 518 979-46
	Champagne (22kt Gold)	28 518 979-47
	Chrom gebürstet	28 518 979-93
	Dark Platinum gebürstet	28 518 979-99

28 518 979

mm [inches]



Durchflussdiagramm



Wurfweitendiagramm

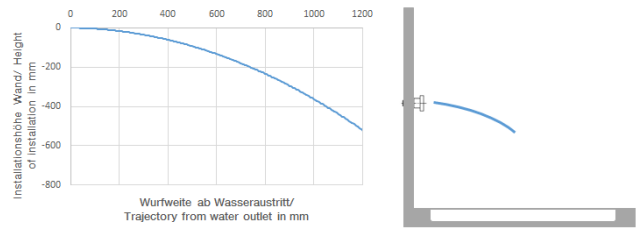

Zertifikate

LGA_38651.

28 518 979

Ersatzteile für die
anderen
Oberflächenvarianten
finden Sie hier:
Chrom

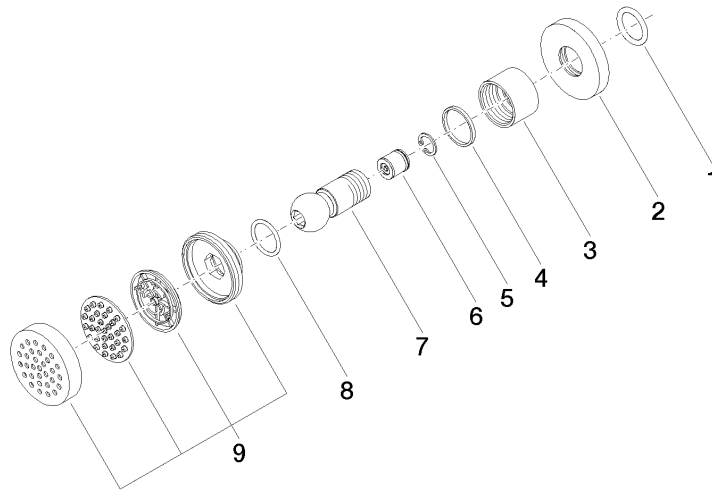

Ersatzteilstückliste

Nr.	Artikelnummer	Benennung	Verbaumenge	Lieferzeit
1	90 14 10 026 00 90	Dichtung	1	2
2	09 27 22 019-42	Rosette	1	60
3	09 23 30 026-42	Mutter	1	60
4	09 14 15 010 90	Ring	1	2
5	09 16 01 014 90	Ring	1	2
6	09 23 01 048 90	Rueckflussverhinderer	1	2
7	09 21 40 016-42	Anschluss	1	60
8	09 14 10 015 90	Dichtung	1	2
9	90 12 05 027 00-42	Gehaeuse (komplett)	1	30