











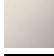

28 678 970

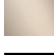

Passt zu: TARA, LISSÉ, VAIA, META

- Ausladung 450 mm
- Regenbrause Ø 300 mm
- PURE RAIN, Durchfluss max. 9 l/min (bei 3 Bar)
- Funktion ab: 7 l/min
- Rosette Ø 60 mm
- Anschluss 1/2"
- mit Antikalk-System
- mit Leerlauf-Funktion
- Dieses Produkt leistet einen Beitrag zur Erfüllung der Vorgaben von nachhaltigen Gebäudezertifizierungen, z.B. LEED®, BREEAM®, DGNB

	Bronze gebürstet	28 678 970-42
	Chrom	28 678 970-00
	Platin gebürstet	28 678 970-06
	Platin	28 678 970-08
	Dark Chrome	28 678 970-19
	Light Gold	28 678 970-26
	Light Gold gebürstet	28 678 970-27
	Messing gebürstet (23kt Gold)	28 678 970-28
	Schwarz matt	28 678 970-33
	Champagne gebürstet (22kt Gold)	28 678 970-46
	Champagne (22kt Gold)	28 678 970-47
	Chrom gebürstet	28 678 970-93
	Dark Platinum gebürstet	28 678 970-99

28 678 970

mm [inches]

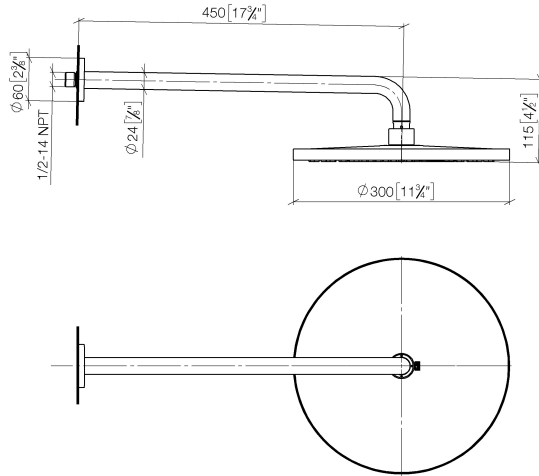

Durchflussdiagramm



Zertifikate

LGA_29235.

28 678 970

Ersatzteile für die
anderen
Oberflächenvarianten
finden Sie hier:
Chrom

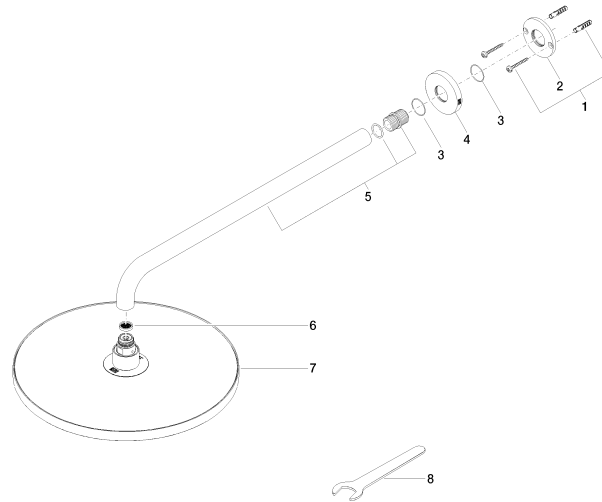

Ersatzteilstückliste

Nr.	Artikelnummer	Benennung	Verbaumenge	Lieferzeit
1	04 30 31 032 00 90	Befestigungssatz	1	2
2	09 17 20 120 90	Halter	1	2
3	09 14 10 150 90	Dichtung	2	2
4	09 27 97 015-42	Rosette	1	60
5	90 11 03 070 00-42	Rohr	1	30
6	09 23 01 075 90	Einsatz	1	2
7	90 12 05 091 20-42	Brause	1	30
8	90 30 09 069 00 90	Schlüssel	1	2