

**UP-Einhandbatterie mit integriertem Brauseanschluss - Messing gebürstet
(23kt Gold)**

IMO











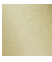

36 050 970

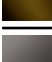

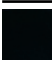
- ohne Rosette
Eigensicher gegen Rückfließen.

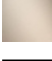
Eigensicher gegen Rückfließen.

Passt zu: IMO, LULU, MADISON, MEM,
TARA, CL.1, LISSÉ, VAIA, META, CYO

	Messing gebürstet (23kt Gold)	36 050 970-28
	Chrom	36 050 970-00
	Platin gebürstet	36 050 970-06
	Platin	36 050 970-08
	Dark Brass matt	36 050 970-16
	Dark Chrome	36 050 970-19
	Light Gold	36 050 970-26
	Light Gold gebürstet	36 050 970-27
	Schwarz matt	36 050 970-33
	Bronze gebürstet	36 050 970-42
	Champagne gebürstet (22kt Gold)	36 050 970-46
	Champagne (22kt Gold)	36 050 970-47
	Chrom gebürstet	36 050 970-93
	Dark Platinum gebürstet	36 050 970-99

Benötigtes Zubehör

UP-Wandbefestigung -

35 050 970 90

- Max. Einbautiefe 105 mm
- Min. Einbautiefe 80 mm



36 050 970
mm [inches]

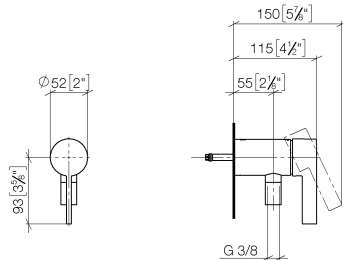

Durchflussdiagramm



Zertifikate

Belgaqua_21-025- WRAS_2011027. LGA_29928.
27_1.

36 050 970

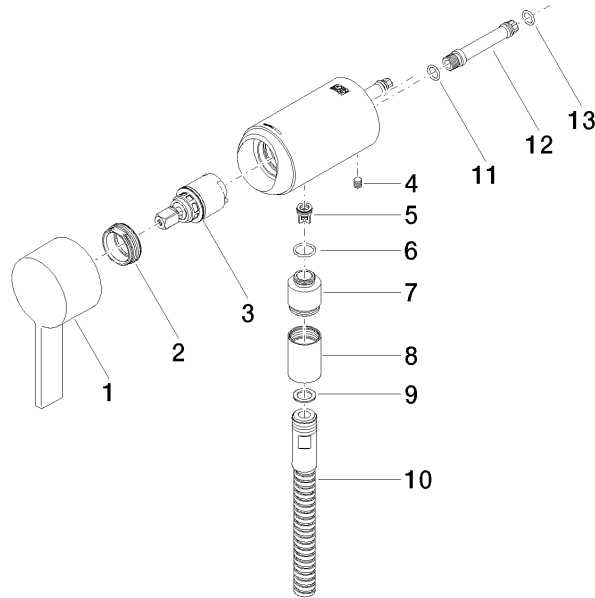

Ersatzteilstückliste

Nr.	Artikelnummer	Benennung	Verbaumenge	Lieferzeit
1	90 20 97 064 00-28	Griff	1	20
2	09 24 04 266 90	Mutter	1	2
3	90 15 05 044 04 90	Kartusche	1	10
4	09 31 11 004 90	Stift	1	60
5	09 23 01 131 90	Rueckflussverhinderer	1	2
6	09 14 10 213 90	Dichtung	1	2
7	09 24 03 281-28	Nippel	1	20
8	90 21 02 069 00-28	Haube	1	20
9	90 14 20 026 00 90	Dichtung	1	2
10	28 322 970-28	Metall-Brauseschlauch 1/2" x 3/8" x 1750 mm - Messing gebürstet (23kt Gold)	1	20
11	90 14 10 060 00 90	Dichtung	1	2
12	09 18 40 230 90	Anschluss	1	2
13	09 14 10 061 90	Dichtung	1	2