









## Rohrunterbrecher - Platin gebürstet

36 150 970

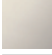

- Rosette Ø 70 mm  
**Bausatz-Endmontage**  
für Wanneneinlauf mit Ab- und Überlaufgarnitur  
(35 247 970 90 bzw. 35 246 970 90)

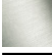
Bausatz-Endmontage  
für Wanneneinlauf mit Ab- und Überlaufgarnitur (35  
247 970 90 bzw. 35 246 970 90)

|   |                                       |               |
|---|---------------------------------------|---------------|
|    | Platin gebürstet                      | 36 150 970-06 |
|    | Chrom                                 | 36 150 970-00 |
|    | Platin                                | 36 150 970-08 |
|    | Messing (23kt<br>Gold)                | 36 150 970-09 |
|    | Dark Chrome                           | 36 150 970-19 |
|    | Messing gebürstet<br>(23kt Gold)      | 36 150 970-28 |
|    | Schwarz matt                          | 36 150 970-33 |
|    | Champagne<br>gebürstet (22kt<br>Gold) | 36 150 970-46 |
|    | Champagne (22kt<br>Gold)              | 36 150 970-47 |
|   | Chrom gebürstet                       | 36 150 970-93 |
|  | Dark Platinum<br>gebürstet            | 36 150 970-99 |

### Benötigtes Zubehör



Rohrunterbrecher -

35 150 970 90

## Rohrunterbrecher - Platin gebürstet

---

36 150 970

mm [inches]

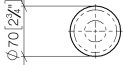

## Rohrunterbrecher - Platin gebürstet

36 150 970

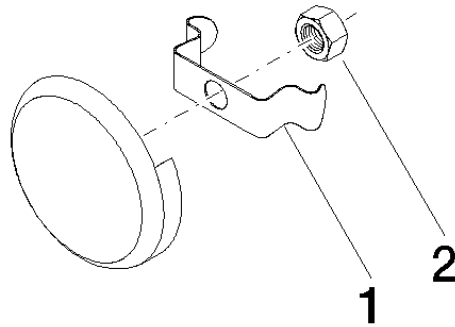

### Ersatzteilstückliste

| Nr. | Artikelnummer   | Benennung | Verbaumenge | Lieferzeit |
|-----|-----------------|-----------|-------------|------------|
| 1   | 08 16 02 500 90 | Feder     | 1           | 2          |
| 2   | 09 23 10 026 90 | Mutter    | 1           | 2          |