





**MEM Bec déverseur de bain sans inverseur positionnement libre - Champagne
brossé (Or 22cts)**

MEM

13 672 780

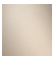

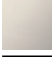
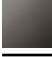
- saillie 280 mm
- jet cascade
- hauteur totale 830 - 900 mm
- hauteur jusqu'au mousseur 665 – 735 mm
- rosace coulissante 130 x 130 mm
- débit d'eau maxi. 47,8 l/min avec une pression d'écoulement de 3 bars

	Champagne brossé (Or 22cts)	13 672 780-46
	Chrome	13 672 780-00
	Platine brossé	13 672 780-06
	Platine	13 672 780-08
	Dark Chrome	13 672 780-19
	Laiton brossé (Or 23cts)	13 672 780-28
	Champagne (Or 22cts)	13 672 780-47

Accessoires requis



Fixation au sol à encastrer - 35 945 970 90

- profondeur de montage max. 150 mm
- profondeur de montage mini. 80 mm

**MEM Bec déverseur de bain sans inverseur positionnement libre - Champagne
brossé (Or 22cts)**

MEM

13 672 780
mm [inches]



Diagramme de débit



13 672 780

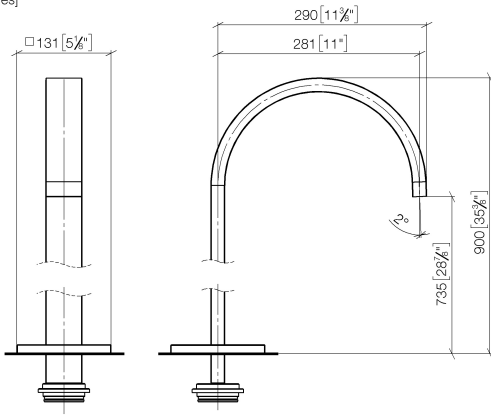
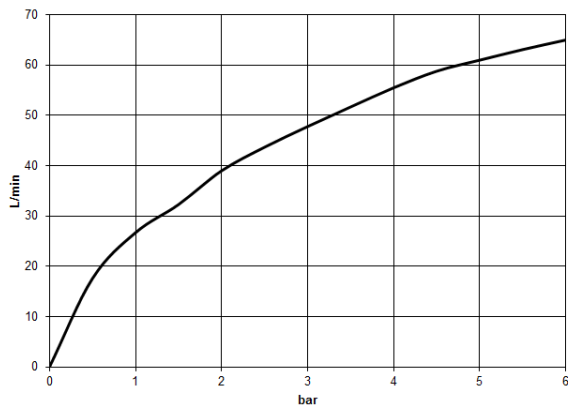