







## IMO Bec déverseur de bain pour montage mural - Dark Platinum brossé

IMO

13 801 670



- saillie 200 mm
- jet normal rectangulaire
- diamètre de percement 37 mm
- raccord 1/2"
- débit d'eau maxi. 25,1 l/min avec une pression d'écoulement de 3 bars

	Dark Platinum brossé	13 801 670-99
	Chrome	13 801 670-00
	Platine brossé	13 801 670-06
	Dark Chrome	13 801 670-19
	Light Gold brossé	13 801 670-27
	Noir mat	13 801 670-33
	Chrome brossé	13 801 670-93

### Accessoires recommandés



- Coude mural à encastrer -** 35 085 970 90
- profondeur de montage mini. 90 mm
  - profondeur de montage max. 163 mm

13 801 670

mm [inches]

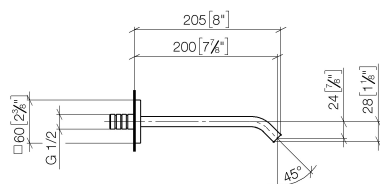

### Diagramme de débit

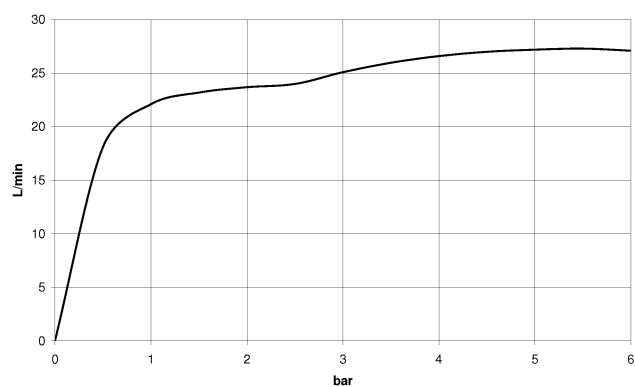

### Codes & Standards

Scottish Water  
Byelaws

UK Water Supply  
Regulations



## IMO Bec déverseur de bain pour montage mural - Dark Platinum brossé

---

IMO

13 801 670

Certificats et durabilité

---

WRAS\_2005

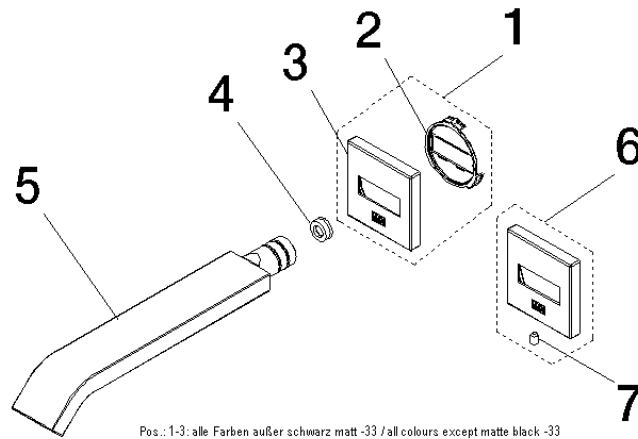

Pos.: 1-3: alle Farben außer schwarz matt -33 / all colours except matte black -33  
Pos.: 6-7: nur Farbe schwarz matt -33 / only colour matte black -33