

MADISON Douche de tête - Platine brossé

MADISON











28 508 360

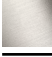

- pomme de douche Ø 94 mm
- 3 jets réglables : COMPACT RAIN, COMPACT SOFT FLOW, COMPACT AQUAPRESSURE FLOW, débit max. 9 l/min (à 3 bar)
- Fonction à partir de: 7 l/min
- avec système anti-calcaire

Données techniques :

- saillie 200 mm
- rotule 30° pivotante
- rosace Ø 55 mm
- raccord 1/2"

	Platine brossé	28 508 360-06
	Chrome	28 508 360-00 0010
	Chrome	28 508 360-00
	Platine brossé	28 508 360-06 0010
	Platine	28 508 360-08 0010
	Platine	28 508 360-08
	Laiton (Or 23cts)	28 508 360-09 0010
	Laiton (Or 23cts)	28 508 360-09
	Laiton brossé (Or 23cts)	28 508 360-28 0010
	Laiton brossé (Or 23cts)	28 508 360-28
	Dark Platinum brossé	28 508 360-99 0010
	Dark Platinum brossé	28 508 360-99

Accessoires recommandés



- Coude mural à encastrer -** 35 085 970 90
- profondeur de montage max. 163 mm
 - profondeur de montage mini. 90 mm

28 508 360

mm [inches]



Diagramme de débit



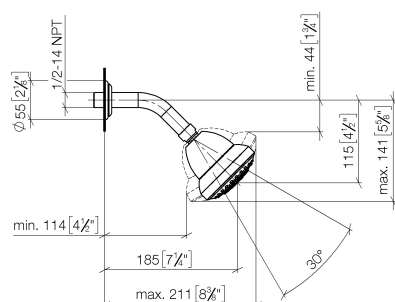
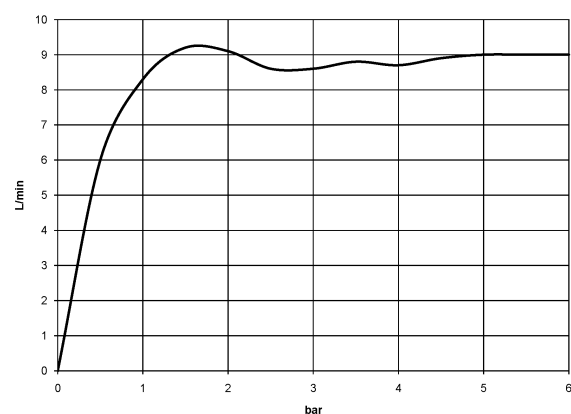
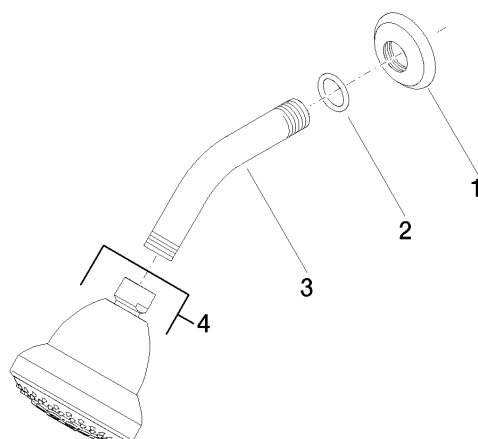

Liste des pièces de rechange

N°	Article Numéro	Désignation	Fréquence de montage	Délai de livraison
4	04 12 11 120 00-06	douche	1,00	-
La pièce de rechange ne peut plus être commandée, veuillez commander l'article de remplacement				
1	09 27 35 003-06	rosace	1,00	10
3	09 11 03 011-06	raccord	1,00	10
2	90 14 10 026 00 90	joint	1,00	2