

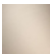

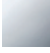

36 200 705

- inverseur rotatif
- rosace 60 x 60 mm



| | | |
|---|-----------------------------|---------------|
|  | Champagne brossé (Or 22cts) | 36 200 705-46 |
|  | Chrome | 36 200 705-00 |
|  | Platine brossé | 36 200 705-06 |
|  | Dark Chrome | 36 200 705-19 |
|  | Champagne (Or 22cts) | 36 200 705-47 |
|  | Dark Platinum brossé | 36 200 705-99 |

36 200 705

mm [inches]



Diagramme de débit



Certificats

LGA_38379.

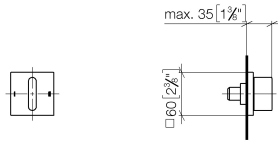
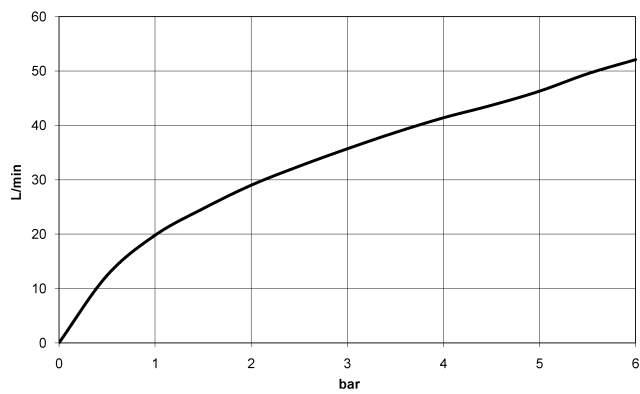
WRAS_2307045.

36 200 705

Les pièces pour les autres finitions peuvent être trouvées ici : [Chrome](#)

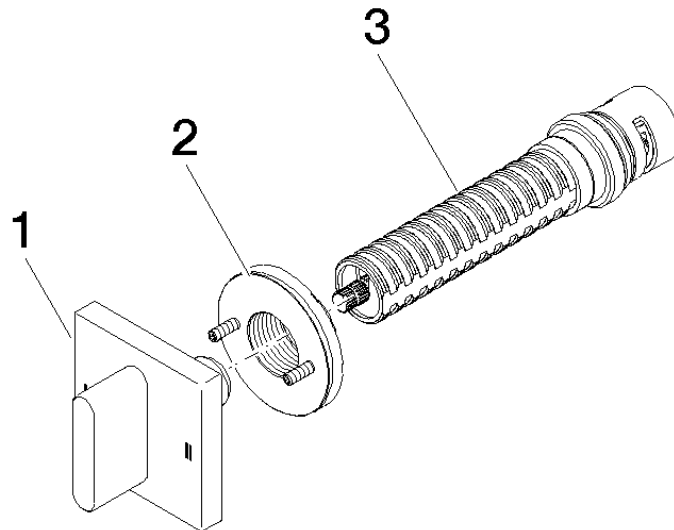

Liste des pièces de rechange

| N° | Article Numéro | Désignation | Fréquence de montage | Délai de livraison |
|----|--------------------|-------------|----------------------|--------------------|
| 1 | 90 20 70 051 08-46 | poignée | 1 | 30 |
| 2 | 90 21 02 181 00 90 | rondelle | 1 | 2 |
| 3 | 90 90 03 304 10 90 | inverseur | 1 | 2 |