

## MADISON Doccetta - Platinato spazzolato







MADISON

28 002 978    Versione del prodotto da 01/07/2025



- A tre regolazioni: COMPACT RAIN, COMPACT SOFT FLOW, COMPACT AQUAPRESSURE FLOW, portata max. 9 l/min (a 3 bar)
- con sistema anticalcare
- Soffione Ø 95mm
- ingresso 1/2"

Sistema di sicurezza antiriflusso.

	Platinato spazzolato	28 002 978-06
	Cromato	28 002 978-00
	Cromato	28 002 978-00 0010
	Platinato spazzolato	28 002 978-06 0010
	Platinato	28 002 978-08
	Platinato	28 002 978-08 0010
	Ottone (Oro 23k)	28 002 978-09
	Ottone (Oro 23k)	28 002 978-09 0010
	Ottone spazzolato (Oro 23k)	28 002 978-28
	Ottone spazzolato (Oro 23k)	28 002 978-28 0010
	Dark Brass spazzolato	28 002 978-39
	Dark Brass spazzolato	28 002 978-39 0010
	Cromo spazzolato	28 002 978-93
	Cromo spazzolato	28 002 978-93 0010
	Dark Platinum spazzolato	28 002 978-99
	Dark Platinum spazzolato	28 002 978-99 0010

mm [inches]

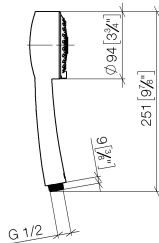

### Diagramma di portata

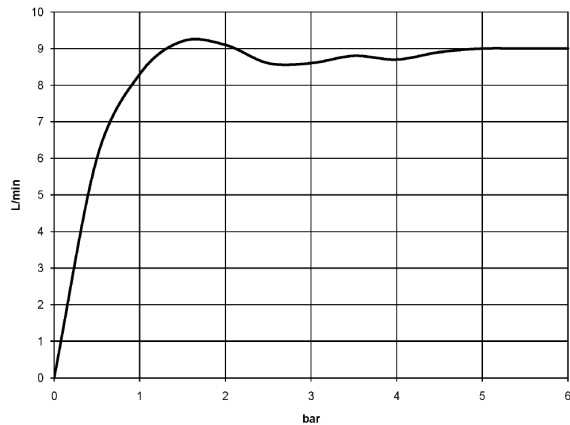

### Codes & Standards

DIN 4109

ISO 3822

Ü-Zeichen



## MADISON Doccetta - Platinato spazzolato

MADISON

28 002 978    Versione del prodotto da 01/07/2025

Certificati e sostenibilità

LGA\_18

Parts for other  
finishes can be found  
here: Cromato

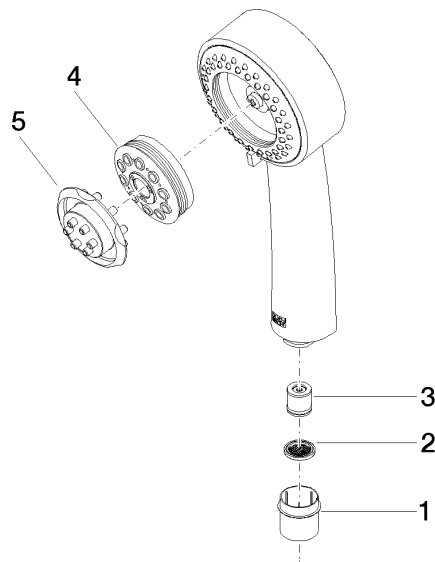

## Elenco delle parti di ricambio

N.	Codice articolo	Denominazione	Quantità necessaria	Tempo di produzione
3	09 23 01 077 90	limitatore di portata	1,00	2
5	09 30 09 022 90	chiave	1,00	2
4	04 12 11 071 00 90	doccia	1,00	2
1	09 21 02 115 90	calotta	1,00	2
2	09 23 01 039 90	setaccio	1,00	2