







LISSÉ Bocca vasca montaggio a muro - Dark Chrome

LISSÉ

13 801 845 Versione del prodotto da 09/03/2016

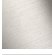

- sporgenza 210 mm
- Getto circolare
- diametro foro 37 mm
- ingresso 1/2"
- montaggio con attacco rapido
- portata max 21,5 l/min a una pressione idraulica di 3 bar

	Dark Chrome	13 801 845-19
	Cromato	13 801 845-00
	Platinato spazzolato	13 801 845-06
	Light Gold spazzolato	13 801 845-27
	Nero opaco	13 801 845-33
	Cromo spazzolato	13 801 845-93
	Dark Platinum spazzolato	13 801 845-99

mm [inches]



Diagramma di portata



Codes & Standards

ASME A112.18.1 cUPC DIN 4109 ISO 3822

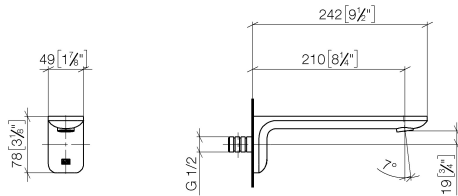
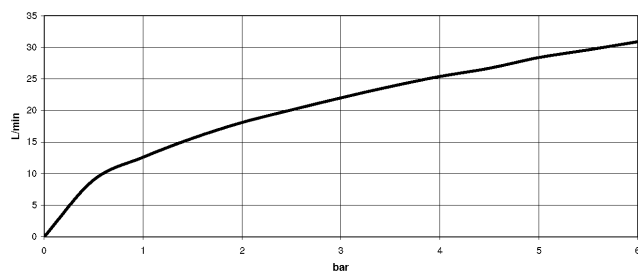
Scottish Water Byelaws UK Water Supply Regulations Ü-Zeichen



LISSE Bocca vasca montaggio a muro - Dark Chrome

LISSE

13 801 845 Versione del prodotto da 09/03/2016

Certificati e sostenibilità

IAPMO_4976

LGA_29

WRAS_2207

Parts for other
finishes can be found
here: Cromato

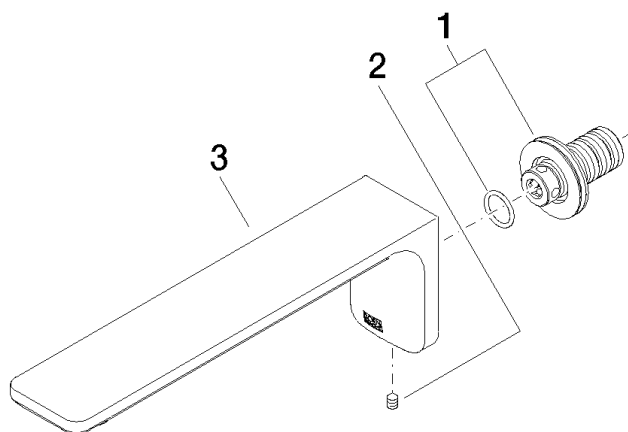

Elenco delle parti di ricambio

N.	Codice articolo	Denominazione	Quantità necessaria	Tempo di produzione
3	90 11 84 014 02-19	bocca di erogazione	1,00	20
1	90 24 03 108 00 90	set di nippel	1,00	2
2	90 31 11 004 00 90	perno	1,00	2