

## MEM Deck-mounted basin spout with pop-up waste - Brushed Durabrand (23kt Gold)







MEM

13 715 782



- 200mm projection
- fixed spout
- rectangular, air-enriched flow
- height of mixer 321 mm
- height up to aerator 190 mm
- hole diameter 35 mm
- 2x screw-in M 10 x 1 pressure hose, leak-tested
- rosette 60 x 60 mm
- max. flow 5.7 l/min
- lead-free
- This product can help a building meet the requirements of Green Building Rating Systems, e.g. LEED®, BREEAM®, DGNB

Only suitable for basins with an overflow.

	Brushed Durabrand (23kt Gold)	13 715 782-28
	Chrome	13 715 782-00
	Brushed Platinum	13 715 782-06
	Platinum	13 715 782-08
	Dark Chrome	13 715 782-19
	Brushed Champagne (22kt Gold)	13 715 782-46
	Champagne (22kt Gold)	13 715 782-47
	Brushed Dark Platinum	13 715 782-99

## MEM Deck-mounted basin spout with pop-up waste - Brushed Durabron (23kt Gold)

MEM

13 715 782  
mm [inches]

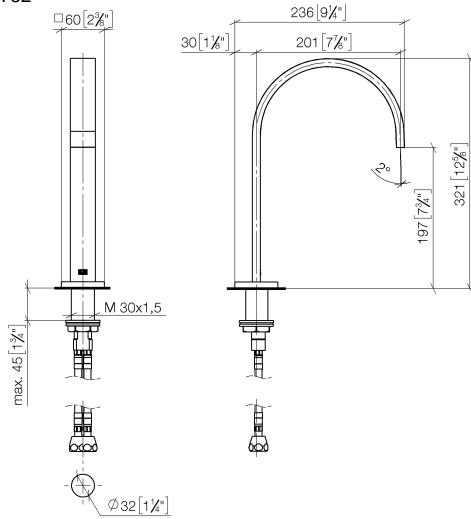

### Flow rate chart



### Codes & Standards

Executive Order  
no. 1007



## MEM Deck-mounted basin spout with pop-up waste - Brushed Durabronz (23kt Gold)

MEM

---

13 715 782

Certificates

---

GDV\_0400

# MEM Deck-mounted basin spout with pop-up waste - Brushed Durabronz (23kt Gold)

MEM

13 715 782

Product version from 3/10/2014 to 6/16/2021

## Product version from 7/1/2021

Parts for other  
finishes can be found  
here: [Chrome](#)

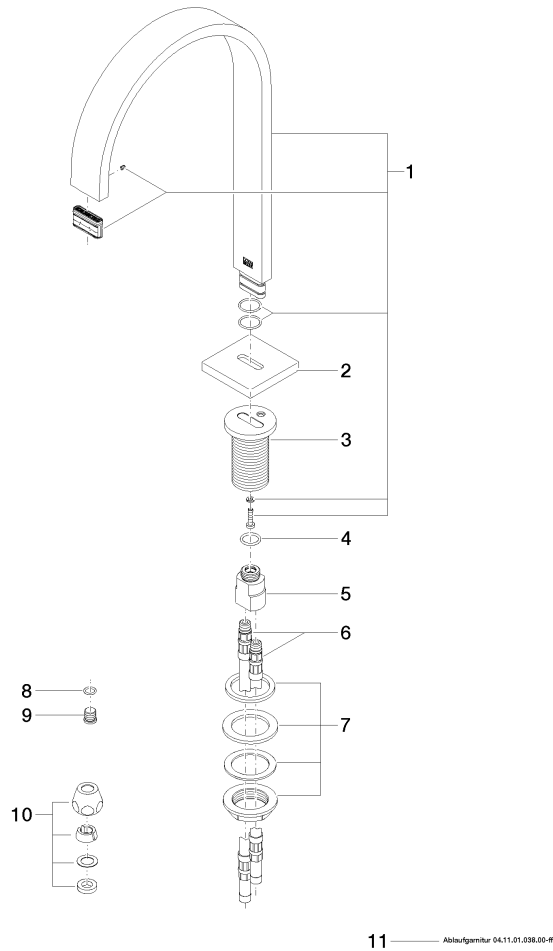



MEM Deck-mounted basin spout with pop-up waste - Brushed Durabrass (23kt Gold)

MEM

13 715 782				
Spare parts list				
Product version from 3/10/2014 to 6/16/2021				
Product version from 7/1/2021				
No.	Item Number	Name	Quantity used	Delivery time
	90 28 22 155 01-28	spout	13	20