

## VAIA Two-hole bridge mixer for rinsing/Profi spray - Champagne (22kt Gold)

VAIA

19 815 809



- 241mm projection
- pivotable spout 360°
- air-enriched flow
- max. flow 7 l/min at 3 bar flow pressure
- lead-free
- This product can help a building meet the requirements of Green Building Rating Systems, e.g. LEED®, BREEAM®, DGNB

|  |                               |               |
|--|-------------------------------|---------------|
|    | Champagne (22kt Gold)         | 19 815 809-47 |
|    | Chrome                        | 19 815 809-00 |
|    | Brushed Platinum              | 19 815 809-06 |
|    | Platinum                      | 19 815 809-08 |
|    | Durabrand (23kt Gold)         | 19 815 809-09 |
|    | Dark Chrome                   | 19 815 809-19 |
|    | Brushed Durabrand (23kt Gold) | 19 815 809-28 |
|    | Matte Black                   | 19 815 809-33 |
|    | Brushed Champagne (22kt Gold) | 19 815 809-46 |
|   | Brushed Chrome                | 19 815 809-93 |
|  | Brushed Dark Platinum         | 19 815 809-99 |

### Recommended miscellaneous

**VAIA Dispenser with rosette - Champagne (22kt Gold)**

82 434 809-47



19 815 809

mm [inches]  
1:5

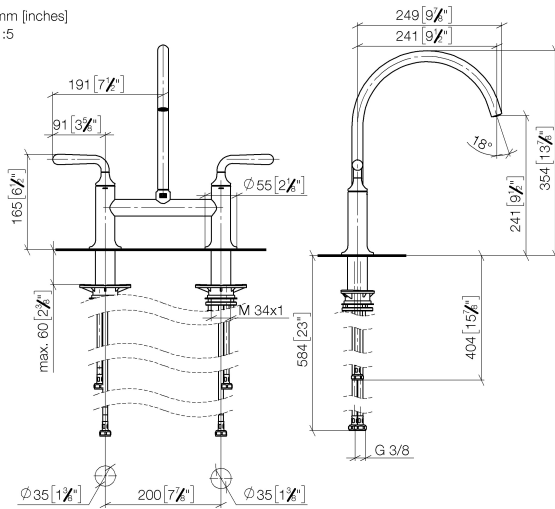

## Flow rate chart

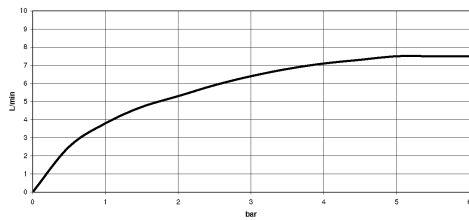

## Codes & Standards

DIN 4109

ISO 3822

Ü-Zeichen



## VAIA Two-hole bridge mixer for rinsing/Profi spray - Champagne (22kt Gold)

---

VAIA

19 815 809

### Certificates

---

LGA\_38

**Product version from 7/1/2023**

Parts for other  
finishes can be found  
here: [Chrome](#)

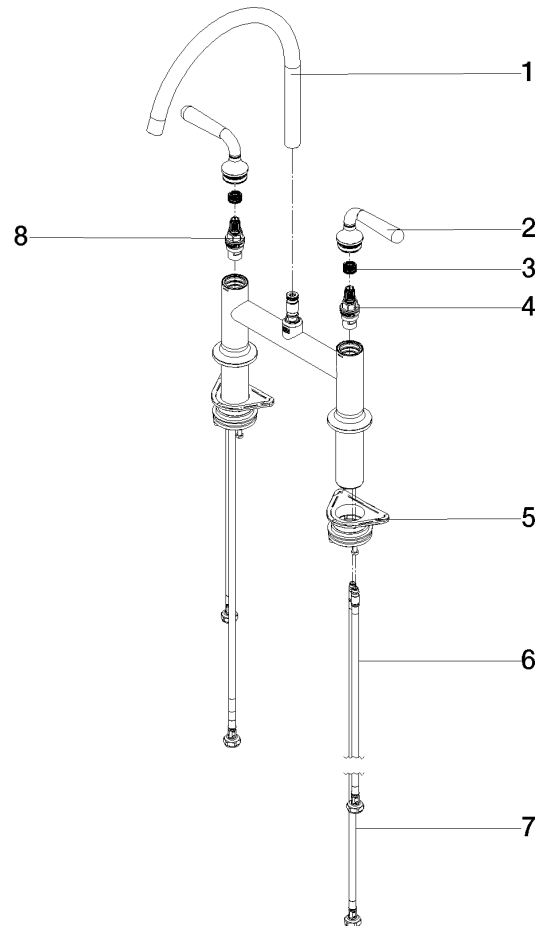



## VAIA Two-hole bridge mixer for rinsing/Profi spray - Champagne (22kt Gold)

VAIA

19 815 809

### Spare parts list

#### Product version from 7/1/2023

| No. | Item Number        | Name  | Quantity used | Delivery time |
|-----|--------------------|-------|---------------|---------------|
|     | 90 28 22 396 00-47 | spout | 13            | 60            |