

Deck valve anti-clockwise closing cold - Champagne (22kt Gold)

CL.1

20 004 716



- hole diameter 32 mm
- rosette 60 x 47 mm
- with cold marking

Fits: CL.1, CYO

	Champagne (22kt Gold)	20 004 716-47
	Chrome	20 004 716-00
	Brushed Platinum	20 004 716-06
	Brushed Durabross (23kt Gold)	20 004 716-28
	Brushed Champagne (22kt Gold)	20 004 716-46
	Brushed Dark Platinum	20 004 716-99

20 004 716

mm [inches]

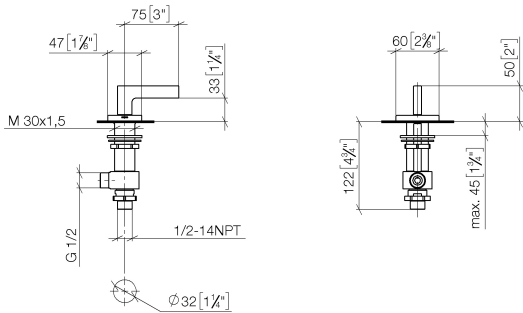

Flow rate chart

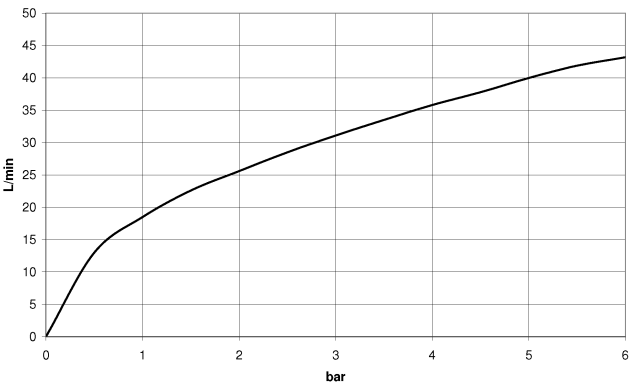

Codes & Standards

DIN 4109

ISO 3822

NSF372

NSF61

Ü-Zeichen



## Deck valve anti-clockwise closing cold - Champagne (22kt Gold)

---

CL.1

20 004 716

### Certificates

---

IAPMO\_N-4

LGA\_28

IAPMO\_6

**Product version from 6/1/2015**

Parts for other  
finishes can be found  
here: [Chrome](#)

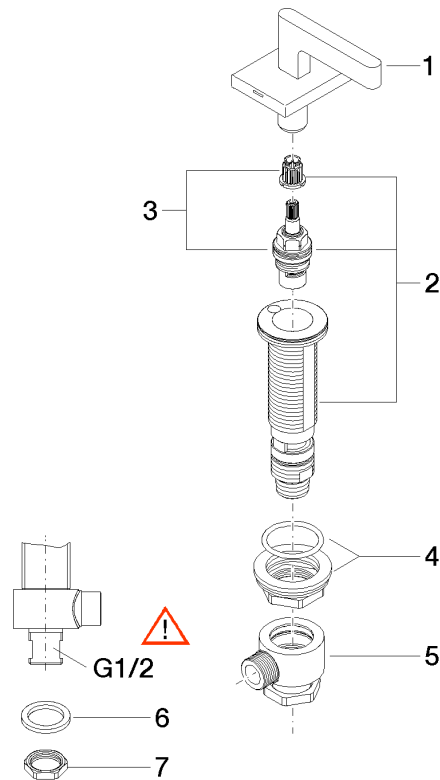



## Deck valve anti-clockwise closing cold - Champagne (22kt Gold)

CL.1

20 004 716

### Spare parts list

#### Product version from 6/1/2015

No.	Item Number	Name	Quantity used	Delivery time
	90 20 70 057 03-47	handle ( cold )	7	30