

# Shower set without hand shower - Matte Black

26 413 979    Product version from 10/1/2023



- COMPACT RAIN, max. flow rate l/min (at 3 bar)
- \_x000D\_
- gauge 853 mm
- shower hose connector 3/8"
- metal shower hose 1750mm with integrated anti-twist protection
- slide bar
- Pipe diameter 18 mm
- inherently safe from back flow.
- WRAS

This article does not include a hand shower!

	Matte Black	26 413 979-33
	Chrome	26 413 979-00
	Brushed Platinum	26 413 979-06
	Platinum	26 413 979-08
	Dark Chrome	26 413 979-19
	Light Gold	26 413 979-26
	Brushed Light Gold	26 413 979-27
	Brushed Durabrass (23kt Gold)	26 413 979-28
	Brushed Bronze	26 413 979-42
	Brushed Champagne (22kt Gold)	26 413 979-46
	Champagne (22kt Gold)	26 413 979-47
	Brushed Chrome	26 413 979-93
	Brushed Dark Platinum	26 413 979-99

## Recommended miscellaneous

	<b>Concealed wall elbow -</b> •max. recess depth mm •min. recess depth mm	35 085 970 90
---	---	---------------

## Recommended miscellaneous

	<b>Wall elbow - Matte Black</b>	28 450 980-33
---	---------------------------------	---------------



## Shower set without hand shower - Matte Black

26 413 979 Product version from 10/1/2023

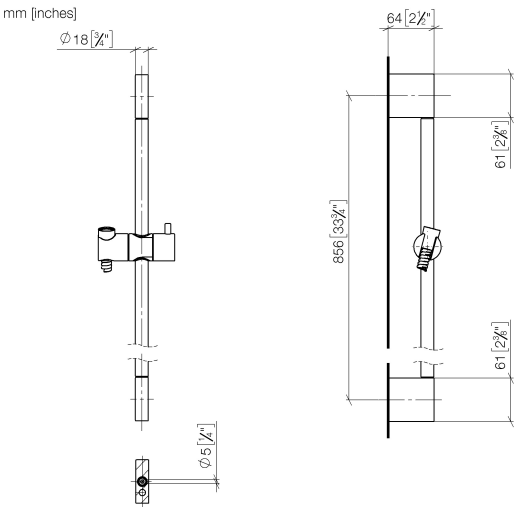

### Codes & Standards

ASME A112.18.1	cUPC	Scottish Water Byelaws	UK Water Supply Regulations
XP P 41-280			

### Certificates

WRAS_2009	ACS_20 ACC LY	IAPMO_4976
-----------	---------------	------------

# Shower set without hand shower - Matte Black

26 413 979 Product version from 10/1/2023

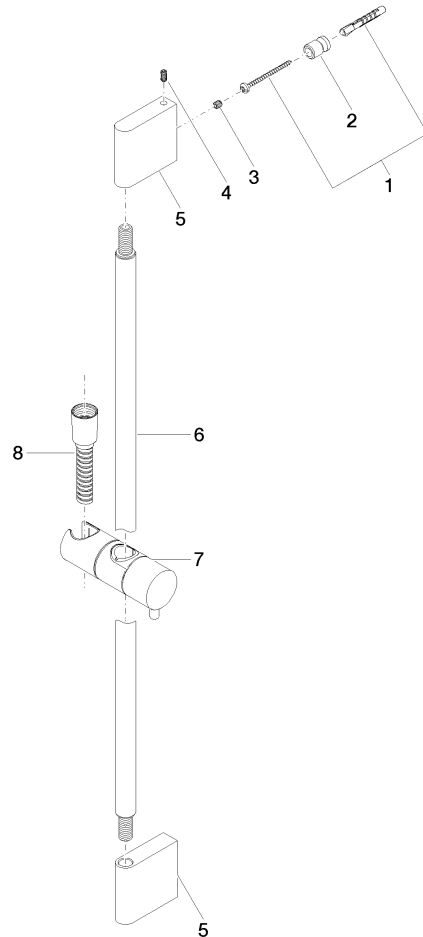

## Spare parts list

No.	Item Number	Name	Quantity used	Delivery time
1	05 17 20 726 02 90	fixing set	2	2
2	08 17 20 726 90	holder	2	2
3	09 31 11 049 90	pin	2	2
4	04 31 11 113 00 90	pin	2	2
5	08 17 97 054-33	holder	2	30
6	90 28 22 597 00-33	holder	1	30
7	12 580 970-33	Slide unit - Matte Black	1	10
8	28 322 970-33	Metal shower hose 1/2" x 3/8" x 1750 mm - Matte Black	1	2