



Rain shower:

- rain shower Ø 200 mm
- overhead shower: rain flow
- max. rainshower flow 7 l/min
- Function from: l/min

hand shower:

Control element:

- rotary diverter for fixed-riser shower/hand shower
- metal shower hose 1250mm with integrated anti-twist protection

Technical data:







- shower with fixed riser projection 420mm
- height of fittings up to rain shower (bottom edge) 1009mm
- height of fittings up to top edge of elbow 1180mm
- rosette for wall mounting Ø 70mm
- rosette for shower mixer Ø 60mm
- rosette for shower holder Ø 66mm
- Pipe diameter 20 mm
- gauge 150 mm - 13 mm
- 1/2" connection

Notes:

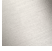
- This product can help a building meet the requirements of Green Building Rating Systems, e.g. LEED®, BREEAM®, DGNB

This article does not include a hand shower!

Intrinsic protection against back flow.

	Chrome	26 632 360-00 0050
	Brushed Platinum	26 632 360-06 0050
	Platinum	26 632 360-08 0050
	Durabrand (23kt Gold)	26 632 360-09 0050
	Brushed Durabrand (23kt Gold)	26 632 360-28 0050
	Brushed Dark Brass	26 632 360-39 0050
	Brushed Dark Platinum	26 632 360-99 0050

26 632 360 Product version from 7/1/2022

mm [inches]

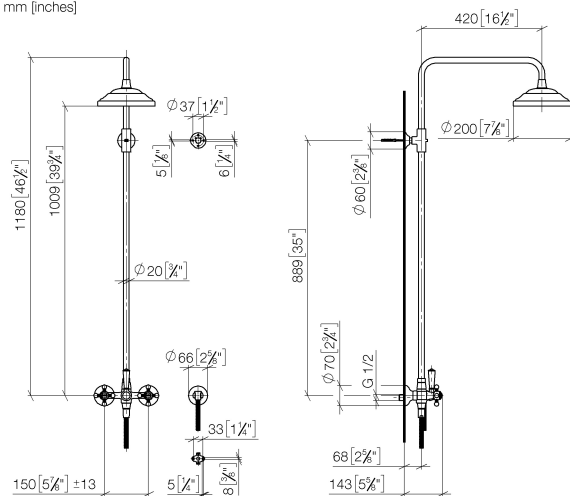

Flow rate chart

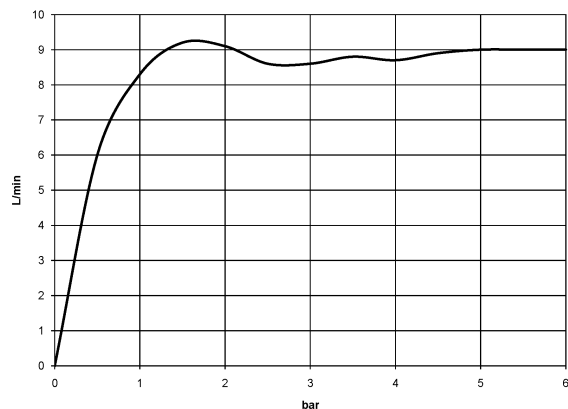

Parts for other
finishes can be found
here: Brushed
Platinum

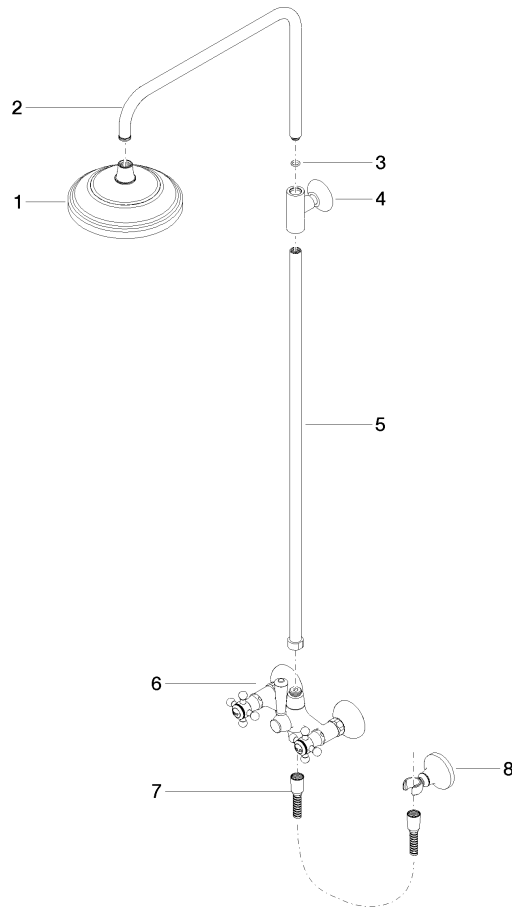

Spare parts list

No.	Item Number	Name	Quantity used	Delivery time
7	28 104 970-00	Metal shower hose 1/2" x 1/2" x 1250 mm - Chrome	1.00	2
4	90 17 11 033 00-00	holder	1.00	10
6	04 17 10 001 00-00	fitting	1.00	60
8	28 050 410-00	holder	1.00	60
2	04 28 22 101 20-00	spout	1.00	10
5	90 28 22 096 00-00	pipe	1.00	10
1	90 12 05 038 20-00	shower	1.00	10
3	90 14 10 011 00 90	seal	1.00	2