

MADISON Showerpipe with shower mixer without hand shower - Brushed Platinum

MADISON

26 632 360 Product version from 7/1/2022



Rain shower:

- rain shower Ø 200 mm
- overhead shower: rain flow
- max. rainshower flow 7 l/min
- Function from: l/min

hand shower:

Control element:

- rotary diverter for fixed-riser shower/hand shower
- metal shower hose 1250mm with integrated anti-twist protection

Technical data:







- shower with fixed riser projection 420mm
- height of fittings up to rain shower (bottom edge) 1009mm
- height of fittings up to top edge of elbow 1180mm
- rosette for wall mounting Ø 70mm
- rosette for shower mixer Ø 60mm
- rosette for shower holder Ø 66mm
- Pipe diameter 20 mm
- gauge 150 mm - 13 mm
- 1/2" connection

Notes:

- This product can help a building meet the requirements of Green Building Rating Systems, e.g. LEED®, BREEAM®, DGNB

This article does not include a hand shower!

Intrinsic protection against back flow.

| | | |
|---|-------------------------------|--------------------|
|  | Brushed Platinum | 26 632 360-06 0050 |
|  | Chrome | 26 632 360-00 0050 |
|  | Platinum | 26 632 360-08 0050 |
|  | Durabrand (23kt Gold) | 26 632 360-09 0050 |
|  | Brushed Durabrand (23kt Gold) | 26 632 360-28 0050 |
|  | Brushed Dark Brass | 26 632 360-39 0050 |
|  | Brushed Dark Platinum | 26 632 360-99 0050 |

MADISON Showerpipe with shower mixer without hand shower - Brushed Platinum

MADISON

26 632 360 Product version from 7/1/2022
mm [inches]

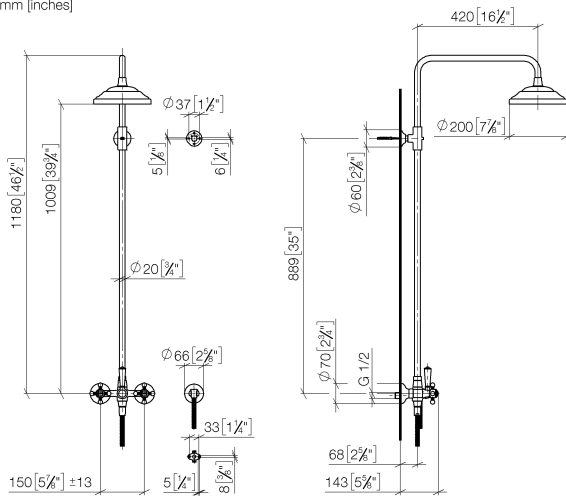

Flow rate chart

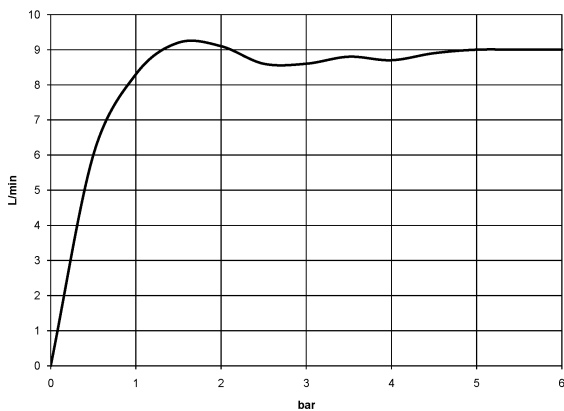

MADISON Showerpipe with shower mixer without hand shower - Brushed Platinum

MADISON

26 632 360 Product version from 7/1/2022

Parts for other
finishes can be found
here: [Chrome](#)

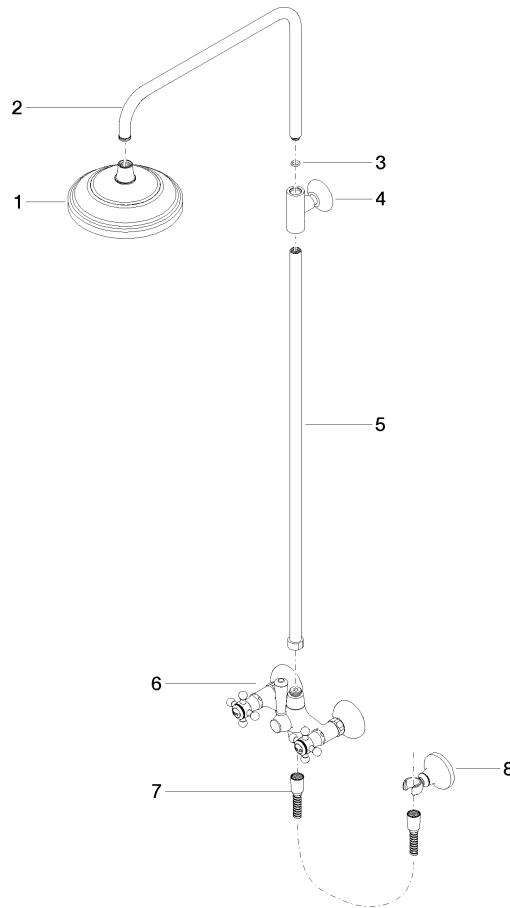

Spare parts list

| No. | Item Number | Name | Quantity used | Delivery time |
|--|--------------------|--|---------------|---------------|
| 2 | 04 28 22 101 20-06 | spout | 1.00 | 10 |
| 8 | 28 050 410-06 | holder | 1.00 | 60 |
| 6 | 04 17 10 001 00-06 | fitting | 1.00 | 60 |
| 5 | 90 28 22 096 00-06 | pipe | 1.00 | 10 |
| 7 | 28 104 970-06 | Metal shower hose 1/2" x 1/2" x 1250 mm - Brushed Platinum | 1.00 | 2 |
| 4 | 90 17 11 033 00-06 | holder | 1.00 | - |
| Spare part can no longer be ordered, please order the replacement item | | | | |
| 1 | 90 12 05 038 20-06 | shower | 1.00 | 10 |
| 3 | 90 14 10 011 00 90 | seal | 1.00 | 2 |