

Hand shower set with integrated shower holder - Brushed Platinum

SERIES SPECIFIC

27 803 660 Product version from 7/1/2022



- COMPACT RAIN, max. flow rate 6.8 l/min (at 3 bar)
- three settings: normal flow, soft flow, massage flow
- with anti-scale system
- 3/8" shower outlet
- metal shower hose 1250mm with integrated anti-twist protection
- rosette Ø 60 mm
- 1/2" connection
- This product can help a building meet the requirements of Green Building Rating Systems, e.g. LEED®, BREEAM®, DGNB

Intrinsic protection against back flow.

| | | |
|---|-------------------------------|--------------------|
|  | Brushed Platinum | 27 803 660-06 0050 |
|  | Chrome | 27 803 660-00 0050 |
|  | Platinum | 27 803 660-08 0050 |
|  | Dark Chrome | 27 803 660-19 0050 |
|  | Light Gold | 27 803 660-26 0050 |
|  | Brushed Light Gold | 27 803 660-27 0050 |
|  | Brushed Durabrass (23kt Gold) | 27 803 660-28 0050 |
|  | Matte Black | 27 803 660-33 0050 |
|  | Brushed Dark Brass | 27 803 660-39 0050 |
|  | Brushed Bronze | 27 803 660-42 0050 |
|  | Brushed Champagne (22kt Gold) | 27 803 660-46 0050 |
|  | Champagne (22kt Gold) | 27 803 660-47 0050 |
|  | Brushed Chrome | 27 803 660-93 0050 |
|  | Brushed Dark Platinum | 27 803 660-99 0050 |

Recommended miscellaneous

Concealed wall elbow -

35 085 970 90



- max. recess depth 163 mm
- min. recess depth 90 mm

mm [inches]

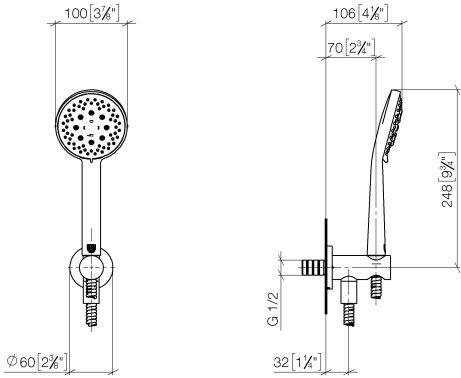

Flow rate chart

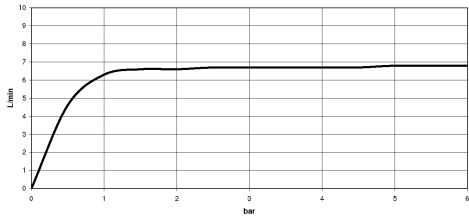

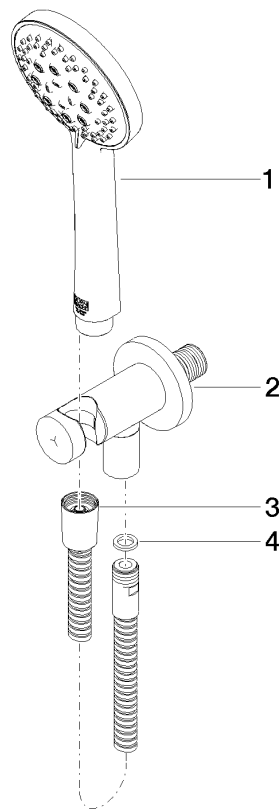

Spare parts list

| No. | Item Number | Name | Quantity used | Delivery time |
|--|--------------------|---|---------------|---------------|
| 2 | 28 490 660-06 | Wall elbow with integrated shower holder - Brushed Platinum | 1.00 | 10 |
| 3 | 90 30 02 072 00-06 | Metal shower hose 1/2" x 3/8" x 1250 mm - Brushed Platinum | 1.00 | 10 |
| 1 | 28 014 979-06 0050 | Hand shower 6.8 l/min - Brushed Platinum | 1.00 | - |
| Spare part can no longer be ordered, please order the replacement item | | | | |
| | 28018979-060050 | Hand shower - Brushed Platinum | | |
| 4 | 90 14 20 026 00 90 | seal | 1.00 | 2 |