

**Rain shower for surface-mounted ceiling installation with light 300 mm -  
Brushed Light Gold**

28 032 970 Product version from 7/1/2022



- rain shower Ø 300 mm
- PURE RAIN, max. flow rate 6.8 l/min (at 3 bar)
- PURIFY RAIN, max. flow rate 6.8 l/min (at 3 bar)
- Distance to ceiling from bottom edge of shower 40 mm
- with anti-scale system

**Ceiling module power supply**

- 350mA (CC)

**Spot lighting**

- LED colour temperature approx. 3000 K
- Bulbs protected against splashing water
- Contains energy efficiency class bulbs
- Technology: LED, not dimmable
- Provided by customer: Light switch

**Environment**

- Not suitable for outdoor use.
- Not suitable for use in a steam room.
- Not suitable for use in chlorinated or salty environments.
- Comply with the protection zone regulations as defined in DIN VDE 0100, Part 701 (IEC 60364-7-701).

|  |                                |                    |
|--|--------------------------------|--------------------|
|  | Brushed Light Gold             | 28 032 970-27 0050 |
|  | Chrome                         | 28 032 970-00 0050 |
|  | Brushed Platinum               | 28 032 970-06 0050 |
|  | Platinum                       | 28 032 970-08 0050 |
|  | Dark Chrome                    | 28 032 970-19 0050 |
|  | Light Gold                     | 28 032 970-26 0050 |
|  | Brushed Durabronze (23kt Gold) | 28 032 970-28 0050 |
|  | Matte Black                    | 28 032 970-33 0050 |
|  | Brushed Bronze                 | 28 032 970-42 0050 |
|  | Brushed Champagne (22kt Gold)  | 28 032 970-46 0050 |
|  | Champagne (22kt Gold)          | 28 032 970-47 0050 |
|  | Brushed Chrome                 | 28 032 970-93 0050 |
|  | Brushed Dark Platinum          | 28 032 970-99 0050 |

**Required miscellaneous**



**Concealed ceiling installation box 35 042 970 90  
for surface-mounted ceiling  
installation with light -**

- concealed rough parts
- min. recess depth mm
- max. recess depth mm
- 2x female thread 1/2" connections
- Input 100-240V AC 50-60Hz
- Output 350 mA SELV / Class 2
- Provided by customer: Light switch

**Rain shower for surface-mounted ceiling installation with light 300 mm -  
Brushed Light Gold**

28 032 970    Product version from 7/1/2022  
mm [inches]

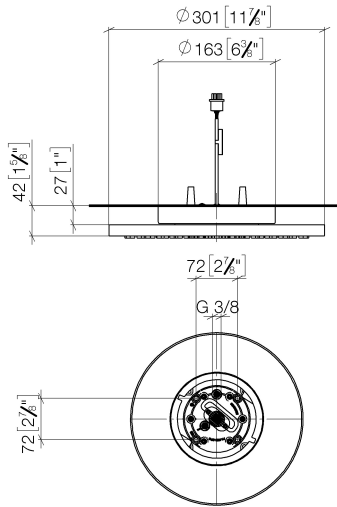

**Flow rate chart**



Rain shower for surface-mounted ceiling installation with light 300 mm -  
Brushed Light Gold

28 032 970
Product version from 7/1/2022

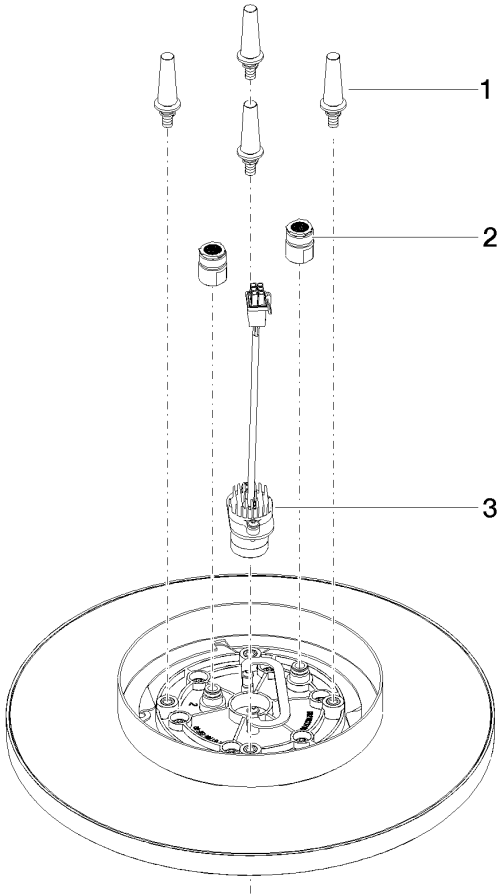

Spare parts list

| No. | Item Number        | Name                   | Quantity used | Delivery time |
|-----|--------------------|------------------------|---------------|---------------|
| 1   | 90 17 20 263 00 90 | fixing set             | 1             | 2             |
| 2   | 90 24 03 309 02 90 | connection             | 2             | 2             |
| 3   | 90 10 01 225 00 90 | electronic accessories | 1             | 2             |