

Rain shower for recessed ceiling installation 300 mm - Platinum

28 033 970 Product version from 7/1/2022

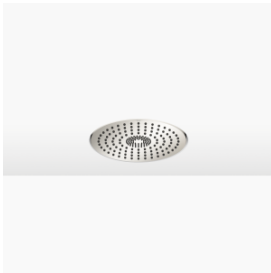

- rain shower Ø 300 mm
 - PURE RAIN, max. flow rate 6.8 l/min (at 3 bar)
 - PURIFY RAIN, max. flow rate 6.8 l/min (at 3 bar)
 - with anti-scale system
 - min. recess depth 137 mm
 - For simultaneous control of the jet types, we recommend the xTool thermostat module
 - This product can help a building meet the requirements of Green Building Rating Systems, e.g. LEED®, BREEAM®, DGNB
- Three-way diverter trim is sold separately**

Three-way diverter trim is sold separately

	Platinum	28 033 970-08 0050
	Chrome	28 033 970-00 0050
	Brushed Platinum	28 033 970-06 0050
	Dark Chrome	28 033 970-19 0050
	Light Gold	28 033 970-26 0050
	Brushed Light Gold	28 033 970-27 0050
	Brushed Durabronze (23kt Gold)	28 033 970-28 0050
	Matte Black	28 033 970-33 0050
	Brushed Bronze	28 033 970-42 0050
	Brushed Champagne (22kt Gold)	28 033 970-46 0050
	Champagne (22kt Gold)	28 033 970-47 0050
	Brushed Chrome	28 033 970-93 0050
	Brushed Dark Platinum	28 033 970-99 0050

Required miscellaneous



Concealed ceiling installation box for recessed ceiling installation -

- recess depth mm
- 2x female thread " outlet
- concealed rough parts
- flush-mounted installation box Ø 360 mm RAL 9003 signal white

Rain shower for recessed ceiling installation 300 mm - Platinum

28 033 970 Product version from 7/1/2022

mm [inches]

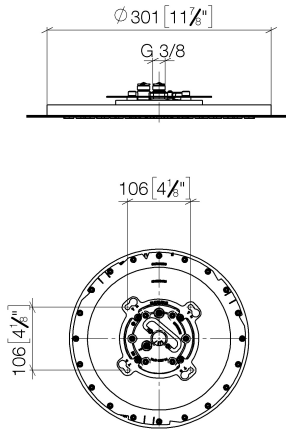

Flow rate chart

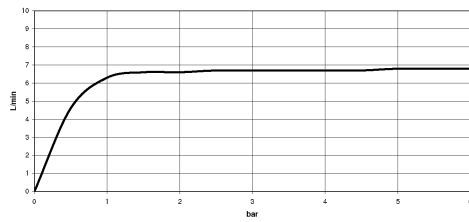

Rain shower for recessed ceiling installation 300 mm - Platinum

28 033 970 Product version from 7/1/2022

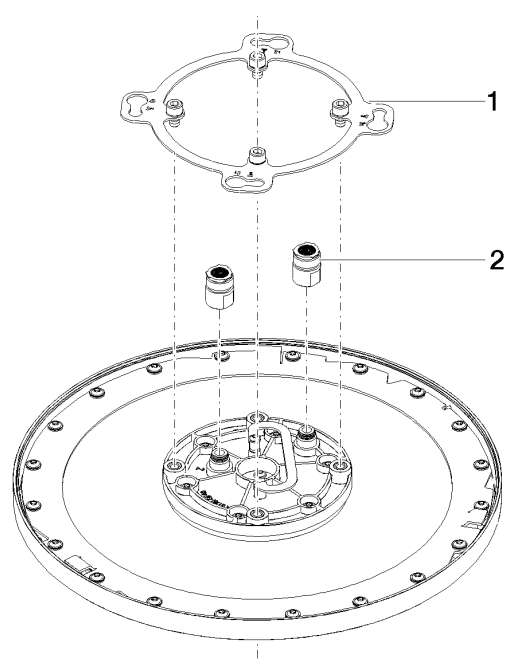

Spare parts list

No.	Item Number	Name	Quantity used	Delivery time
1	90 17 20 262 00 90	flange	1	2
2	90 24 03 309 02 90	connection	1	2