

Metal shower hose 1/2" x 1/2" x 1250 mm - Chrome

SERIES-VARIOUS

28 104 970 Product version from 10/1/2023

• WRAS



| | | |
|---|-------------------------------|---------------|
|  | Chrome | 28 104 970-00 |
|  | Brushed Platinum | 28 104 970-06 |
|  | Platinum | 28 104 970-08 |
|  | Durabrand (23kt Gold) | 28 104 970-09 |
|  | Dark Chrome | 28 104 970-19 |
|  | Light Gold | 28 104 970-26 |
|  | Brushed Light Gold | 28 104 970-27 |
|  | Brushed Durabrand (23kt Gold) | 28 104 970-28 |
|  | Matte Black | 28 104 970-33 |
|  | Brushed Dark Brass | 28 104 970-39 |
|  | Brushed Bronze | 28 104 970-42 |
|  | Brushed Champagne (22kt Gold) | 28 104 970-46 |
|  | Champagne (22kt Gold) | 28 104 970-47 |
|  | Brushed Chrome | 28 104 970-93 |
|  | Brushed Dark Platinum | 28 104 970-99 |



Metal shower hose 1/2" x 1/2" x 1250 mm - Chrome

SERIES-VARIOUS

28 104 970 Product version from 10/1/2023

Codes & Standards

| | |
|---------------------------|--------------------------------|
| Scottish Water Byelaws | UK Water Supply Regulations |
|---------------------------|--------------------------------|

Certificates and sustainability

WRAS_2009

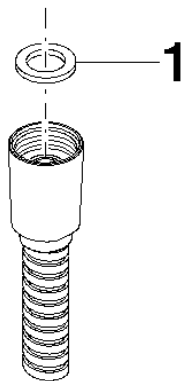

Spare parts list

| No. | Item Number | Name | Quantity used | Delivery time |
|-----|--------------------|------|---------------|---------------|
| 1 | 90 14 20 002 00 90 | seal | 1.00 | 2 |