

## Shower head - Champagne (22kt Gold)

28 504 979 Product version from 7/1/2022



- 180-210mm projection
- ball-joint pivotable through 30°
- PURIFY RAIN, max. flow rate 7 l/min (at 3 bar)
- with anti-scale system
- spray head Ø 100mm
- rosette Ø 55 mm
- 1/2" connection
- This product can help a building meet the requirements of Green Building Rating Systems, e.g. LEED®, BREEAM®, DGNB

|   |                                |                    |
|---|--------------------------------|--------------------|
|    | Champagne (22kt Gold)          | 28 504 979-47 0050 |
|    | Chrome                         | 28 504 979-00 0050 |
|    | Brushed Platinum               | 28 504 979-06 0050 |
|    | Platinum                       | 28 504 979-08 0050 |
|    | Dark Chrome                    | 28 504 979-19 0050 |
|    | Light Gold                     | 28 504 979-26 0050 |
|    | Brushed Light Gold             | 28 504 979-27 0050 |
|    | Brushed Durabronze (23kt Gold) | 28 504 979-28 0050 |
|   | Matte Black                    | 28 504 979-33 0050 |
|  | Brushed Bronze                 | 28 504 979-42 0050 |
|  | Brushed Champagne (22kt Gold)  | 28 504 979-46 0050 |
|  | Brushed Chrome                 | 28 504 979-93 0050 |
|  | Brushed Dark Platinum          | 28 504 979-99 0050 |

### Recommended miscellaneous



#### Concealed wall elbow -

- max. recess depth mm
- min. recess depth mm

35 085 970 90

# Shower head - Champagne (22kt Gold)

28 504 979    Product version from 7/1/2022

mm [inches]

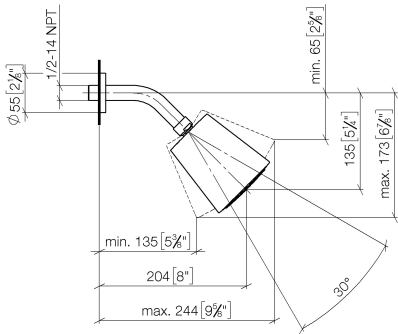

Flow rate chart

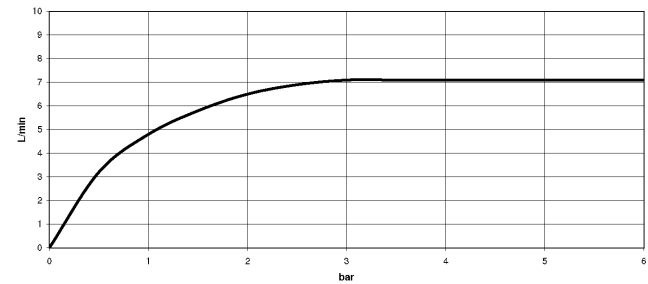

# Shower head - Champagne (22kt Gold)

28 504 979    Product version from 7/1/2022

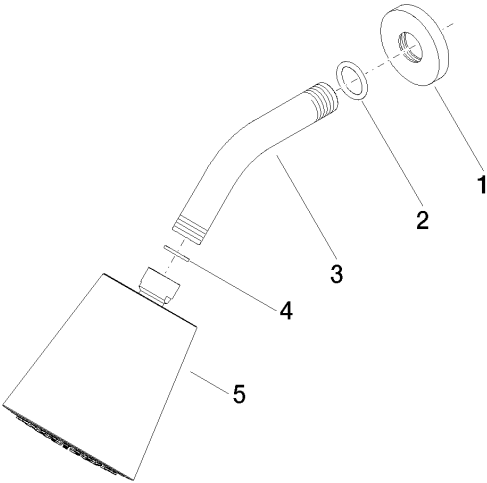

## Spare parts list

| No. | Item Number        | Name       | Quantity used | Delivery time |
|-----|--------------------|------------|---------------|---------------|
| 1   | 09 27 22 503-47    | rosette    | 1             | 30            |
| 2   | 90 14 10 026 00 90 | seal       | 1             | 2             |
| 3   | 09 11 03 011-47    | connection | 1             | 30            |
| 4   | 90 14 20 002 00 90 | seal       | 1             | 2             |
| 5   | 90 12 05 054 00-47 | shower     | 1             | 30            |