

MADISON Shower head - Chrome

MADISON

28 508 360







Product version from 7/1/2022



- spray head Ø 94mm
- Three settings: COMPACT RAIN, COMPACT SOFT FLOW, COMPACT AQUAPRESSURE FLOW, max. flow rate 9 l/min (at 3 bar)
- Function from: l/min
- with anti-scale system

Technical data:

- 200mm projection
- ball-joint pivotable through 30°
- rosette Ø 55 mm
- 1/2" connection

|   |                               |                    |
|---|-------------------------------|--------------------|
|  | Chrome                        | 28 508 360-00 0050 |
|  | Brushed Platinum              | 28 508 360-06 0050 |
|  | Platinum                      | 28 508 360-08 0050 |
|  | Durabrand (23kt Gold)         | 28 508 360-09 0050 |
|  | Brushed Durabrand (23kt Gold) | 28 508 360-28 0050 |
|  | Brushed Dark Brass            | 28 508 360-39 0050 |
|  | Brushed Dark Platinum         | 28 508 360-99 0050 |

Recommended miscellaneous



- Concealed wall elbow -

•min. recess depth 90 mm

•max. recess depth 163 mm

35 085 970 90

mm [inches]

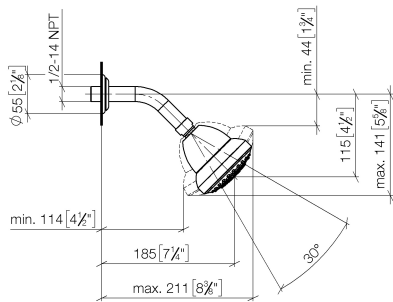

### Flow rate chart





### Spare parts list

| No. | Item Number        | Name       | Quantity used | Delivery time |
|-----|--------------------|------------|---------------|---------------|
| 1   | 09 27 35 003-00    | rosette    | 1.00          | 10            |
| 3   | 09 11 03 011-00    | connection | 1.00          | 10            |
| 4   | 04 12 11 120 00-00 | shower     | 1.00          | 10            |
| 2   | 90 14 10 026 00 90 | seal       | 1.00          | 2             |