

## Rain shower with wall fixing 220 mm - Dark Chrome

SERIES SPECIFIC

28 649 970



- 450mm projection
- rain shower Ø 220 mm
- PURE RAIN, max. flow rate 14 l/min (at 3 bar)
- rosette Ø 60 mm
- 1/2" connection
- with anti-scale system
- quick clearing
- This product can help a building meet the requirements of Green Building Rating Systems, e.g. LEED®, BREEAM®, DGNB

	Dark Chrome	28 649 970-19 0050
	Chrome	28 649 970-00 0050
	Brushed Platinum	28 649 970-06 0050
	Platinum	28 649 970-08 0050
	Light Gold	28 649 970-26 0050
	Brushed Light Gold	28 649 970-27 0050
	Brushed Durabrass (23kt Gold)	28 649 970-28 0050
	Matte Black	28 649 970-33 0050
	Brushed Bronze	28 649 970-42 0050
	Brushed Champagne (22kt Gold)	28 649 970-46 0050
	Champagne (22kt Gold)	28 649 970-47 0050
	Brushed Chrome	28 649 970-93 0050
	Brushed Dark Platinum	28 649 970-99 0050

### Recommended miscellaneous

#### Concealed wall elbow -

35 085 970 90



- max. recess depth 163 mm
- min. recess depth 90 mm

28 649 970

mm [inches]

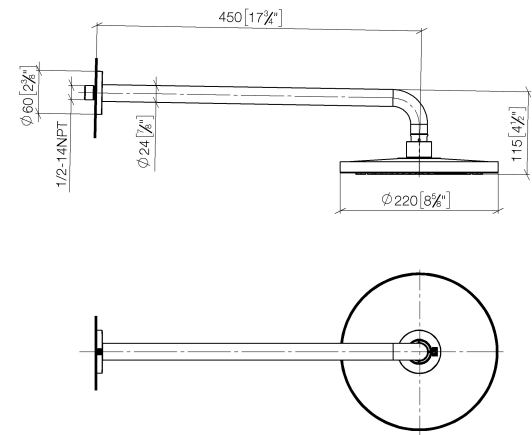

**Flow rate chart**



28 649 970

