









LISSÉ Single-lever bath mixer for wall mounting without shower set - Brushed Platinum

LISSÉ

|   |   |   |                                     |
|---|---|---|-------------------------------------|
| 33 200 845    Product version from 3/9/2016 to 7/16/2018                          |   |   |                                     |
|  | <ul style="list-style-type: none"> <li>• 190-200mm projection</li> <li>• circular normal flow</li> <li>• automatic bath/shower diverter</li> <li>• 3/8" shower outlet</li> <li>• slide-on rosettes Ø 60 mm</li> <li>• 1/2" connection</li> <li>• gauge 150 mm - 15 mm</li> <li>• max. flow 13.5 l/min at 3 bar flow pressure</li> <li>• WRAS</li> </ul> |   |                                     |
|   | Intrinsic protection against back flow.   |   |                                     |
|   |   |  | Brushed Platinum 33 200 845-06      |
|   |   |  | Chrome 33 200 845-00                |
|   |   |  | Dark Chrome 33 200 845-19           |
|   |   |  | Brushed Light Gold 33 200 845-27    |
|   |   |  | Matte Black 33 200 845-33           |
|   |   |  | Brushed Chrome 33 200 845-93        |
|   |   |  | Brushed Dark Platinum 33 200 845-99 |

# LISSÉ Single-lever bath mixer for wall mounting without shower set - Brushed Platinum

LISSÉ

33 200 845 Product version from 3/9/2016 to 7/16/2018  
mm [inches]

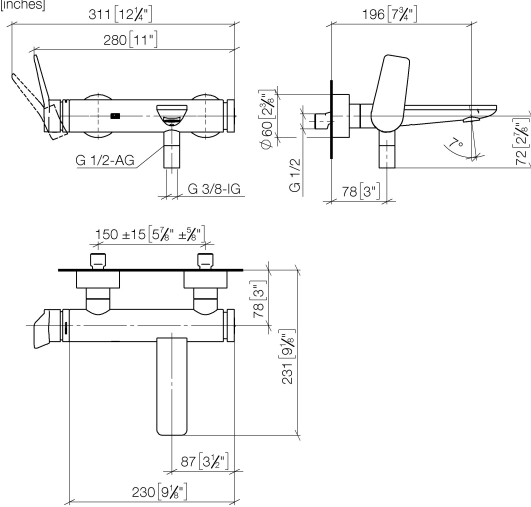

## Flow rate chart

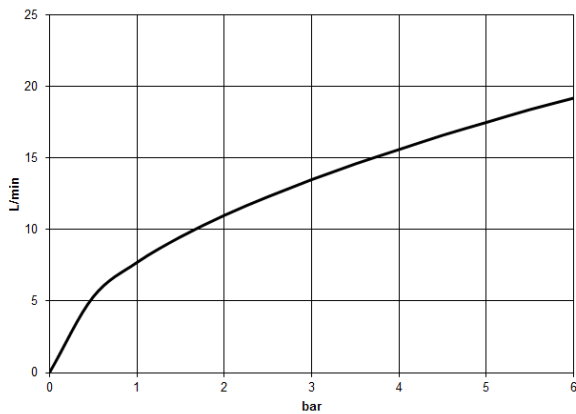

## Codes & Standards

|                |      |          |          |
|----------------|------|----------|----------|
| ASME A112.18.1 | cUPC | DIN 4109 | ISO 3822 |
|----------------|------|----------|----------|

Scottish Water  
Byelaws

UK Water Supply  
Regulations

Ü-Zeichen



LISSE Single-lever bath mixer for wall mounting without shower set - Brushed  
Platinum

LISSE

33 200 845 Product version from 3/9/2016 to 7/16/2018

Certificates and sustainability

LGA\_9 WRAS\_2311 IAPMO\_4976 (

# LISSÉ Single-lever bath mixer for wall mounting without shower set - Brushed Platinum

LISSÉ

33 200 845 Product version from 3/9/2016 to 7/16/2018

Parts for other  
finishes can be found  
here: [Chrome](#)

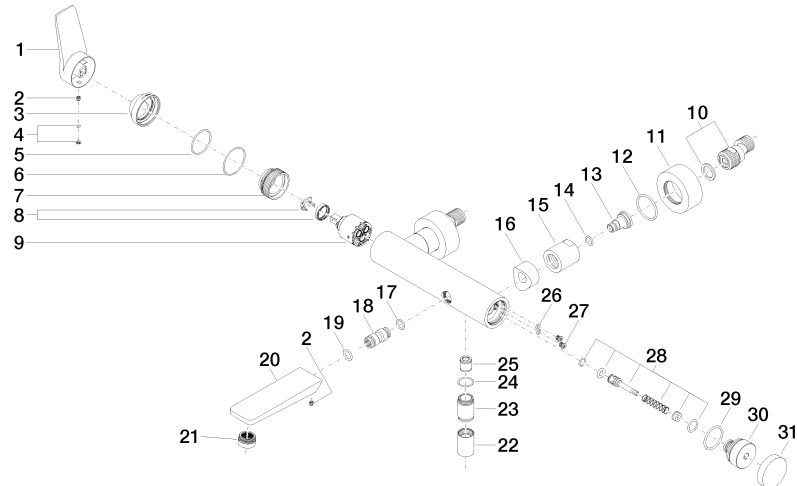



## LISSE Single-lever bath mixer for wall mounting without shower set - Brushed Platinum

LISSE

33 200 845 Product version from 3/9/2016 to 7/16/2018

### Spare parts list

| No. | Item Number        | Name                | Quantity used | Delivery time |
|-----|--------------------|---------------------|---------------|---------------|
| 23  | 09 24 03 115 20-06 | nipple              | 1.00          | 10            |
| 11  | 09 27 62 004-06    | rosette             | 2.00          | 10            |
| 17  | 09 14 10 003 90    | seal                | 1.00          | 2             |
| 20  | 09 11 84 012-06    | spout               | 1.00          | 10            |
| 15  | 09 23 10 048-06    | nut                 | 2.00          | 10            |
| 26  | 09 14 10 001 90    | seal                | 2.00          | 2             |
| 9   | 90 15 05 064 00 90 | cartridge           | 1.00          | 2             |
| 14  | 09 14 10 008 90    | seal                | 2.00          | 2             |
| 12  | 09 14 10 119 90    | seal                | 2.00          | 2             |
| 10  | 04 11 04 030 00 90 | connection          | 2.00          | 2             |
| 30  | 09 21 10 035 20-06 | nipple              | 1.00          | 10            |
| 21  | 90 23 01 161 00-06 | aerator             | 1.00          | 10            |
| 1   | 09 20 84 021-06    | handle              | 1.00          | 10            |
| 5   | 09 14 10 102 90    | seal                | 1.00          | 2             |
| 28  | 90 31 09 032 00-06 | diverter            | 1.00          | 10            |
| 4   | 90 31 20 087 00-06 | plug                | 1.00          | 10            |
| 18  | 09 24 04 043 90    | nipple              | 1.00          | 2             |
| 27  | 09 30 30 113 20 90 | screw               | 2.00          | 2             |
| 3   | 09 28 30 032-06    | cover               | 1.00          | 10            |
| 31  | 09 20 62 031-06    | handle              | 1.00          | 10            |
| 7   | 09 24 04 296 90    | nut                 | 1.00          | 2             |
| 16  | 09 18 40 059-06    | sleeve              | 2.00          | 10            |
| 6   | 09 14 10 190 90    | seal                | 1.00          | 2             |
| 29  | 09 14 10 101 90    | seal                | 1.00          | 2             |
| 19  | 90 14 10 011 00 90 | seal                | 1.00          | 2             |
| 2   | 90 31 11 030 00 90 | pin                 | 2.00          | 2             |
| 8   | 90 28 10 148 00 90 | accessories         | 1.00          | 2             |
| 22  | 90 21 02 069 00-06 | cover               | 1.00          | 10            |
| 24  | 90 14 10 032 00 90 | seal                | 1.00          | 2             |
| 25  | 90 23 01 141 00 90 | back-flow preventer | 1.00          | 2             |
| 13  | 09 29 05 005 20 90 | nipple              | 2.00          | 60            |