

**Concealed thermostat with three function volume control - Champagne (22kt Gold)**

36 427 670 Product version from 6/30/2022



- rotary diverter with volume control and shut-off function
- cover plate 150 x 90 mm
- temperature control handle with safety limit stop at 38°C
- hot water temperature limiter, can be preset
- WRAS

	Champagne (22kt Gold)	36 427 670-47
	Chrome	36 427 670-00
	Brushed Platinum	36 427 670-06
	Platinum	36 427 670-08
	Dark Chrome	36 427 670-19
	Brushed Light Gold	36 427 670-27
	Brushed Durabronze (23kt Gold)	36 427 670-28
	Matte Black	36 427 670-33
	Brushed Champagne (22kt Gold)	36 427 670-46
	Brushed Chrome	36 427 670-93
	Brushed Dark Platinum	36 427 670-99

**Required miscellaneous**



**Concealed thermostat with built-in isolators -** 35 428 970 90  
 • max. recess depth mm  
 • min. recess depth mm

**Recommended miscellaneous**



**xGRID Attachment set for integrating in the dry wall construction -** 12 340 970 90

**Required miscellaneous**



**Concealed thermostat -** 35 427 970 90  
 • max. recess depth mm  
 • min. recess depth mm

**Required miscellaneous**



**xGRID Installation track 555 mm -** 12 360 970 90

**Concealed thermostat with three function volume control - Champagne (22kt Gold)**

36 427 670    Product version from 6/30/2022  
mm [inches]

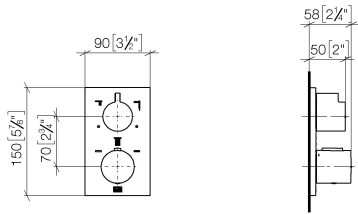

Flow rate chart

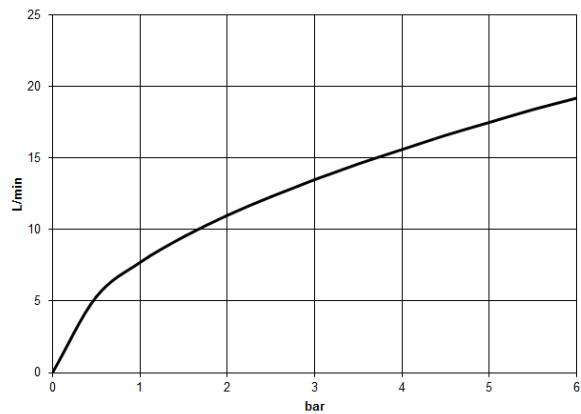

Codes & Standards

DIN 4109	EN 1111	ISO 3822	Scottish Water Byelaws
UK Water Supply Regulations	Ü-Zeichen		



Concealed thermostat with three function volume control - Champagne (22kt Gold)

---

36 427 670 Product version from 6/30/2022

Certificates

---

LGA_29	DVGW_DW- 6512DN0	WRAS_1906
--------	---------------------	-----------

Concealed thermostat with three function volume control - Champagne (22kt Gold)

36 427 670 Product version from 6/30/2022

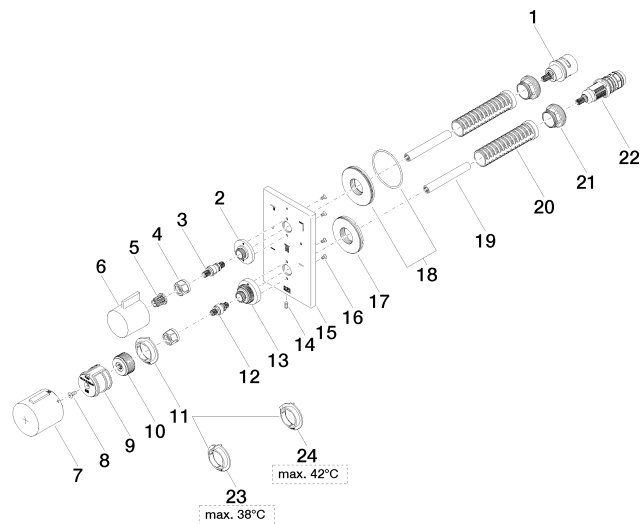



## Concealed thermostat with three function volume control - Champagne (22kt Gold)

36 427 670 Product version from 6/30/2022

### Spare parts list

No.	Item Number	Name	Quantity used	Delivery time
1	90 90 03 170 00 90	diverter	1	2
2	09 12 12 053-47	base	1	30
3	04 29 06 111 01-00	spindle	1	10
4	90 23 30 023 00 90	nut	2	2
5	90 12 12 002 00 90	fixing cap	1	2
6	09 20 67 006-47	handle	1	30
7	90 17 33 017 00-47	handle	1	30
8	90 30 30 124 00 90	screw	1	2
9	90 12 12 052 00 90	base	1	2
10	09 12 12 054 90	base	1	2
11	09 28 10 187 90	regulator	1	2
12	04 29 06 024 01-00	spindle	1	10
13	09 12 12 051-47	base	1	30
14	09 31 11 134 90	pin	1	2
15	09 11 02 322-47	plate	1	60
16	09 30 30 157 90	screw	4	2
17	09 30 01 296 90	disc	1	2
18	90 30 01 190 00 90	disc	1	2
19	90 23 01 124 00 90	sleeve	2	2
20	90 18 40 077 01 90	spindle	2	2
21	09 24 04 257 90	nut	2	2
22	90 15 02 013 00 90	cartridge	1	2
23	09 28 10 188 90	regulator	1	2
24	09 28 10 189 90	regulator	1	2