



CL.1 Wall valve clockwise closing 1/2" - Brushed Platinum

CL.1

36 627 705



- with CASCADE structure
- rosette 60 x 60 mm
- without marking
- head part with cut-to-length spindle and sleeve
- WRAS 2011026, 2010066

	Brushed Platinum	36 627 705-06
	Chrome	36 627 705-00
	Dark Chrome	36 627 705-19
	Brushed Champagne (22kt Gold)	36 627 705-46
	Champagne (22kt Gold)	36 627 705-47
	Brushed Dark Platinum	36 627 705-99

Required miscellaneous



- Wall valve 1/2" -**

35 607 970 90
- max. recess depth 150 mm
 - min. recess depth 105 mm

CL.1 Wall valve clockwise closing 1/2" - Brushed Platinum

CL.1

36 627 705

mm [inches]



Codes & Standards

ASME A112.18.1	cUPC	DIN 4109	EN 1111
EN 200	ISO 3822	Scottish Water Byelaws	UK Water Supply Regulations

Ü-Zeichen

Certificates

IAPMO_4976	DVGW_DW-6501DN0	WRAS_2010	LGA_29	LGA_29
DVGW_DW-6512DN0	WRAS_2011			

36 627 705

Product version up to 10/14/2020

Product version from 10/14/2020

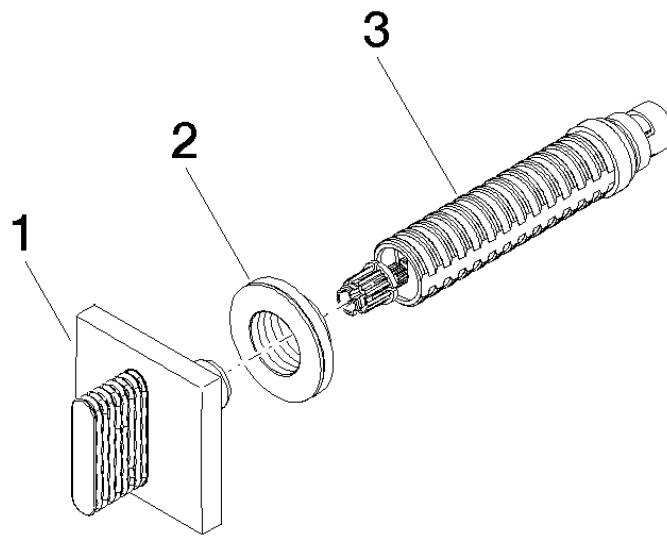



CL.1 Wall valve clockwise closing 1/2" - Brushed Platinum

CL.1

36 627 705

Spare parts list

Product version up to 10/14/2020

Product version from 10/14/2020

No.	Item Number	Name	Quantity used	Delivery time
	90 20 70 053 01-06	handle	3	10