

CL.1 Five-hole bath mixer for deck mounting with diverter - Brushed Dark Platinum

CL.1

ST 030 100 1705



- 200mm projection
 - rectangular spray pattern with 55 individual jets
 - Hand shower: COMPACT RAIN, max. flow rate 6.8 l/min (at 3 bar)
 - height of mixer 125 mm
 - height up to aerator 108 mm
 - 1/2" connection
 - complete hand shower set with anti-scale system
 - hole diameter spout 35 mm
 - hole diameter valve 32 mm
 - rosette for complete hand shower set 60 x 60mm
 - rosette for deck valve 60 x 60mm
 - metal shower hose 2250mm with integrated anti-twist protection
- Intrinsic protection against back flow.**

Individual components of this set

You need the following components for this set

1x 13 612 705-99



1x 20 000 706-99



1x 29 126 705-99



1x 20 000 705-99



1x 27 702 980-99









CL.1 Five-hole bath mixer for deck mounting with diverter - Brushed Dark Platinum

CL.1

ST 030 100 1705

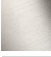

- 200mm projection
- rectangular spray pattern with 55 individual jets
- height of mixer 125 mm
- height up to aerator 108 mm
- hole diameter 35 mm
- 1/2" connection
- max. flow 24.6 l/min at 3 bar flow pressure
- WRAS 1512010

	Brushed Dark Platinum	13 612 705-9
	Chrome	13 612 705-0
	Brushed Platinum	13 612 705-0
	Dark Chrome	13 612 705-1
	Brushed Champagne (22kt Gold)	13 612 705-4
	Champagne (22kt Gold)	13 612 705-4

CL.1 Five-hole bath mixer for deck mounting with diverter - Brushed Dark
Platinum

CL.1

ST 030 100 1705

19
—
10
—
16
—
9
—
6
—
7
—

CL.1 Five-hole bath mixer for deck mounting with diverter - Brushed Dark Platinum

CL.1

ST 030 100 1705
mm [inches]

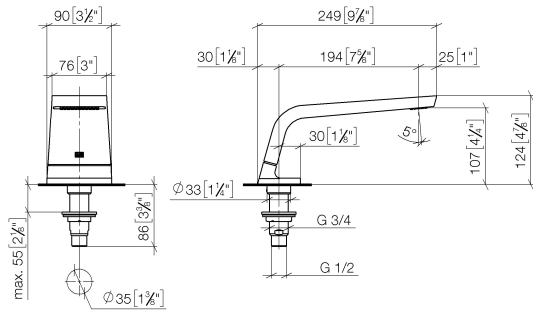

Flow rate chart

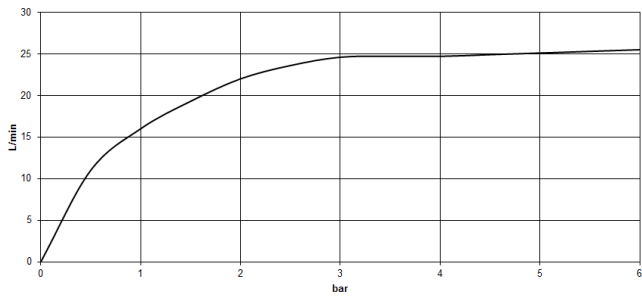

Certificates

IAPMO_4976

LGA_28

WRAS_1512



CL.1 Five-hole bath mixer for deck mounting with diverter - Brushed Dark Platinum

CL.1

ST 030 100 1705

Codes & Standards

ASME A112.18.1	cUPC	DIN 4109	ISO 3822
Scottish Water Byelaws	UK Water Supply Regulations	Ü-Zeichen	



CL.1 Five-hole bath mixer for deck mounting with diverter - Brushed Dark Platinum

CL.1

ST 030 100 1705

CL.1 Five-hole bath mixer for deck mounting with diverter - Brushed Dark Platinum

CL.1

ST 030 100 1705

Product version from 3/9/2015 to 5/27/2021

Product version from 5/27/2021

Parts for other
finishes can be found
here: [Chrome](#)

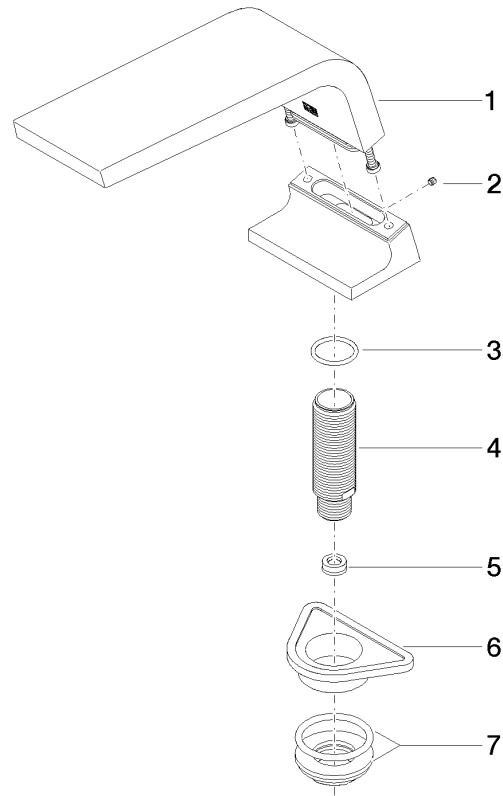



CL.1 Five-hole bath mixer for deck mounting with diverter - Brushed Dark Platinum

CL.1

ST 030 100 1705

Spare parts list

Product version from 3/9/2015 to 5/27/2021

Product version from 5/27/2021

No.	Item Number	Name	Quantity used	Delivery time
	90 11 70 007 00-99	spout	7	-

Spare part can no longer be ordered, please order the replacement item







CL.1 Five-hole bath mixer for deck mounting with diverter - Brushed Dark
Platinum

CL.1

ST 030 100 1705

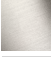

- hole diameter valve 32 mm
- rosette 60 x 60 mm
- with cold marking
- WRAS 2103001

	Brushed Dark Platinum	20 000 705-9
	Chrome	20 000 705-0
	Brushed Platinum	20 000 705-0
	Dark Chrome	20 000 705-1
	Brushed Champagne (22kt Gold)	20 000 705-4
	Champagne (22kt Gold)	20 000 705-4



CL.1 Five-hole bath mixer for deck mounting with diverter - Brushed Dark
Platinum

CL.1

ST 030 100 1705

19
—
10
—
16
—
9
—
6
—
7
—

CL.1 Five-hole bath mixer for deck mounting with diverter - Brushed Dark Platinum

CL.1

ST 030 100 1705
mm [inches]

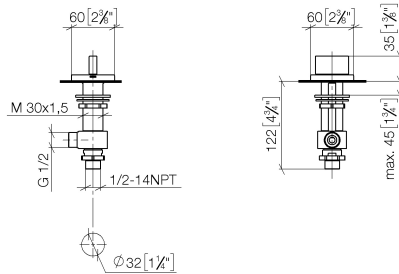

Flow rate chart

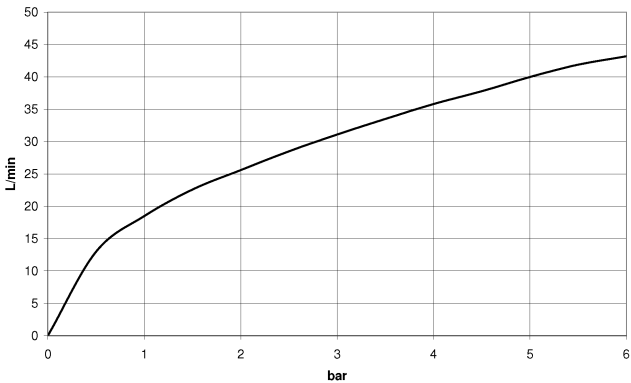

Certificates

IAPMO_4976 WRAS_2103 LGA_28



CL.1 Five-hole bath mixer for deck mounting with diverter - Brushed Dark Platinum

CL.1

ST 030 100 1705

Codes & Standards

ASME A112.18.1	cUPC	DIN 4109	ISO 3822
Scottish Water Byelaws	UK Water Supply Regulations	Ü-Zeichen	

CL.1 Five-hole bath mixer for deck mounting with diverter - Brushed Dark
Platinum

CL.1

ST 030 100 1705

ST 030 100 1705

Product version from 3/9/2015

Parts for other
finishes can be found
here: [Chrome](#)

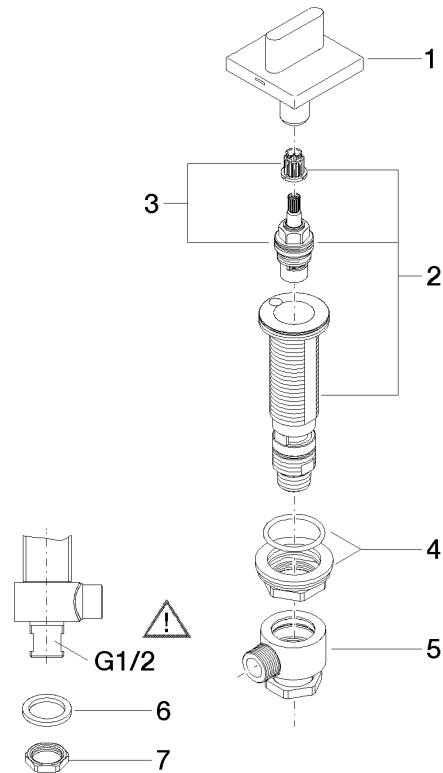



CL.1 Five-hole bath mixer for deck mounting with diverter - Brushed Dark Platinum

CL.1

ST 030 100 1705

Spare parts list

Product version from 3/9/2015

No.	Item Number	Name	Quantity used	Delivery time
	90 20 70 051 04-99	handle (cold)	8	30







CL.1 Five-hole bath mixer for deck mounting with diverter - Brushed Dark
Platinum

CL.1

ST 030 100 1705

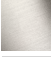

- hole diameter valve 32 mm
- rosette 60 x 60 mm
- with hot marking
- WRAS 2103001

	Brushed Dark Platinum	20 000 706-9
	Chrome	20 000 706-0
	Brushed Platinum	20 000 706-0
	Dark Chrome	20 000 706-1
	Brushed Champagne (22kt Gold)	20 000 706-4
	Champagne (22kt Gold)	20 000 706-4

CL.1 Five-hole bath mixer for deck mounting with diverter - Brushed Dark
Platinum

CL.1

ST 030 100 1705

19
—
10
—
16
—
9
—
6
—
7
—

CL.1 Five-hole bath mixer for deck mounting with diverter - Brushed Dark Platinum

CL.1

ST 030 100 1705
mm [inches]

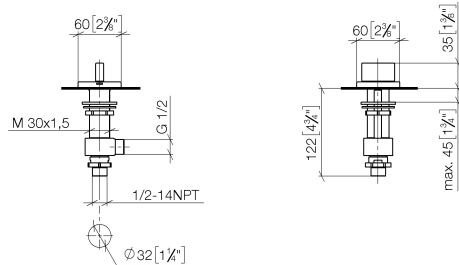

Flow rate chart

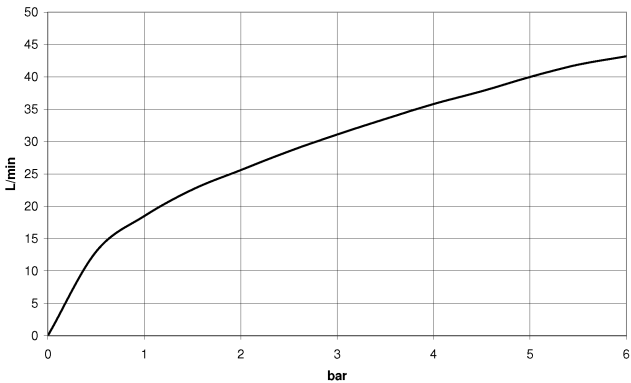

Certificates

IAPMO_4976

WRAS_2103

LGA_28



CL.1 Five-hole bath mixer for deck mounting with diverter - Brushed Dark Platinum

CL.1

ST 030 100 1705

Codes & Standards

ASME A112.18.1	cUPC	DIN 4109	ISO 3822
Scottish Water Byelaws	UK Water Supply Regulations	Ü-Zeichen	

CL.1 Five-hole bath mixer for deck mounting with diverter - Brushed Dark
Platinum

CL.1

ST 030 100 1705

ST 030 100 1705

Product version from 3/9/2015

Parts for other
finishes can be found
here: [Chrome](#)

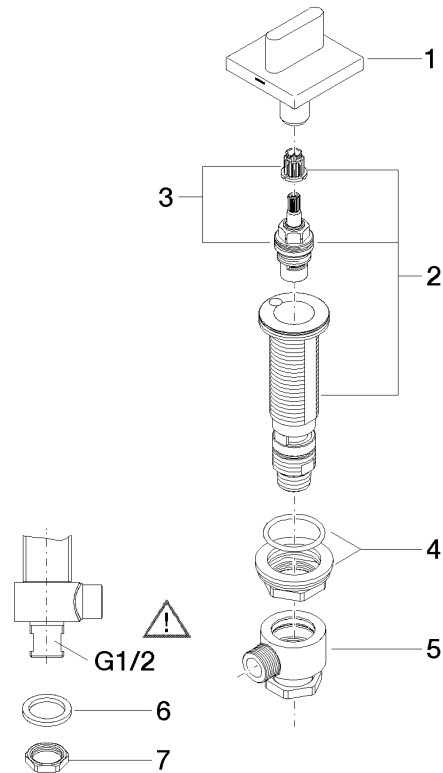



CL.1 Five-hole bath mixer for deck mounting with diverter - Brushed Dark Platinum

CL.1

ST 030 100 1705

Spare parts list				
Product version from 3/9/2015				
No.	Item Number	Name	Quantity used	Delivery time
	90 20 70 051 05-99	handle (hot)	8	30

CL.1 Five-hole bath mixer for deck mounting with diverter - Brushed Dark Platinum

CL.1

ST 030 100 1705



Fits: IMO, MEM, CL.1, CYO

CL.1 Five-hole bath mixer for deck mounting with diverter - Brushed Dark
Platinum

CL.1

ST 030 100 1705

CL.1 Five-hole bath mixer for deck mounting with diverter - Brushed Dark
Platinum

CL.1

ST 030 100 1705

CL.1 Five-hole bath mixer for deck mounting with diverter - Brushed Dark
Platinum

CL.1

ST 030 100 1705

CL.1 Five-hole bath mixer for deck mounting with diverter - Brushed Dark
Platinum

CL.1

ST 030 100 1705
mm [inches]

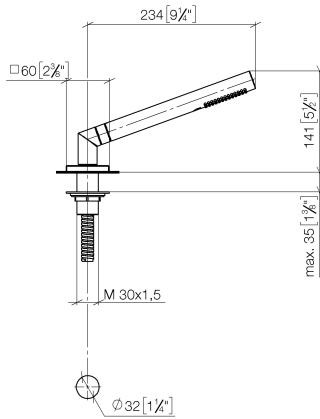

Flow rate chart

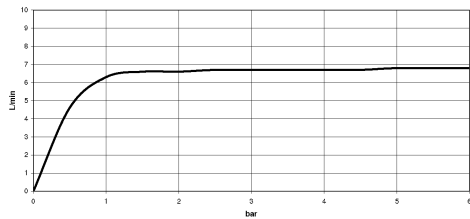

Certificates

IAPMO_4976 Belgaqua_21-383-2 WRAS_2209

CL.1 Five-hole bath mixer for deck mounting with diverter - Brushed Dark
Platinum

CL.1

ST 030 100 1705

CL.1 Five-hole bath mixer for deck mounting with diverter - Brushed Dark Platinum

CL.1

ST 030 100 1705

Product version up to 5/15/2020

Product version from 5/15/2020

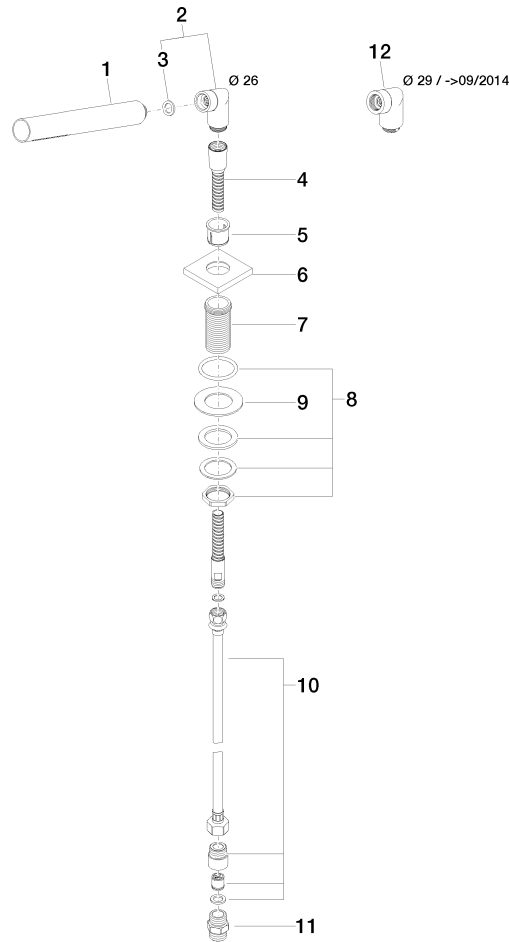



CL.1 Five-hole bath mixer for deck mounting with diverter - Brushed Dark Platinum

CL.1

ST 030 100 1705

Spare parts list

Product version up to 5/15/2020

Product version from 5/15/2020

No.	Item Number	Name	Quantity used	Delivery time
	90 12 11 140 30-99	shower	12	30

CL.1 Five-hole bath mixer for deck mounting with diverter - Brushed Dark Platinum

CL.1

ST 030 100 1705



- rotary diverter
 - hole diameter 37 mm
 - rosette 60 x 60 mm
 - 1/2" connection
 - max. flow 23.5 l/min at 3 bar flow pressure
- Not suitable for combining with Perfecto (12 614 970 90).**

Not suitable for combining with Perfecto (12 614 970 90).

CL.1 Five-hole bath mixer for deck mounting with diverter - Brushed Dark
Platinum

CL.1

ST 030 100 1705

Required miscellaneous

	Hose set -	12 509 970 90
---	------------	---------------

CL.1 Five-hole bath mixer for deck mounting with diverter - Brushed Dark Platinum

CL.1

ST 030 100 1705
mm [inches]

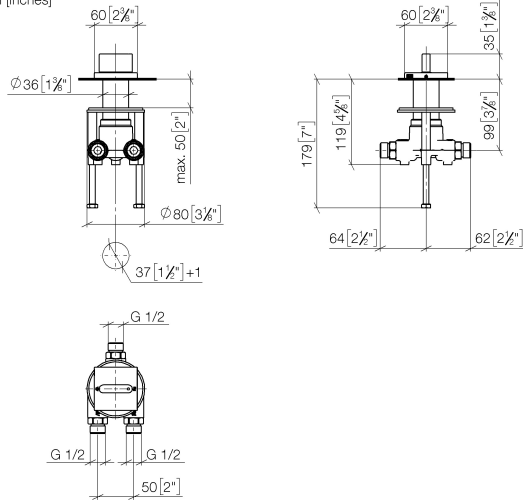

Flow rate chart

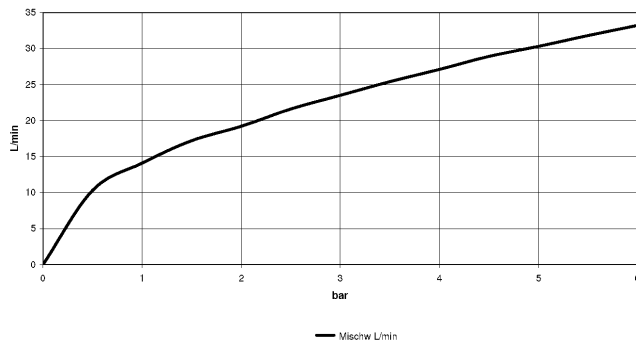

Certificates

IAPMO_4976

LGA_18

Codes & Standards

ASME A112.18.1	cUPC	DIN 4109	ISO 3822
----------------	------	----------	----------

Ü-Zeichen

CL.1 Five-hole bath mixer for deck mounting with diverter - Brushed Dark
Platinum

CL.1

ST 030 100 1705

ST 030 100 1705

Product version from 3/9/2015

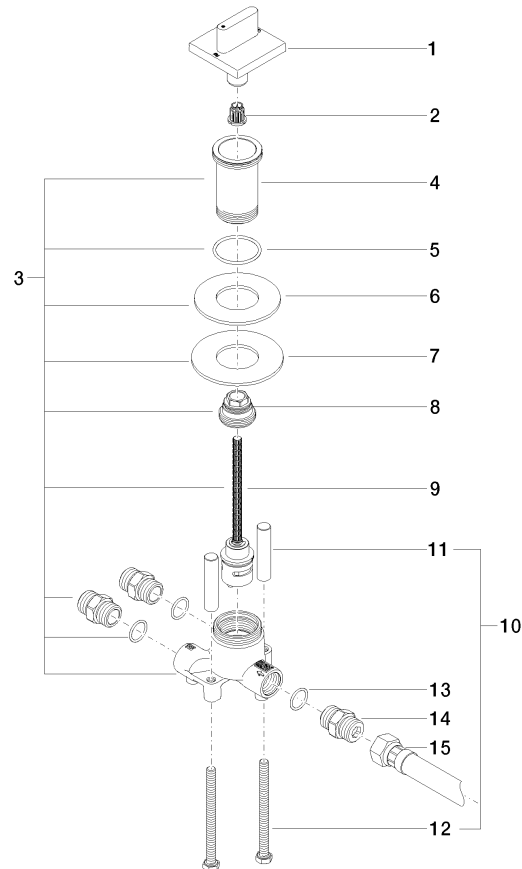



CL.1 Five-hole bath mixer for deck mounting with diverter - Brushed Dark Platinum

CL.1

ST 030 100 1705

Spare parts list

Product version from 3/9/2015

No.	Item Number	Name	Quantity used	Delivery time
	90 20 70 052 01-99	handle	21	30