









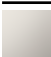

VAIA Two-hole bridge mixer with rinsing spray set - Brushed Chrome

VAIA

ST 110 202 1809



- 241mm projection
- pivotable spout 360°
- air-enriched flow and spray flow
- fabric braided hose 1500 mm
- automatic spout/shower diverter
- sprayface with anti-scaling system
- max. flow 7 l/min at 3 bar flow pressure
- lead-free
- This product can help a building meet the requirements of Green Building Rating Systems, e.g. LEED®, BREEAM®, DGNB

	Brushed Chrome	ST 110 202 1809-93
	Chrome	ST 110 202 1809-00
	Brushed Platinum	ST 110 202 1809-06
	Platinum	ST 110 202 1809-08
	Durabrass (23kt Gold)	ST 110 202 1809-09
	Dark Chrome	ST 110 202 1809-19
	Brushed Durabrass (23kt Gold)	ST 110 202 1809-28
	Matte Black	ST 110 202 1809-33
	Brushed Champagne (22kt Gold)	ST 110 202 1809-46
	Champagne (22kt Gold)	ST 110 202 1809-47
	Brushed Dark Platinum	ST 110 202 1809-99

Individual components of this set

You need the following components for this set



1x 19 815 809-93



1x 27 718 809-93









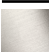

# VAIA Two-hole bridge mixer with rinsing spray set - Brushed Chrome

VAIA

ST 110 202 1809



- 241mm projection
- pivotable spout 360°
- air-enriched flow
- max. flow 7 l/min at 3 bar flow pressure
- lead-free
- This product can help a building meet the requirements of Green Building Rating Systems, e.g. LEED®, BREEAM®, DGNB

	Brushed Chrome	19 815 809-9
	Chrome	19 815 809-0
	Brushed Platinum	19 815 809-0
	Platinum	19 815 809-0
	Durabrand (23kt Gold)	19 815 809-0
	Dark Chrome	19 815 809-1
	Brushed Durabrand (23kt Gold)	19 815 809-2
	Matte Black	19 815 809-3
	Brushed Champagne (22kt Gold)	19 815 809-4
	Champagne (22kt Gold)	19 815 809-4
	Brushed Dark Platinum	19 815 809-9

ST 110 202 1809

3  
—  
0  
—  
6  
—  
8  
—  
9  
—  
9  
—  
8  
—  
3  
—  
6  
—  
7  
—  
9  
—

Recommended miscellaneous

**VAIA Dispenser with rosette -** 82 434 809-93  
**Brushed Chrome**



ST 110 202 1809

mm [inches]  
1:5

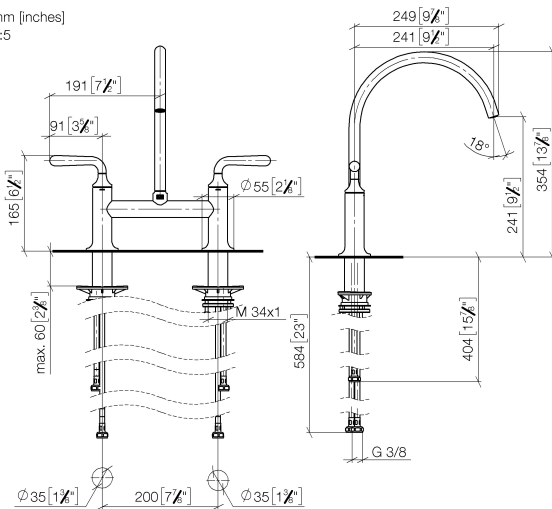

### Flow rate chart

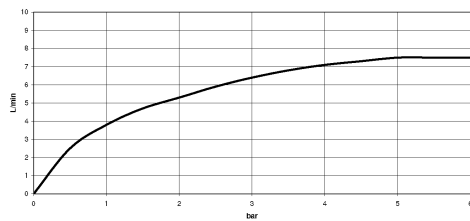

### Certificates

LGA\_38



VAIA Two-hole bridge mixer with rinsing spray set - Brushed Chrome

VAIA

ST 110 202 1809

Codes & Standards

DIN 4109	ISO 3822	Ü-Zeichen
----------	----------	-----------



**Product version from 7/1/2023**

Parts for other  
finishes can be found  
here: [Chrome](#)

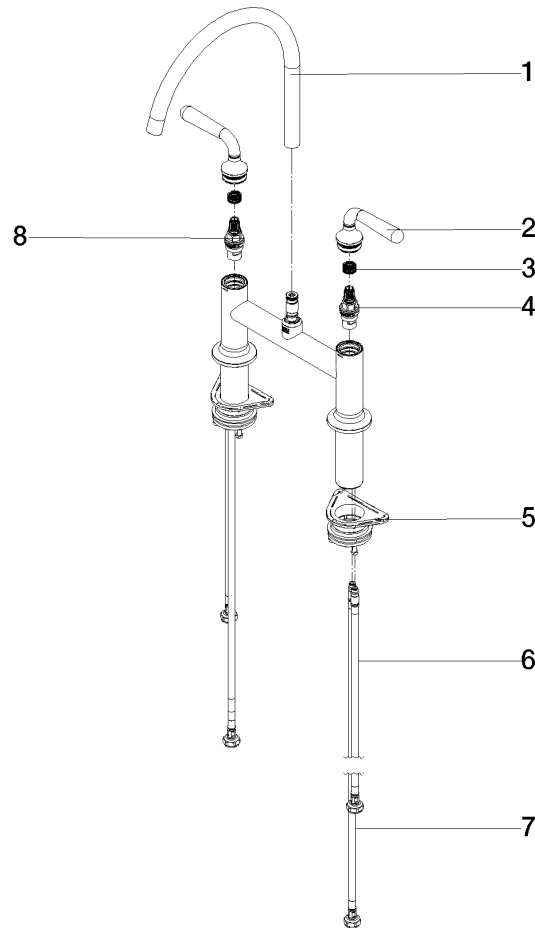



VAIA Two-hole bridge mixer with rinsing spray set - Brushed Chrome

VAIA

ST 110 202 1809

**Spare parts list**

**Product version from 7/1/2023**

No.	Item Number	Name	Quantity used	Delivery time
	90 28 22 396 00-93	spout	13	60



## VAIA Two-hole bridge mixer with rinsing spray set - Brushed Chrome

VAIA

ST 110 202 1809



- with round rosette
- spray flow
- automatic spout/shower diverter
- height of mixer 171 mm
- hole diameter rinsing spray 32mm
- fabric braided hose 1500 mm
- sprayface with anti-scaling system
- lead-free
- This product can help a building meet the requirements of Green Building Rating Systems, e.g. LEED®, BREEAM®, DGNB

Can only be combined with 33810809, 33826809, 19815809, 19825809.

Intrinsic protection against back flow.

Residual water may emerge from the spray after closing.

Operating unit can be positioned freely.

	Brushed Chrome	27 718 809-9
	Chrome	27 718 809-0
	Brushed Platinum	27 718 809-0
	Platinum	27 718 809-0
	Durabrand (23kt Gold)	27 718 809-0
	Dark Chrome	27 718 809-1
	Brushed Durabrand (23kt Gold)	27 718 809-2
	Matte Black	27 718 809-3
	Brushed Champagne (22kt Gold)	27 718 809-4
	Champagne (22kt Gold)	27 718 809-4
	Brushed Dark Platinum	27 718 809-9



VAIA Two-hole bridge mixer with rinsing spray set - Brushed Chrome

VAIA

ST 110 202 1809

3  
—  
0  
—  
6  
—  
8  
—  
9  
—  
9  
—  
8  
—  
3  
—  
6  
—  
7  
—  
9  
—

ST 110 202 1809

mm [inches]

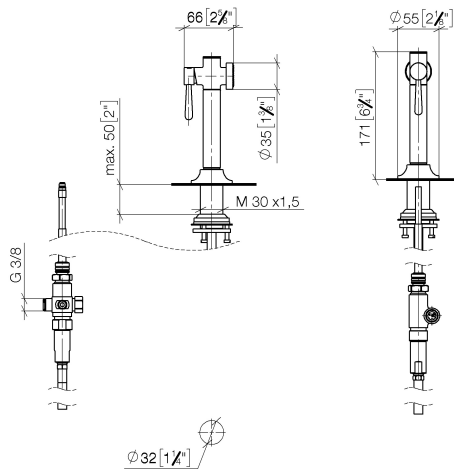

### Flow rate chart

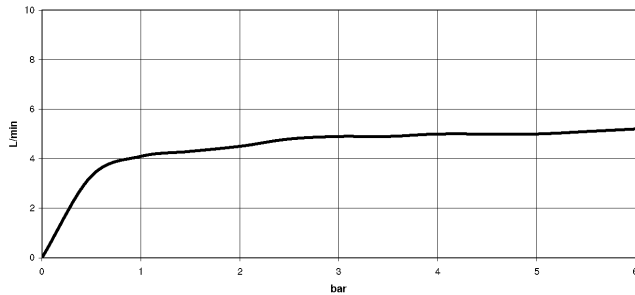

### Certificates

LGA\_38



VAIA Two-hole bridge mixer with rinsing spray set - Brushed Chrome

VAIA

ST 110 202 1809

Codes & Standards

DIN 4109

ISO 3822

Ü-Zeichen



**Product version from 7/1/2023**

Parts for other  
finishes can be found  
here: [Chrome](#)

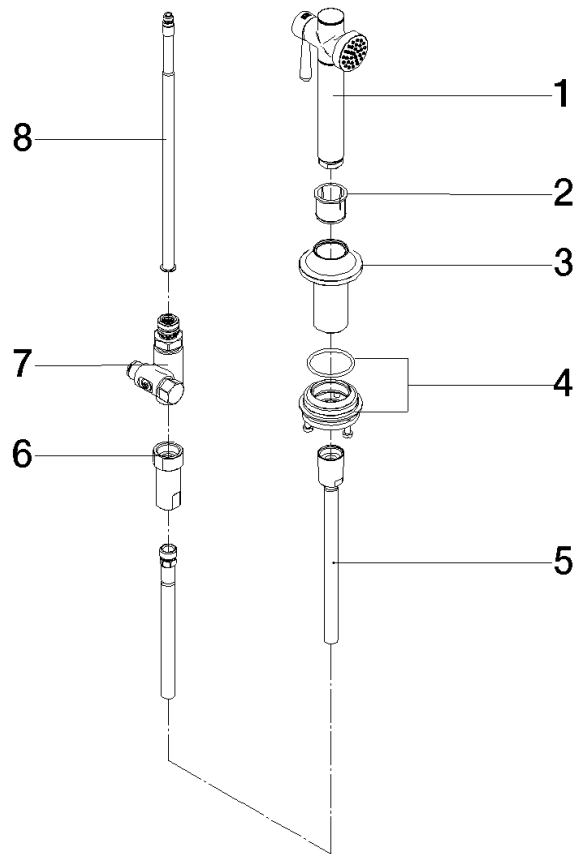



VAIA Two-hole bridge mixer with rinsing spray set - Brushed Chrome

VAIA

ST 110 202 1809

**Spare parts list**

**Product version from 7/1/2023**

No.	Item Number	Name	Quantity used	Delivery time
	90 12 11 096 12-93	shower	8	60