

META Bath spout for wall mounting - Dark Chrome

META

13 801 660



- 200mm projection
- circular normal flow
- rosette Ø 60 mm
- hole diameter 37 mm
- 1/2" connection
- max. flow 24.6 l/min at 3 bar flow pressure
- WRAS

| | | |
|---|-------------------------------|---------------|
|  | Dark Chrome | 13 801 660-19 |
|  | Chrome | 13 801 660-00 |
|  | Brushed Platinum | 13 801 660-06 |
|  | Light Gold | 13 801 660-26 |
|  | Brushed Light Gold | 13 801 660-27 |
|  | Matte Black | 13 801 660-33 |
|  | Brushed Dark Brass | 13 801 660-39 |
|  | Brushed Bronze | 13 801 660-42 |
|  | Brushed Champagne (22kt Gold) | 13 801 660-46 |
|  | Champagne (22kt Gold) | 13 801 660-47 |
|  | Brushed Chrome | 13 801 660-93 |
|  | Brushed Dark Platinum | 13 801 660-99 |

13 801 660

mm [inches]

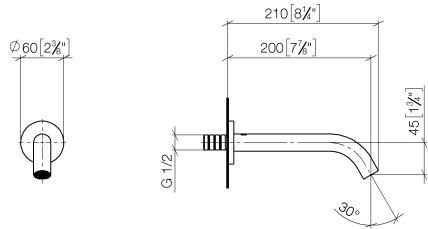

Flow rate chart

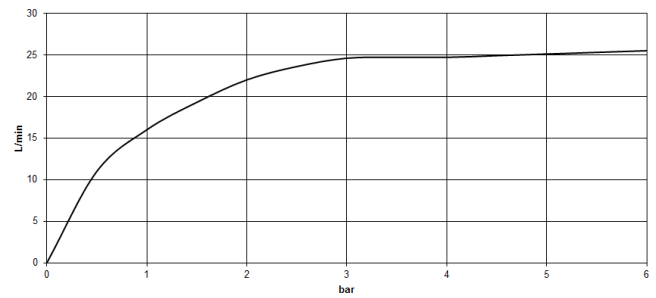

Codes & Standards

| | | | |
|----------------|------|---------------------------|--------------------------------|
| ASME A112.18.1 | cUPC | Scottish Water Byelaws | UK Water Supply Regulations |
|----------------|------|---------------------------|--------------------------------|



META Bath spout for wall mounting - Dark Chrome

META

13 801 660

Certificates and sustainability

IAPMO_4976

WRAS_250402

META Bath spout for wall mounting - Dark Chrome

META

13 801 660

Parts for other
finishes can be found
here: [Chrome](#)

