

## VAIA Two-hole bridge mixer for rinsing/Profi spray - Chrome

VAIA

19 825 809 Product version from 7/1/2023



- 241mm projection
- pivotable spout 360°
- air-enriched flow
- max. flow 7 l/min at 3 bar flow pressure
- lead-free
- This product can help a building meet the requirements of Green Building Rating Systems, e.g. LEED®, BREEAM®, DGNB

Two-hole mixer for combining with rinsing/Profi spray only

|   |                                |               |
|---|--------------------------------|---------------|
|    | Chrome                         | 19 825 809-00 |
|    | Brushed Platinum               | 19 825 809-06 |
|    | Platinum                       | 19 825 809-08 |
|    | Durabronze (23kt Gold)         | 19 825 809-09 |
|    | Dark Chrome                    | 19 825 809-19 |
|    | Brushed Durabronze (23kt Gold) | 19 825 809-28 |
|    | Matte Black                    | 19 825 809-33 |
|    | Brushed Bronze                 | 19 825 809-42 |
|    | Brushed Champagne (22kt Gold)  | 19 825 809-46 |
|   | Champagne (22kt Gold)          | 19 825 809-47 |
|  | Brushed Chrome                 | 19 825 809-93 |
|  | Brushed Dark Platinum          | 19 825 809-99 |

### Recommended miscellaneous

**VAIA Dispenser with rosette - Chrome**

82 434 809-00



19 825 809 Product version from 7/1/2023



Flow rate chart



## Codes & Standards

DIN 4109

ISO 3822

Ü-Zeichen



## VAIA Two-hole bridge mixer for rinsing/Profi spray - Chrome

---

VAIA

19 825 809 Product version from 7/1/2023

Certificates and sustainability

---

LGA\_38

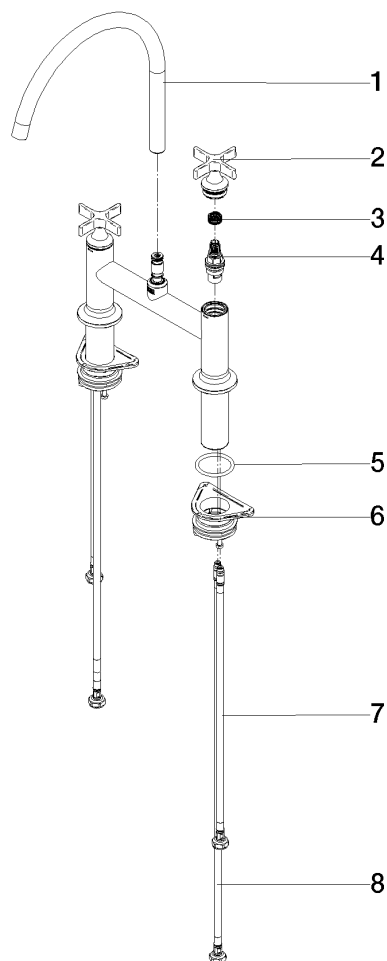

## Spare parts list

| No. | Item Number        | Name       | Quantity used | Delivery time |
|-----|--------------------|------------|---------------|---------------|
| 4   | 90 90 03 131 00 90 | top        | 2.00          | 2             |
| 1   | 90 28 22 396 00-00 | spout      | 1.00          | 10            |
| 3   | 90 12 12 232 00 90 | fixing cap | 2.00          | 2             |
| 2   | 90 20 80 036 00-00 | handle     | 2.00          | 10            |
| 7   | 04 30 04 100 00 90 | hose       | 2.00          | 2             |
| 8   | 04 30 04 101 00 90 | hose       | 2.00          | 2             |
| 5   | 90 14 10 043 00 90 | seal       | 2.00          | 2             |
| 6   | 04 30 11 040 00 90 | fixing set | 2.00          | 2             |