

MADISON Showerpipe with shower mixer without hand shower - Brushed Durabron (23kt Gold)

MADISON

26 632 360 Product version from 7/1/2022



Rain shower:

- rain shower Ø 200 mm
- overhead shower: rain flow
- max. rainshower flow 7 l/min
- Function from: l/min

hand shower:

Control element:

- rotary diverter for fixed-riser shower/hand shower
- metal shower hose 1250mm with integrated anti-twist protection

Technical data:





- shower with fixed riser projection 420mm
- height of fittings up to rain shower (bottom edge) 1009mm
- height of fittings up to top edge of elbow 1180mm
- rosette for wall mounting Ø 70mm
- rosette for shower mixer Ø 60mm
- rosette for shower holder Ø 66mm
- Pipe diameter 20 mm
- gauge 150 mm - 13 mm
- 1/2" connection

Notes:

- This product can help a building meet the requirements of Green Building Rating Systems, e.g. LEED®, BREEAM®, DGNB

This article does not include a hand shower!

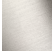
Intrinsic protection against back flow.

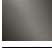
	Brushed Durabron (23kt Gold)	26 632 360-28 0050
	Chrome	26 632 360-00 0050
	Brushed Platinum	26 632 360-06 0050
	Platinum	26 632 360-08 0050
	Durabron (23kt Gold)	26 632 360-09 0050
	Brushed Dark Brass	26 632 360-39 0050
	Brushed Dark Platinum	26 632 360-99 0050

MADISON Showerpipe with shower mixer without hand shower - Brushed Durabrass (23kt Gold)

MADISON

26 632 360 Product version from 7/1/2022
mm [inches]

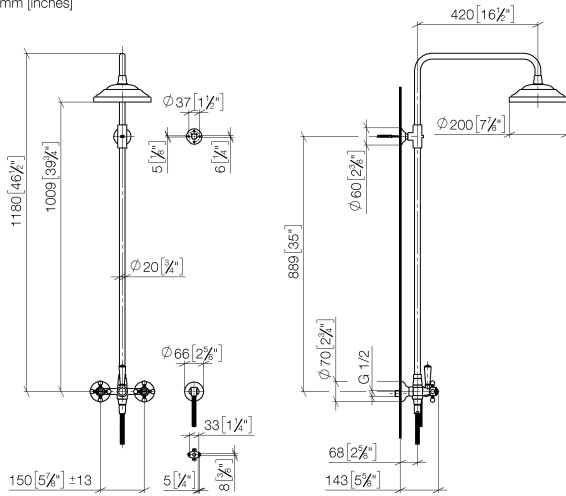

Flow rate chart

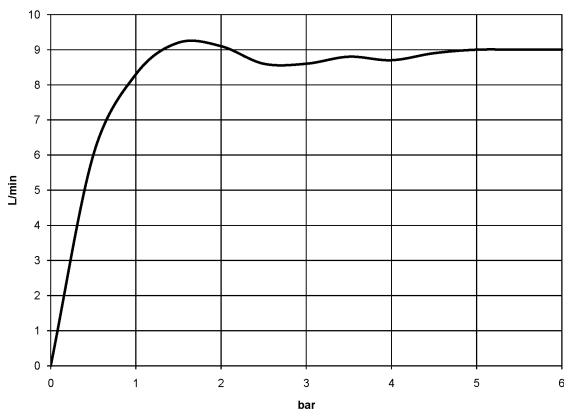

MADISON Showerpipe with shower mixer without hand shower - Brushed Durabrand (23kt Gold)

MADISON

26 632 360 Product version from 7/1/2022

Parts for other
finishes can be found
here: [Chrome](#)

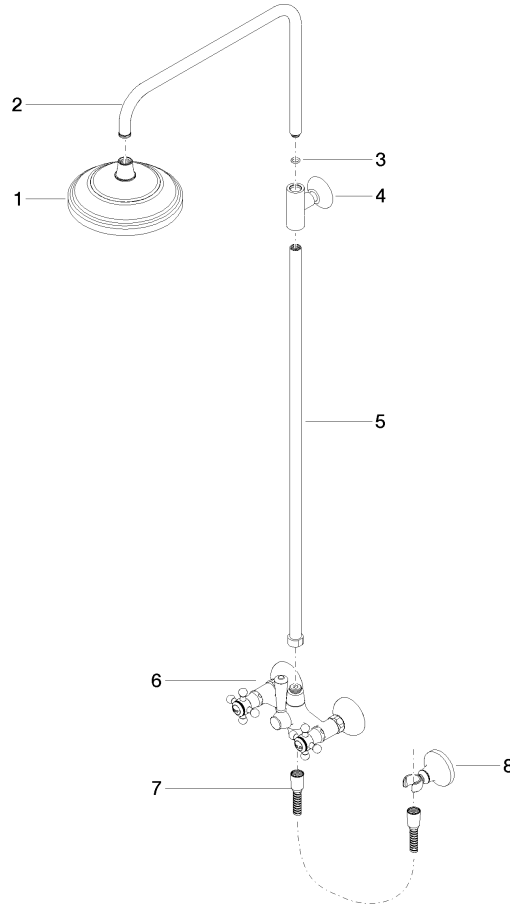

Spare parts list

No.	Item Number	Name	Quantity used	Delivery time
2	04 28 22 101 20-28	spout	1.00	20
6	04 17 10 001 00-28	fitting	1.00	20
4	90 17 11 033 00-28	holder	1.00	-
Spare part can no longer be ordered, please order the replacement item				
7	28 104 970-28	Metal shower hose 1/2" x 1/2" x 1250 mm - Brushed Durabrand (23kt Gold)	1.00	10
8	28 050 410-28	holder	1.00	60
5	90 28 22 096 00-28	pipe	1.00	20
3	90 14 10 011 00 90	seal	1.00	2
1	90 12 05 038 20-28	shower	1.00	20