

## Hand shower - Brushed Dark Brass

SERIES-VARIOUS

28 012 979 Product version from 7/1/2022



- spray head Ø 120mm
- Four settings: COMPACT RAIN, COMPACT SOFT FLOW, COMPACT AQUAPRESSURE FLOW, COMPACT CASCADE, max. flow rate 6.8 l/min (at 3 bar)
- with anti-scale system
- 1/2" connection

### Notes:

- This product can help a building meet the requirements of Green Building Rating Systems, e.g. LEED®, BREEAM®, DGNB

Intrinsic protection against back flow.

|   |                               |                    |
|---|-------------------------------|--------------------|
|    | Brushed Dark Brass            | 28 012 979-39 0050 |
|    | Chrome                        | 28 012 979-00 0050 |
|    | Brushed Platinum              | 28 012 979-06 0050 |
|    | Platinum                      | 28 012 979-08 0050 |
|    | Dark Chrome                   | 28 012 979-19 0050 |
|    | Light Gold                    | 28 012 979-26 0050 |
|    | Brushed Light Gold            | 28 012 979-27 0050 |
|    | Brushed Durabrass (23kt Gold) | 28 012 979-28 0050 |
|    | Matte Black                   | 28 012 979-33 0050 |
|   | Brushed Bronze                | 28 012 979-42 0050 |
|  | Brushed Champagne (22kt Gold) | 28 012 979-46 0050 |
|  | Champagne (22kt Gold)         | 28 012 979-47 0050 |
|  | Brushed Chrome                | 28 012 979-93 0050 |
|  | Brushed Dark Platinum         | 28 012 979-99 0050 |

mm [inches]

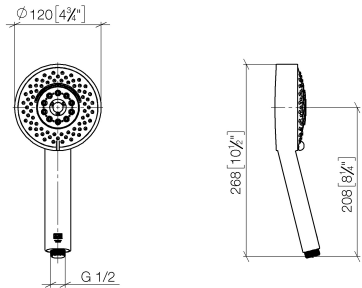

### Flow rate chart



Parts for other  
finishes can be found  
here: [Chrome](#)

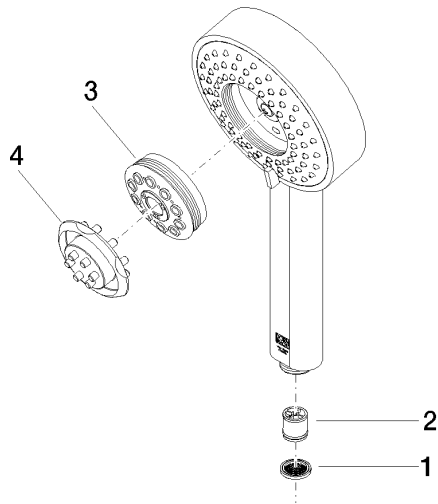

Spare parts list

| No. | Item Number          | Name         | Quantity used | Delivery time |
|-----|----------------------|--------------|---------------|---------------|
|     | 2 09 23 01 166 90    | flow reducer | 1.00          | 2             |
|     | 3 04 12 11 071 00 90 | shower       | 1.00          | 2             |
|     | 1 09 23 01 039 90    | sieve        | 1.00          | 2             |
|     | 4 09 30 09 022 90    | key          | 1.00          | 2             |