

MADISON Rain shower with wall fixing 200 mm - Brushed Durabrand (23kt Gold)

MADISON

28 545 977 Product version from 7/1/2022



- rain shower Ø 200 mm
- Rain shower: PURE RAIN, max. flow rate 14 l/min (at 3 bar)
- with anti-scale system

Technical data:

- 435mm projection
- rosette Ø 55 mm
- 1/2" connection

Notes:

- This product can help a building meet the requirements of Green Building Rating Systems, e.g. LEED®, BREEAM®, DGNB

	Brushed Durabrand (23kt Gold)	28 545 977-28 0050
	Chrome	28 545 977-00 0050
	Brushed Platinum	28 545 977-06 0050
	Platinum	28 545 977-08 0050
	Durabrand (23kt Gold)	28 545 977-09 0050
	Brushed Dark Platinum	28 545 977-99 0050

Recommended miscellaneous



- Concealed wall elbow -** 35 085 970 90
- max. recess depth 163 mm
 - min. recess depth 90 mm

MADISON Rain shower with wall fixing 200 mm - Brushed Durabron (23kt Gold)

MADISON

28 545 977 Product version from 7/1/2022
mm [inches]

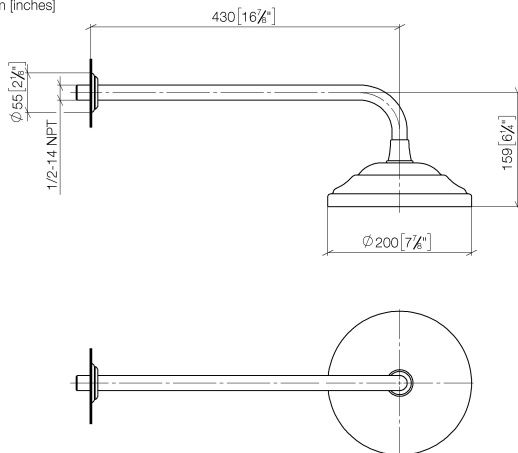

Flow rate chart



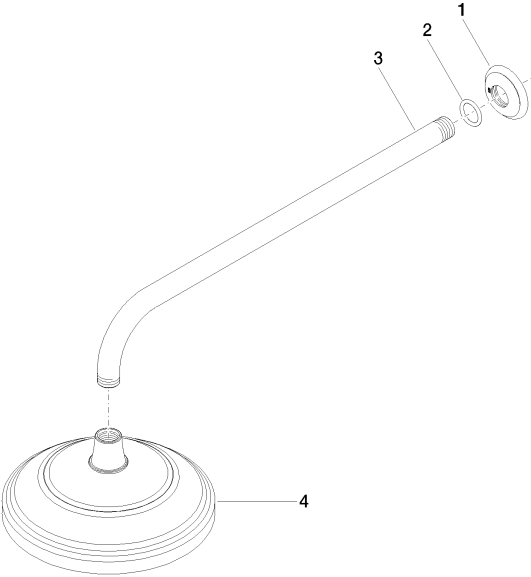

Spare parts list

No.	Item Number	Name	Quantity used	Delivery time
1	09 27 35 003-28	rosette	1.00	60
3	09 11 03 017-28	connection	1.00	60
4	90 12 05 038 20-28	shower	1.00	20
2	90 14 10 026 00 90	seal	1.00	2