

Rain shower with ceiling fixing 300 x 240 mm - Dark Chrome

MEM

28 775 980



Fits: MEM, CL.1

- rain shower 300 x 240mm
- PURE RAIN, max. flow rate 6.8 l/min (at 3 bar)
- distance between ceiling and lower edge of the shower 165mm
- rosette 60 x 60, as required
- 1/2" connection
- with anti-scale system
- quick clearing
- This product can help a building meet the requirements of Green Building Rating Systems, e.g. LEED®, BREEAM®, DGNB

| | | |
|---|--------------------------------|--------------------|
|  | Dark Chrome | 28 775 980-19 0050 |
|  | | 28 775 980-27 0050 |
|  | Chrome | 28 775 980-00 0050 |
|  | Brushed Platinum | 28 775 980-06 0050 |
|  | Platinum | 28 775 980-08 0050 |
|  | Brushed Light Gold | 28 775 980-27 |
|  | Brushed Durabronze (23kt Gold) | 28 775 980-28 0050 |
|  | Matte Black | 28 775 980-33 0050 |
|  | Brushed Champagne (22kt Gold) | 28 775 980-46 0050 |
|  | Champagne (22kt Gold) | 28 775 980-47 0050 |
|  | Brushed Chrome | 28 775 980-93 0050 |
|  | Brushed Dark Platinum | 28 775 980-99 0050 |

Recommended miscellaneous



- Concealed wall elbow -** 35 085 970 90
- max. recess depth 163 mm
 - min. recess depth 90 mm

28 775 980

mm [inches]

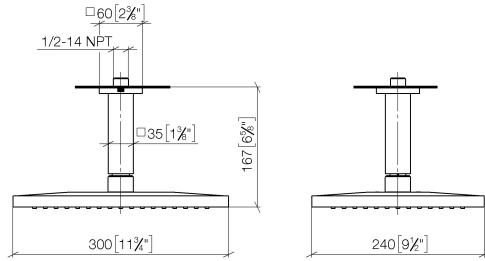

Flow rate chart



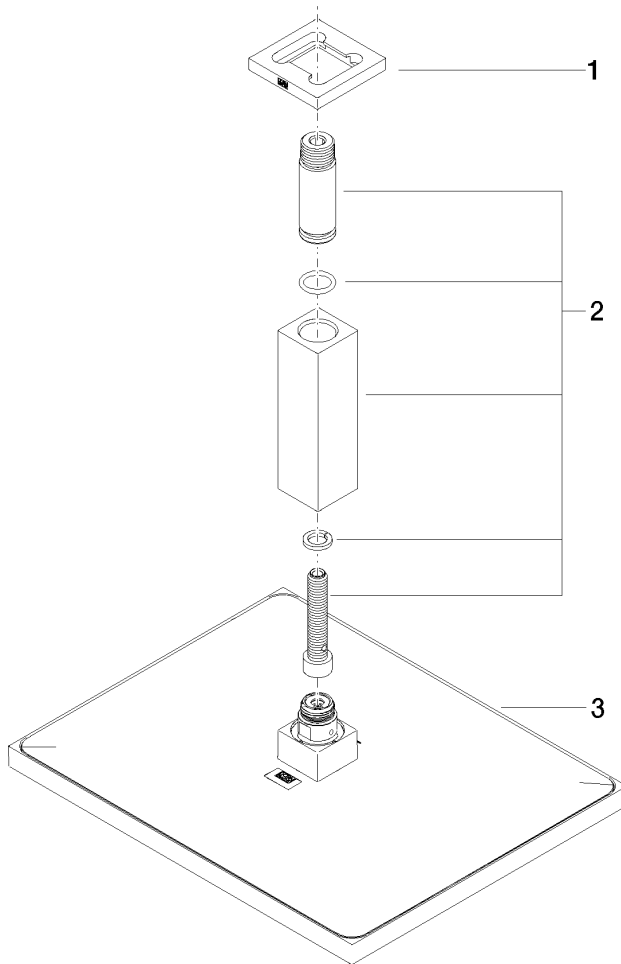



Rain shower with ceiling fixing 300 x 240 mm - Dark Chrome

MEM

28 775 980

Spare parts list