

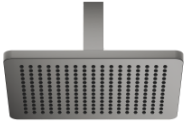





28 796 710

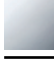

- rain shower 300 x 240mm
- PURE RAIN, max. flow rate 20 l/min (at 3 bar)
- Function from: 12 l/min
- distance between ceiling and lower edge of the shower 165mm
- rosette 78 x 55, as required
- 1/2" connection
- with anti-scale system
- quick clearing
- WRAS 2212012

Product change as of 1st April 2024: max. flow 20l/min

	Brushed Dark Platinum	28 796 710-99
	Chrome	28 796 710-00 0050
	Brushed Platinum	28 796 710-06 0050
	Platinum	28 796 710-08
	Brushed Durabronze (23kt Gold)	28 796 710-28

28 796 710

mm [inches]

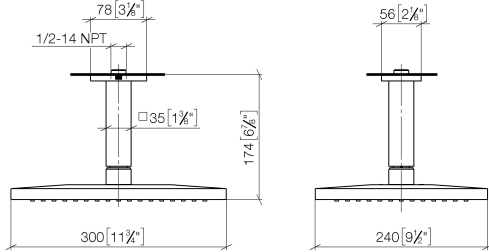

Flow rate chart

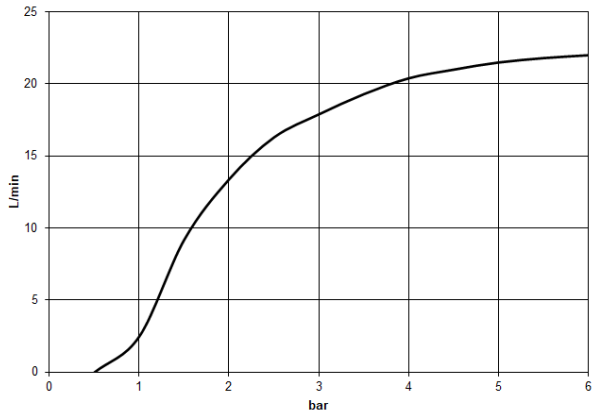

Certificates

LGA_29232. IAPMO_4976 (2). WRAS_2212012. LGA_38662.

28 796 710

Parts for other finishes can be found here: [Chrome](#)

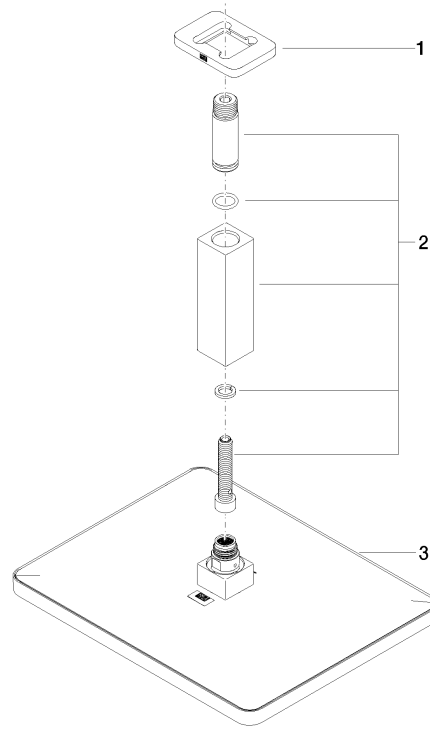

Spare parts list

No.	Item Number	Name	Quantity used	Delivery time
1	09 27 71 020-99	rosette	1	30
2	90 11 10 092 00-99	connection	1	30
3	04 12 05 062 00-99	shower	1	30