

TARA ULTRA Single-lever mixer - Chrome

TARA ULTRA

33 800 875 Product version from 5/31/2010 to 7/25/2018



- 201mm projection
- pivotable spout 360°
- air-enriched flow
- height of mixer 373 mm
- height up to aerator 240 mm
- hole diameter 35 mm
- max. flow 8 l/min at 3 bar flow pressure
- lead-free
- This product can help a building meet the requirements of Green Building Rating Systems, e.g. LEED®, BREEAM®, DGNB
- WRAS

	Chrome	33 800 875-00
	Brushed Platinum	33 800 875-06
	Platinum	33 800 875-08
	Durabronze (23kt Gold)	33 800 875-09
	Dark Chrome	33 800 875-19
	Brushed Durabronze (23kt Gold)	33 800 875-28
	Matte Black	33 800 875-33
	Brushed Bronze	33 800 875-42
	Brushed Champagne (22kt Gold)	33 800 875-46
	Champagne (22kt Gold)	33 800 875-47
	Brushed Chrome	33 800 875-93
	Brushed Dark Platinum	33 800 875-99

Recommended miscellaneous

Dispenser without rosette - Chrome

82 424 970-00



Recommended miscellaneous

Strainer waste with control handle - Chrome

10 712 970-00



Bar	Lumin
0.0	0.0
0.5	4.5
1.0	7.5
1.5	7.8
2.0	8.0
3.0	8.0
4.0	8.0
5.0	8.1
6.0	8.2

DIN 4109	EN 817	Executive Order no. 1007	ISO 3822
Scottish Water Byelaws	UK Water Supply Regulations	Ü-Zeichen	VA-Zeichen



TARA ULTRA Single-lever mixer - Chrome

TARA ULTRA

33 800 875 Product version from 5/31/2010 to 7/25/2018

Certificates and sustainability

GDV_0400	LGA_18	WRAS_2101	ETA_18
----------	--------	-----------	--------

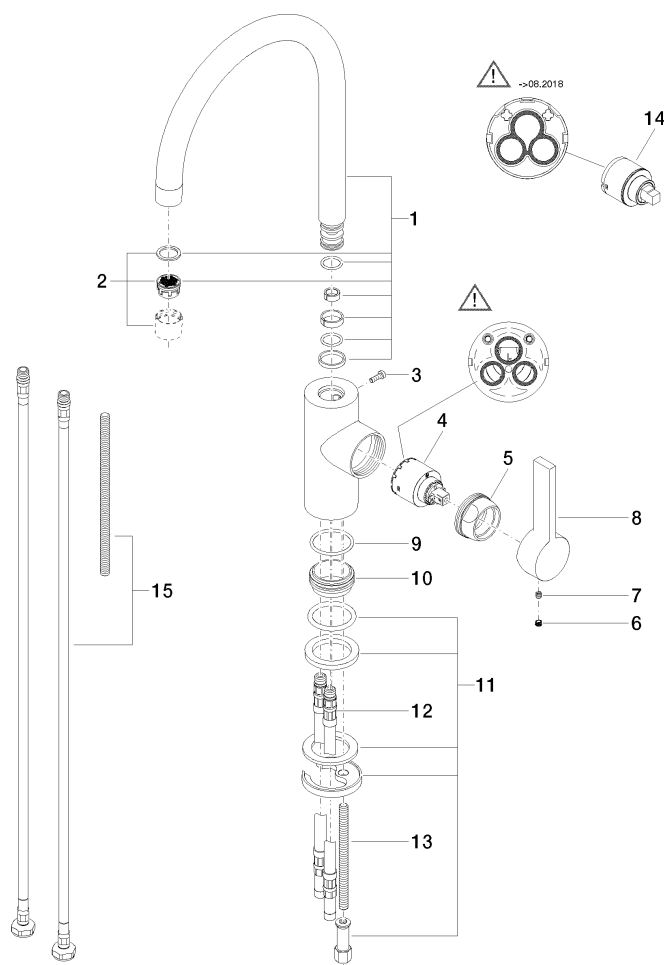

Spare parts list

No.	Item Number	Name	Quantity used	Delivery time
9	09 14 10 119 90	seal	1.00	2
11	04 30 11 085 88 90	fixing set	1.00	2
5	09 24 04 107-00	nut	1.00	10
3	09 30 30 080 90	screw	1.00	2
2	90 23 01 004 07-00	aerator	1.00	10
13	09 31 11 012 90	pin	1.00	2
4	90 15 05 061 00 90	cartridge	1.00	60
12	04 30 04 016 00 90	hose	2.00	60
15	12 803 970 90	extension	1.00	60
1	90 28 22 204 02-00	spout	1.00	10
8	09 20 79 040-00	handle	1.00	10
10	09 28 10 109-07	ring	1.00	30
6	90 31 20 109 00 90	plug	1.00	2
7	90 31 11 030 00 90	pin	1.00	2
14	90 15 05 045 00 90	cartridge	1.00	2