

## Showerpipe with shower thermostat without hand shower - Matte Black

SERIES SPECIFIC

34 459 980 Product version from 7/1/2022



- shower with fixed riser projection 453mm
- overhead shower: rain flow
- rain shower 300 x 240mm
- rain shower with anti-scale system
- max. rainshower flow 14 l/min
- rotary diverter with volume control and shut-off function
- slide-on rosettes Ø 70 mm
- height of fittings up to rain shower (bottom edge) 1009mm
- height of fittings up to top edge of elbow 1150mm
- gauge 150 mm - 13 mm
- metal shower hose 1750mm with integrated anti-twist protection
- 1/2" connection
- slide bar
- Pipe diameter 23.5 mm
- quick clearing
- This product can help a building meet the requirements of Green Building Rating Systems, e.g. LEED®, BREEAM®, DGNB

Intrinsic protection against back flow.

|   |                                |                    |
|---|--------------------------------|--------------------|
|    | Matte Black                    | 34 459 980-33 0050 |
|    | Chrome                         | 34 459 980-00 0050 |
|    | Brushed Platinum               | 34 459 980-06 0050 |
|    | Platinum                       | 34 459 980-08 0050 |
|    | Dark Chrome                    | 34 459 980-19 0050 |
|    | Brushed Light Gold             | 34 459 980-27 0050 |
|    | Brushed Durabronze (23kt Gold) | 34 459 980-28 0050 |
|    | Brushed Dark Brass             | 34 459 980-39 0050 |
|    | Brushed Champagne (22kt Gold)  | 34 459 980-46 0050 |
|   | Champagne (22kt Gold)          | 34 459 980-47 0050 |
|  | Brushed Chrome                 | 34 459 980-93 0050 |
|  | Brushed Dark Platinum          | 34 459 980-99 0050 |

34 459 980 Product version from 7/1/2022

mm [inches]  
1:10

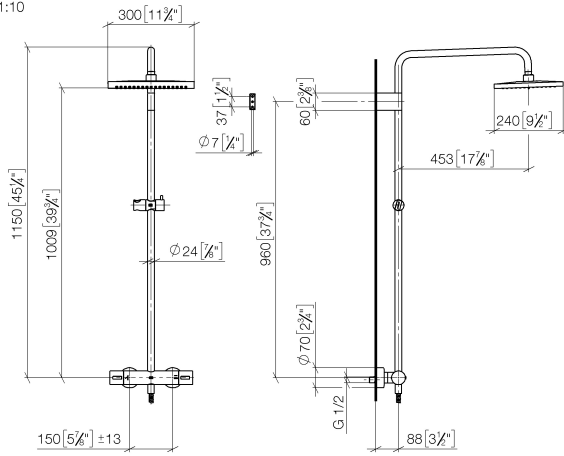

## Flow rate chart

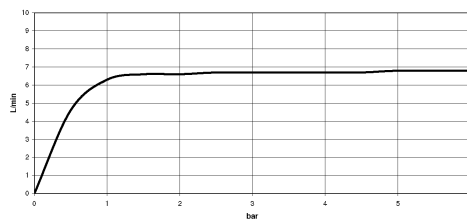

## Showerpipe with shower thermostat without hand shower - Matte Black

SERIES SPECIFIC

34 459 980 Product version from 7/1/2022

Parts for other  
finishes can be found  
here: [Chrome](#)

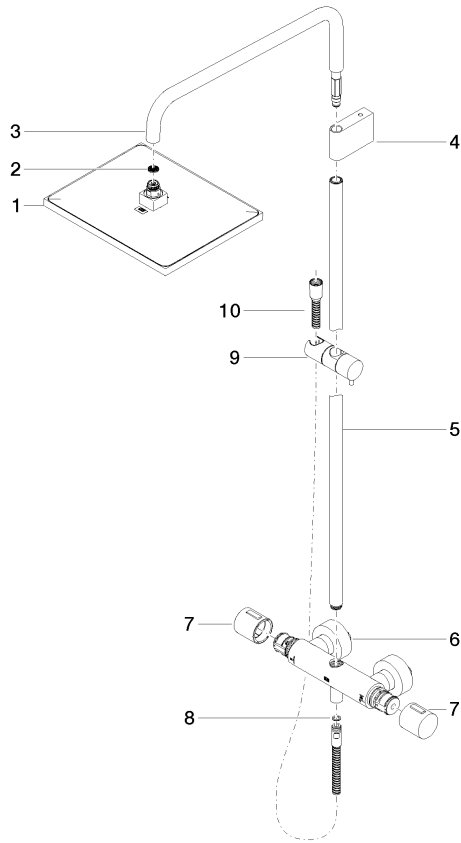

### Spare parts list

| No. | Item Number        | Name  | Quantity used | Delivery time |
|-----|--------------------|---|---------------|---------------|
| 6   | 04 17 01 250 00-33 | connection  | 1.00          | 30            |
| 9   | 12 570 970-33      | Slide unit - Matte Black                              | 1.00          | 70            |
| 5   | 90 28 22 349 00-33 | pipe  | 1.00          | 30            |
| 4   | 90 17 11 150 00-33 | holder  | 1.00          | 30            |
| 3   | 90 28 22 348 00-33 | pipe  | 1.00          | 30            |
| 2   | 09 23 01 039 90    | sieve   | 1.00          | 2             |
| 7   | 90 17 33 015 00-33 | handle  | 1.00          | 30            |
| 10  | 28 322 970-33      | Metal shower hose 1/2" x 3/8" x 1750 mm - Matte Black | 1.00          | 2             |
| 1   | 04 12 05 063 10-33 | shower  | 1.00          | 30            |
| 8   | 90 14 20 026 00 90 | seal  | 1.00          | 2             |