













Concealed single-lever mixer with integrated shower connection - Brushed Bronze

SERIES-VARIOUS

36 050 970	Product version from 10/1/2023		
	<ul style="list-style-type: none"> • without rosette • WRAS Intrinsic protection against back flow. Intrinsic protection against back flow.	 Brushed Bronze 36 050 970-42	
		 Chrome 36 050 970-00	
		 Brushed Platinum 36 050 970-06	
		 Platinum 36 050 970-08	
		Dark Brass matt 36 050 970-16	
		 Dark Chrome 36 050 970-19	
		 Light Gold 36 050 970-26	
		 Brushed Light Gold 36 050 970-27	
		 Brushed Durabrass (23kt Gold) 36 050 970-28	
		 Matte Black 36 050 970-33	
		 Brushed Champagne (22kt Gold) 36 050 970-46	
		 Champagne (22kt Gold) 36 050 970-47	
		 Brushed Chrome 36 050 970-93	
		 Brushed Dark Platinum 36 050 970-99	

Required miscellaneous

	Concealed wall mounting - •min. recess depth 80 mm •max. recess depth 105 mm	35 050 970 90
--	---	---------------

Concealed single-lever mixer with integrated shower connection - Brushed Bronze

SERIES-VARIOUS

36 050 970 Product version from 10/1/2023
mm [inches]

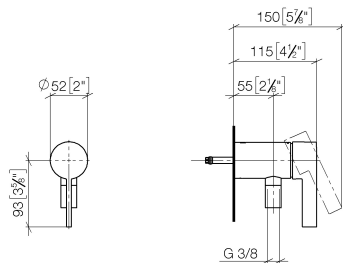

Flow rate chart

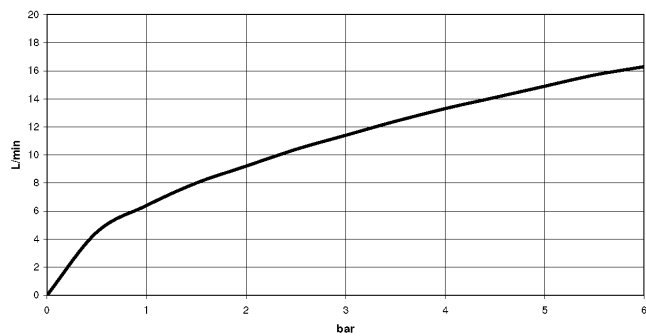

Concealed single-lever mixer with integrated shower connection - Brushed Bronze

SERIES-VARIOUS

36 050 970 Product version from 10/1/2023

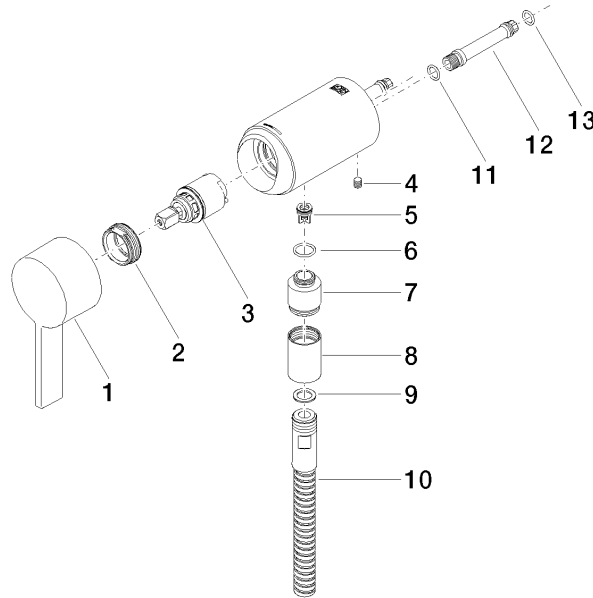

Spare parts list

No.	Item Number	Name	Quantity used	Delivery time
13	09 14 10 061 90	seal	1.00	2
12	09 18 40 230 90	connection	1.00	2
8	90 21 02 069 00-42	cover	1.00	30
11	90 14 10 060 00 90	seal	1.00	2
10	28 322 970-42	Metal shower hose 1/2" x 3/8" x 1750 mm - Brushed Bronze	1.00	30
2	09 24 04 266 90	nut	1.00	2
7	09 24 03 281-42	nipple	1.00	60
5	09 23 01 131 90	back-flow preventer	1.00	2
9	90 14 20 026 00 90	seal	1.00	2
1	90 20 97 064 00-42	handle	1.00	30
4	09 31 11 004 90	pin	1.00	60
3	90 15 05 044 04 90	cartridge	1.00	2
6	09 14 10 213 90	seal	1.00	2