

## VAIA Concealed thermostat with one function volume control - Brushed Dark Brass

VAIA

36 425 809 Product version from 4/1/2025



- cover plate Ø 150 mm
- temperature control handle with safety limit stop at 38°C
- hot water temperature limiter, can be preset
- WRAS

|   |                                |               |
|---|--------------------------------|---------------|
|    | Brushed Dark Brass             | 36 425 809-39 |
|    | Chrome                         | 36 425 809-00 |
|    | Brushed Platinum               | 36 425 809-06 |
|    | Platinum                       | 36 425 809-08 |
|    | Dark Chrome                    | 36 425 809-19 |
|    | Brushed Durabronze (23kt Gold) | 36 425 809-28 |
|    | Brushed Bronze                 | 36 425 809-42 |
|    | Brushed Champagne (22kt Gold)  | 36 425 809-46 |
|    | Champagne (22kt Gold)          | 36 425 809-47 |
|  | Brushed Dark Platinum          | 36 425 809-99 |

## VAIA Concealed thermostat with one function volume control - Brushed Dark Brass

VAIA

36 425 809 Product version from 4/1/2025  
mm [inches]

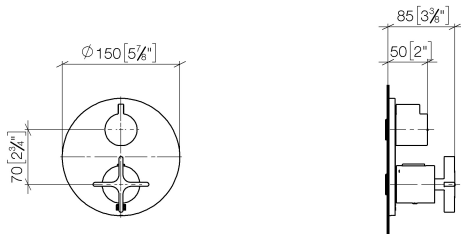

### Flow rate chart



### Codes & Standards

DIN 4109

EN 1111

ISO 3822

Scottish Water  
Byelaws

UK Water Supply  
Regulations

Ü-Zeichen

VA-Zeichen



VAIA Concealed thermostat with one function volume control - Brushed Dark Brass

VAIA

36 425 809 Product version from 4/1/2025

Certificates and sustainability

|        |        |        |             |
|--------|--------|--------|-------------|
| LGA_19 | ETA_20 | LGA_19 | WRAS_250402 |
|--------|--------|--------|-------------|

## VAIA Concealed thermostat with one function volume control - Brushed Dark Brass

VAIA

36 425 809 Product version from 4/1/2025

Parts for other  
finishes can be found  
here: [Chrome](#)

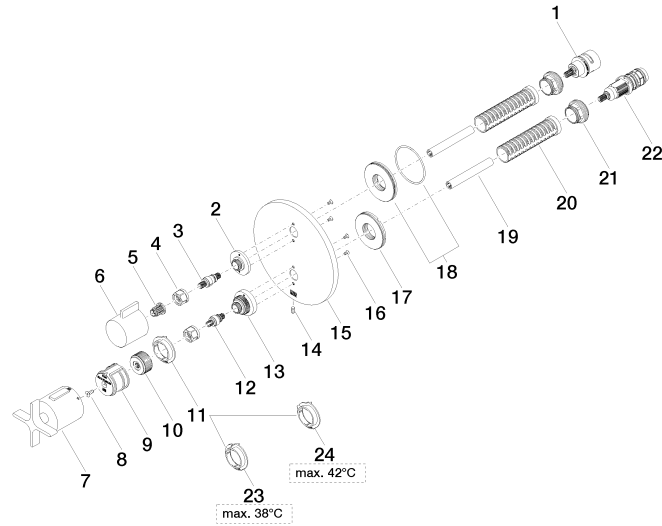



## VAIA Concealed thermostat with one function volume control - Brushed Dark Brass

VAIA

36 425 809 Product version from 4/1/2025

### Spare parts list

| No.  | Item Number        | Name       | Quantity used | Delivery time |
|--|--------------------|------------|---------------|---------------|
| 9  | 90 12 12 052 00 90 | base       | 1.00          | 2             |
| 16   | 09 30 30 157 90    | screw      | 4.00          | 2             |
| 1  | 90 90 03 166 00 90 | top        | 1.00          | 2             |
| 5  | 90 12 12 002 00 90 | fixing cap | 1.00          | 2             |
| 2  | 09 12 12 053-39    | base       | 1.00          | 60            |
| 22   | 90 15 02 013 00 90 | cartridge  | 1.00          | 2             |
| 4  | 90 23 30 023 00 90 | nut        | 2.00          | 2             |
| 18   | 90 30 01 190 00 90 | disc       | 1.00          | 2             |
| 23   | 09 28 10 188 90    | regulator  | 1.00          | 2             |
| 6  | 09 20 67 006-39    | handle     | 1.00          | 60            |
| 3  | 04 29 06 111 01-39 | spindle    | 1.00          | -             |
| Spare part can no longer be ordered, please order the replacement item |                    |            |               |               |
| 24   | 09 28 10 189 90    | regulator  | 1.00          | 2             |
| 21   | 09 24 04 257 90    | nut        | 2.00          | 2             |
| 13   | 09 12 12 051-39    | base       | 1.00          | 60            |
| 7  | 90 17 33 032 00-39 | handle     | 1.00          | 30            |
| 20   | 90 18 40 077 01 90 | spindle    | 2.00          | 2             |
| 15   | 09 11 02 242-39    | plate      | 1.00          | 60            |
| 11   | 09 28 10 187 90    | regulator  | 1.00          | 2             |
| 17   | 09 30 01 296 90    | disc       | 1.00          | 2             |
| 19   | 90 23 01 124 00 90 | sleeve     | 2.00          | 2             |
| 8  | 90 30 30 124 00 90 | screw      | 1.00          | 2             |
| 12   | 04 29 06 024 01-39 | spindle    | 1.00          | -             |
| Spare part can no longer be ordered, please order the replacement item |                    |            |               |               |
| 14   | 09 31 11 134 90    | pin        | 1.00          | 2             |
| 10   | 09 12 12 054 90    | base       | 1.00          | 2             |