



CYO Wall valve clockwise closing 1/2" - Durabronss / Brushed Durabronss (23kt Gold)







CYO

36 607 811



- without rosette
- handle Ø 60mm
- head part with cut-to-length spindle and sleeve

NOTE: The handle inserts must be ordered separately from the fittings!

	Durabronss / Brushed Durabronss (23kt Gold)	36 607 811-38
	Chrome	36 607 811-00
	Brushed Platinum	36 607 811-06
	Dark Chrome	36 607 811-19
	Brushed Durabronss (23kt Gold)	36 607 811-28
	Platinum / Brushed Platinum	36 607 811-36
	Brushed Dark Platinum	36 607 811-99



CYO Wall valve clockwise closing 1/2" - Durabronn / Brushed Durabronn (23kt Gold)

CYO

36 607 811
mm [inches]

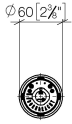

Codes & Standards

DIN 4109

ISO 3822

Ü-Zeichen

Certificates

LGA_38



CYO Wall valve clockwise closing 1/2" - Durabronn / Brushed Durabronn (23kt Gold)

CYO

36 607 811

Parts for other finishes can be found here: Chrome

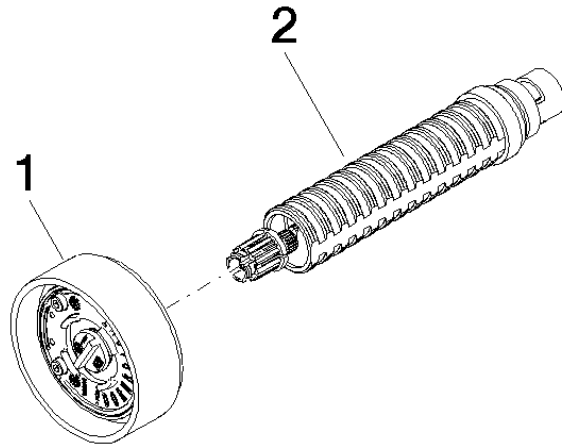



CYO Wall valve clockwise closing 1/2" - Durabronss / Brushed Durabronss (23kt Gold)

CYO

36 607 811

Spare parts list

No.	Item Number	Name	Quantity used	Delivery time
	90 18 40 291 01-38	handle	2	20