

TARA Wall valve clockwise closing 1/2" - Chrome

TARA

36 607 892

Product version up to 10/27/2020

- rosette Ø 55 mm
- head part with cut-to-length spindle and sleeve
- WRAS



| | | |
|---|-------------------------------|---------------|
|  | Chrome | 36 607 892-00 |
|  | Brushed Platinum | 36 607 892-06 |
|  | Platinum | 36 607 892-08 |
|  | Dark Chrome | 36 607 892-19 |
|  | Brushed Durabrass (23kt Gold) | 36 607 892-28 |
|  | Matte Black | 36 607 892-33 |
|  | Brushed Bronze | 36 607 892-42 |
|  | Brushed Champagne (22kt Gold) | 36 607 892-46 |
|  | Champagne (22kt Gold) | 36 607 892-47 |
|  | Brushed Chrome | 36 607 892-93 |
|  | Brushed Dark Platinum | 36 607 892-99 |

Required miscellaneous

| | | |
|---|---|---------------|
|  | Wall valve 1/2" - | 35 607 970 90 |
| | <ul style="list-style-type: none"> •max. recess depth 145 mm •min. recess depth 85 mm | |

TARA Wall valve clockwise closing 1/2" - Chrome

TARA

36 607 892 Product version up to 10/27/2020

mm [inches]

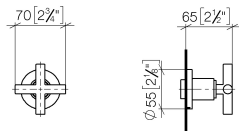

Codes & Standards

| | | | |
|----------------|----------|------------------------|-----------------------------|
| ASME A112.18.1 | cUPC | DIN 4109 | EN 1111 |
| EN 200 | ISO 3822 | Scottish Water Byelaws | UK Water Supply Regulations |

Ü-Zeichen

Certificates and sustainability

| | | | | |
|-----------------|--------------|--------|-----------|-----------------|
| DVGW_DW-6501DN0 | WRAS_2011 | LGA_29 | WRAS_2010 | DVGW_DW-6512DN0 |
| LGA_29 | IAPMO_4976 (| | | |



Spare parts list

| No. | Item Number | Name | Quantity used | Delivery time |
|-----|-----------------------|------------|---------------|---------------|
| | 11 09 21 02 144-00 | sleeve | 1.00 | 10 |
| | 1 90 90 03 143 00 90 | top | 1.00 | 2 |
| | 10 90 12 12 002 00 90 | fixing cap | 1.00 | 2 |
| | 16 09 20 89 010-00 | handle | 1.00 | 60 |
| | 8 09 29 06 022 90 | spindle | 1.00 | 2 |
| | 7 09 24 05 002 90 | nipple | 1.00 | 2 |
| | 3 90 21 02 108 00 90 | disc | 1.00 | 2 |
| | 15 90 12 12 007 00-00 | base | 1.00 | 10 |
| | 4 09 27 89 108-00 | rosette | 1.00 | 10 |
| | 5 90 31 11 007 00 90 | pin | 1.00 | 2 |
| | 12 90 20 89 010 10-00 | handle | 1.00 | 10 |
| | 6 90 14 15 020 03 90 | ring | 1.00 | 2 |
| | 14 90 30 11 029 00 90 | disc | 1.00 | 2 |
| | 9 90 14 10 060 00 90 | seal | 1.00 | 2 |
| | 2 90 23 30 023 00 90 | nut | 1.00 | 2 |
| | 13 90 30 30 075 00 90 | screw | 1.00 | 2 |