





CL.1 Wall valve clockwise closing cold 1/2" - Brushed Dark Platinum

CL.1

36 627 706 Product version up to 10/14/2020



- with CASCADE structure
- rosette 60 x 60 mm
- with cold marking
- head part with cut-to-length spindle and sleeve
- WRAS

	Brushed Dark Platinum	36 627 706-99
	Chrome	36 627 706-00
	Brushed Platinum	36 627 706-06
	Dark Chrome	36 627 706-19
	Brushed Champagne (22kt Gold)	36 627 706-46
	Champagne (22kt Gold)	36 627 706-47

Required miscellaneous

Wall valve 1/2" -		35 607 970 90
	•max. recess depth 150 mm	
	•min. recess depth 105 mm	



CL.1 Wall valve clockwise closing cold 1/2" - Brushed Dark Platinum

CL.1

36 627 706 Product version up to 10/14/2020

mm [inches]



Codes & Standards

ASME A112.18.1	cUPC	DIN 4109	EN 200
ISO 3822	Scottish Water Byelaws	UK Water Supply Regulations	Ü-Zeichen

Certificates and sustainability

DVGW_DW-6501DN0	LGA_29	WRAS_2010	LGA_29	IAPMO_4976 (
-----------------	--------	-----------	--------	--------------

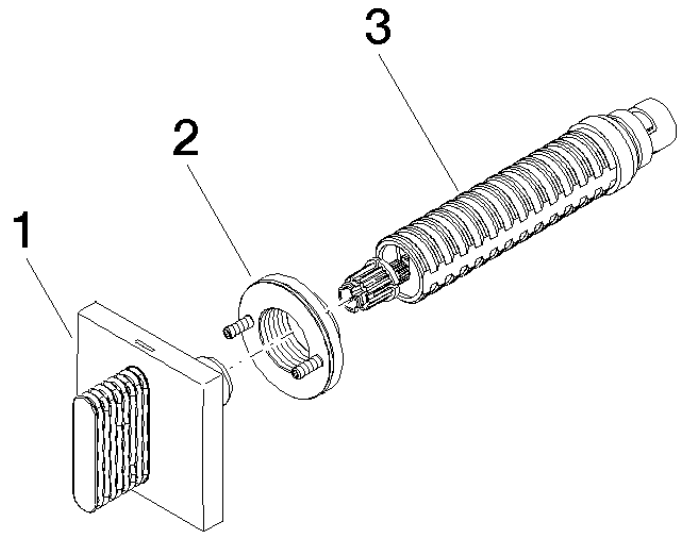

Spare parts list

No.	Item Number	Name	Quantity used	Delivery time
1	90 20 70 053 02-99	handle (cold)	1.00	20
3	90 90 03 143 00 90	top	1.00	2
2	90 21 02 108 00 90	disc	1.00	2