







CL.1 Wall-mounted basin spout without pop-up waste - Dark Chrome

CL.1

13 800 705    Product version from 3/9/2015

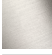

- 200mm projection
- fixed spout
- rectangular spray pattern with 40 individual jets
- hole diameter 37 mm
- lead-free
- 1/2" connection
- plug-link mounting
- max. flow 4.5 l/min
- This product can help a building meet the requirements of Green Building Rating Systems, e.g. LEED®, BREEAM®, DGNB
- WRAS

	Dark Chrome	13 800 705-19
	Chrome	13 800 705-00
	Brushed Platinum	13 800 705-06
	Brushed Champagne (22kt Gold)	13 800 705-46
	Champagne (22kt Gold)	13 800 705-47
	Brushed Dark Platinum	13 800 705-99

mm [inches]



**Flow rate chart**



**Codes & Standards**

ASME A112.18.1

cUPC

EPA WaterSense

NSF372

NSF61

WaterSense





CL.1 Wall-mounted basin spout without pop-up waste - Dark Chrome

CL.1

13 800 705 Product version from 3/9/2015

Certificates and sustainability

IAPMO_N-4	IAPMO_4976	IAPMO_8834	IAPMO_6
-----------	------------	------------	---------

13 800 705    Product version from 3/9/2015

Parts for other  
 finishes can be found  
 here: [Chrome](#)

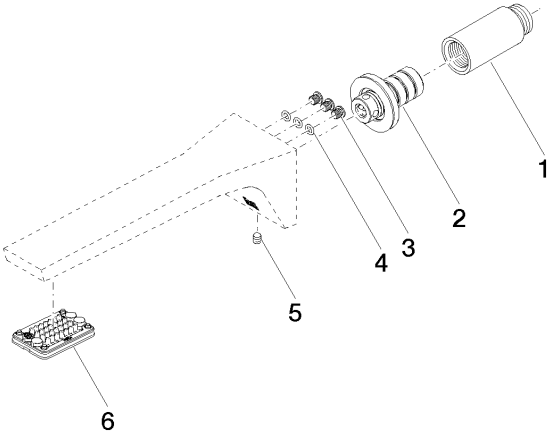

Spare parts list

No.	Item Number	Name	Quantity used	Delivery time
6	90 11 02 297 00 90	aerator	1.00	2
1	09 24 03 081 10 90	extension	1.00	2
2	90 24 03 108 01 90	nipple set	1.00	2
4	09 14 10 001 90	seal	3.00	2
5	90 31 11 004 00 90	pin	1.00	2
3	09 30 30 113 20 90	screw	3.00	2